

- INSTALL PATH & DRAINAGE STARTING AT UPPER PORTION OF SITE
RELOCATE OR REPLACE SILT BARRIER AFTER PATIO, PATHS & PLANTING ARE COMPLETE
2. BEACH RESTORATION SHALL COMMENCE AFTER "PHASE 2" SILT BARRIER IS IN PLACE AND DRAINAGE, PATIO AND PLANTING (UPHILL) ARE IN PLACE & STABILIZED
 3. SOIL MATERIALS GARNERED FROM GRADING WORK SHALL BE BLENDED WITH APPROPRIATE SOIL AUGMENTATION AND EXPEDITIOUSLY REUSED ON SITE PROVIDE EROSION PROTECTION FOR ANY STOCKPILED MATERIAL
 4. TEMPORARILY REMOVE PORTION OF EXISTING RETAINING WALL AT END OF DRIVEWAY PROVIDE PROTECTIVE BARRIER TO RETAIN RIPRAP TRACKING PAD FOR CONSTRUCTION ACCESS ALONG EDGE OF EXISTING STAIRS. PROTECT EXISTING TREES & RESTORE WALL & TRACKING AREA WHEN WORK IS COMPLETE

*Bush Honeysuckle
Japanese Barberry
Invasive vines*
Cut back invasives & carefully remove root system.
Replace soil & heal in new planting incrementally.

INDIGENOUS PLANTS
Blueberry
Sedges
Ferns

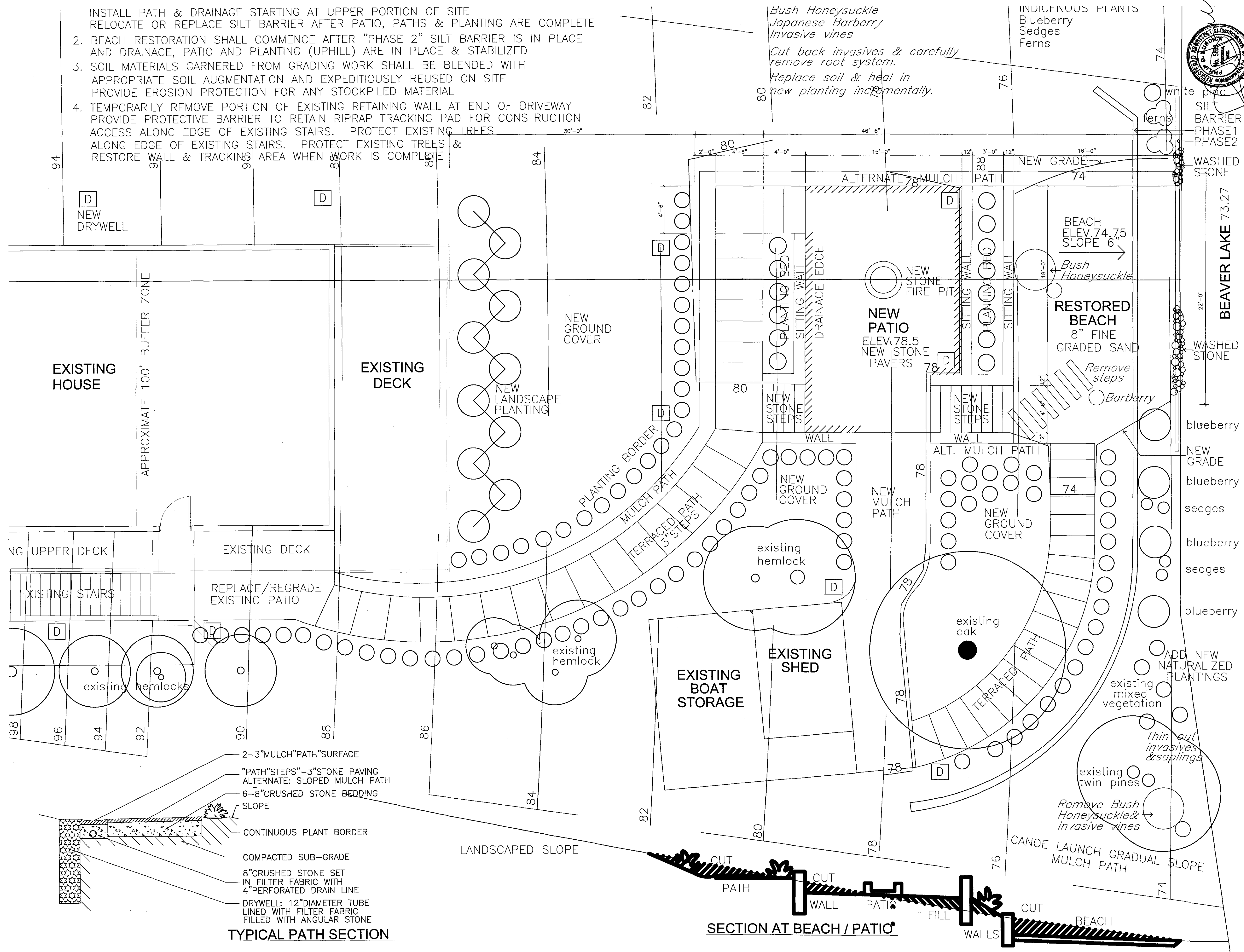

D
NEW DRYWELL

EXISTING HOUSE

EXISTING DECK

NEW PATIO
ELEV. 78.5
NEW STONE PAVERS

RESTORED BEACH
8" FINE GRADED SAND

EXISTING BOAT STORAGE

EXISTING SHED

FARKAS RESIDENCE
112 SHORELINE DRIVE
WARE, MA

BEACH & PATIO DESIGN
CONSTRUCTION
LANDSCAPE PLAN

PROJECT NO.
DRAWN BY PDB
SCALE 1" = 10'-0"
DATE 05/21/2021
REVISIONS 06/04/2021

LA1
SHEET

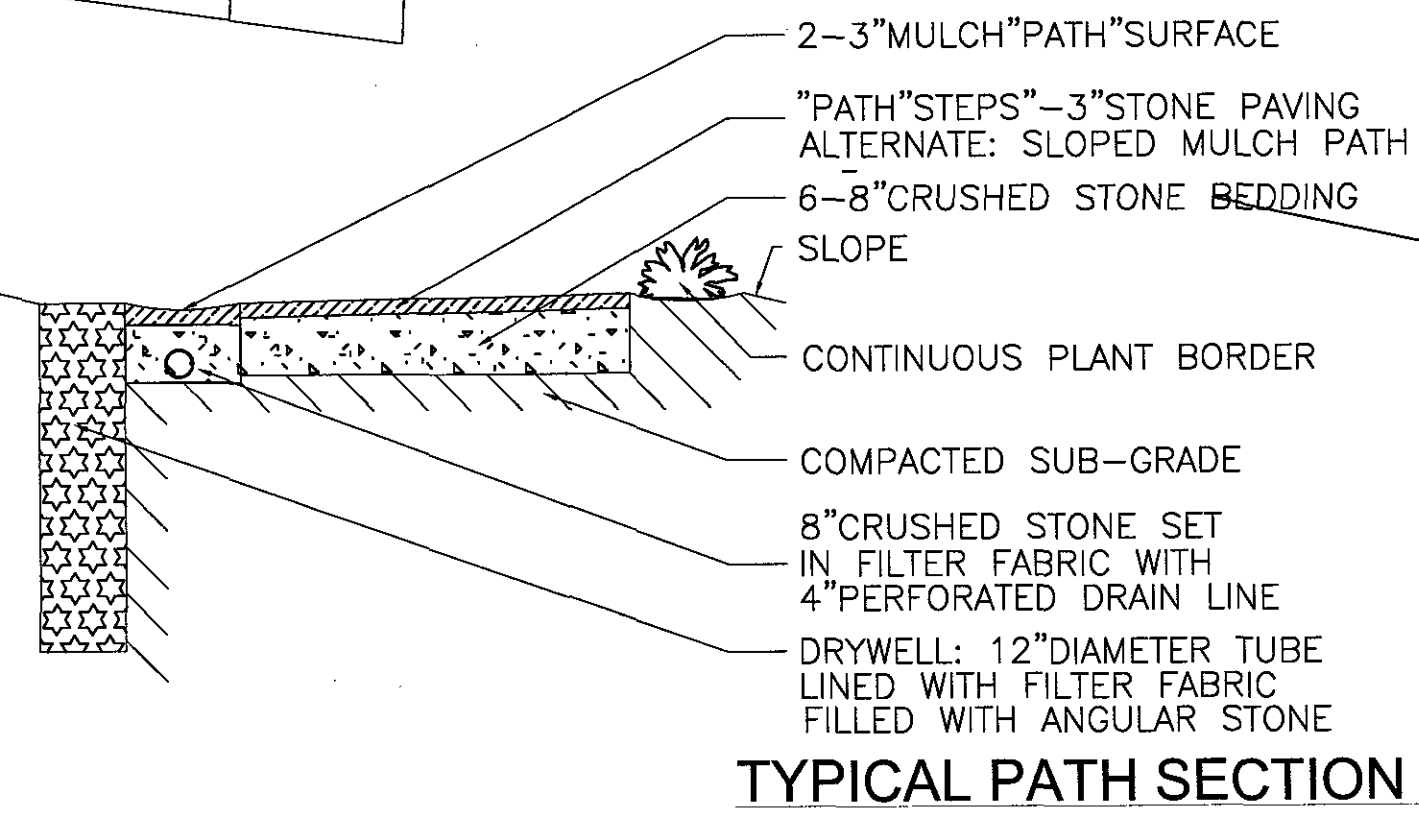

SECTION AT BEACH / PATIO

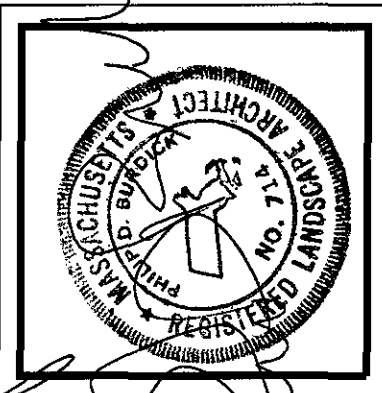

PHILIP D. BURDICK
ARCHITECTURE - LANDSCAPE ARCHITECTURE - PLANNING
5 Ridgewood Terrace - Springfield, MA 01105
philipburdick.architect@gmail.com 413-222-9533

FARKAS RESIDENCE
112 SHORELINE DRIVE
WARE, MA

**BEACH & PATIO DESIGN
CONSTRUCTION
LANDSCAPE PLAN**

PROJECT NO.
DRAWN BY PDB
SCALE 1" = 10'-0"
DATE 05/21/2021
REVISIONS 06/04/2021

LA1
SHEET