

BEAVER LAKE
ELEV. 73.27

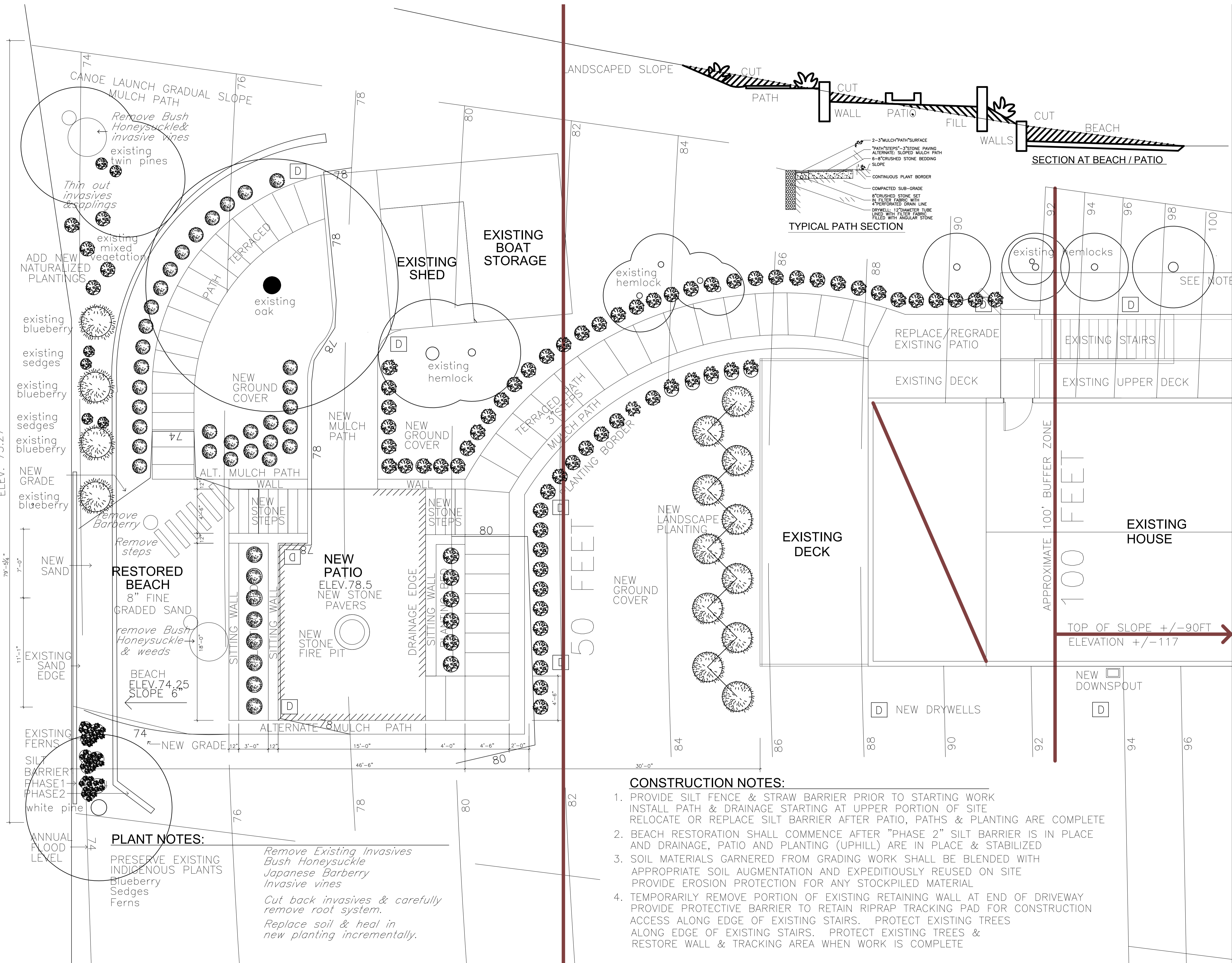

PLANT NOTES:

PRESERVE EXISTING INDIGENOUS PLANTS
Blueberry
Sedges
Ferns

*Remove Existing Invasives
Bush Honeysuckle
Japanese Barberry
Invasive vines*

*Cut back invasives & carefully remove root system.
Replace soil & heal in new planting incrementally.*

CONSTRUCTION NOTES:

1. PROVIDE SILT FENCE & STRAW BARRIER PRIOR TO STARTING WORK
INSTALL PATH & DRAINAGE STARTING AT UPPER PORTION OF SITE
RELOCATE OR REPLACE SILT BARRIER AFTER PATIO, PATHS & PLANTING ARE COMPLETE
2. BEACH RESTORATION SHALL COMMENCE AFTER "PHASE 2" SILT BARRIER IS IN PLACE AND DRAINAGE, PATIO AND PLANTING (UPHILL) ARE IN PLACE & STABILIZED
3. SOIL MATERIALS GARNERED FROM GRADING WORK SHALL BE BLENDED WITH APPROPRIATE SOIL AUGMENTATION AND EXPEDITIOUSLY REUSED ON SITE
PROVIDE EROSION PROTECTION FOR ANY STOCKPILED MATERIAL
4. TEMPORARILY REMOVE PORTION OF EXISTING RETAINING WALL AT END OF DRIVEWAY
PROVIDE PROTECTIVE BARRIER TO RETAIN RIPRAP TRACKING PAD FOR CONSTRUCTION
ACCESS ALONG EDGE OF EXISTING STAIRS. PROTECT EXISTING TREES
ALONG EDGE OF EXISTING STAIRS. PROTECT EXISTING TREES &
RESTORE WALL & TRACKING AREA WHEN WORK IS COMPLETE



PHILIP D. BURDICK
ARCHITECTURE - LANDSCAPE ARCHITECTURE - PLANNING
5 Ridgewood Terrace - Springfield, MA 01105
philipburdick.architect@gmail.com 413-222-9535

FARKAS RESIDENCE
112 SHORELINE DRIVE
WARE, MA

**BEACH & PATIO DESIGN
CONSTRUCTION
LANDSCAPE PLAN**

PROJECT NO.	
DRAWN BY	PDB
SCALE	1" = 10'-0"
DATE	05/21/2021
REVISIONS	06/04/2021 07/07/2021

LA1

SHEET