

PINE AVE. SIDEWALK & CROSSWALK DESIGN

CITY OF ANNA MARIA
10005 GULF DRIVE
ANNA MARIA, FL 34216

PHASE 1A - GULF DR. NORTH SHORE DR. NEW MEANDERING SIDEWALKS AND CROSSWALKS

SECTION 18, TOWNSHIP 34 SOUTH, RANGE 16 EAST

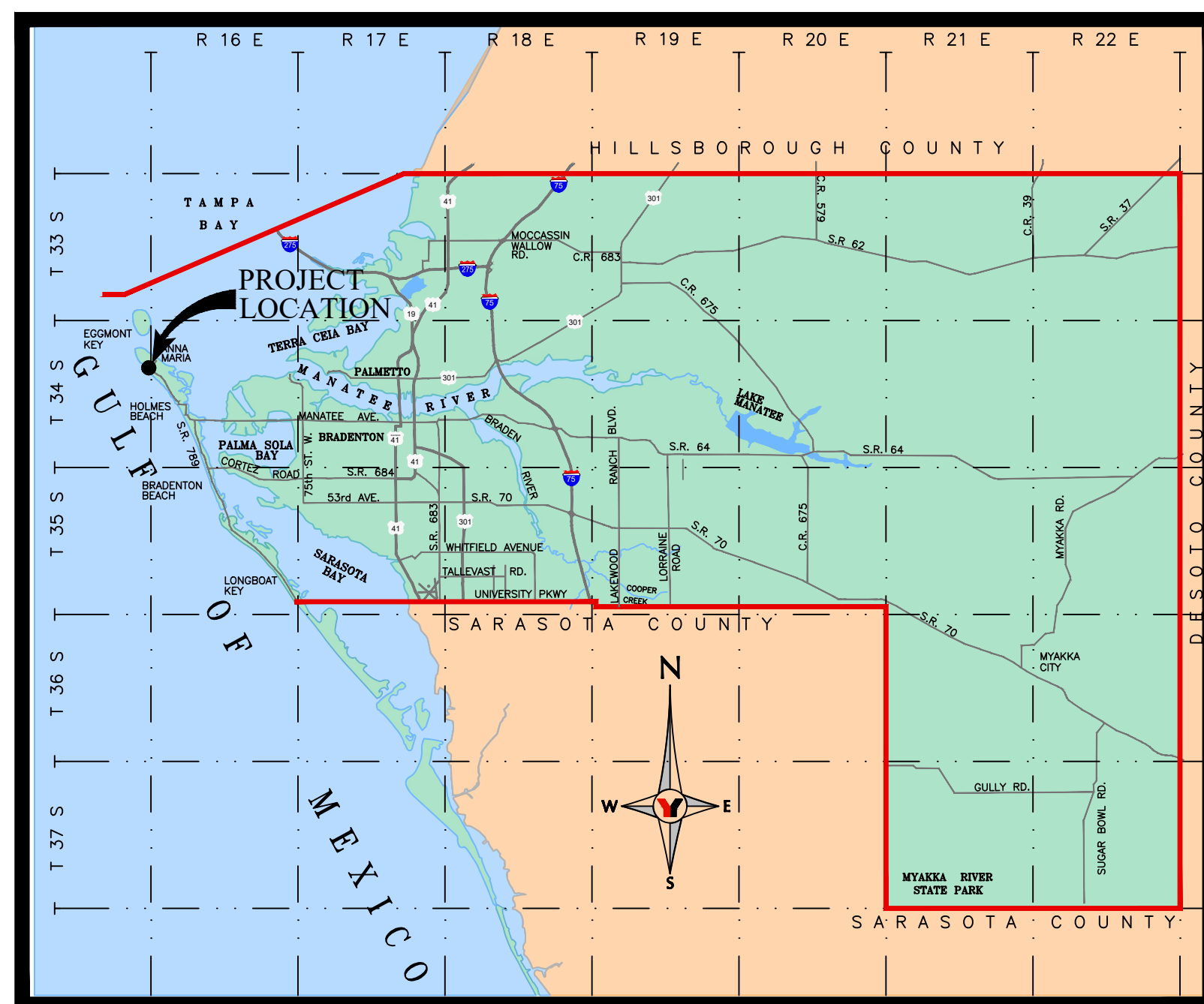

MANATEE COUNTY LOCATION MAP



George F. Young, Inc.

10540 PORTAL CROSSING, SUITE 105 LAKEWOOD RANCH, FLORIDA 34211-4913
PHONE: (941) 747-2981 FAX: (941) 747-7234 WWW.GEORGEFYOUNG.COM
ENGINEERING CERTIFICATE OF AUTHORIZATION NUMBER 21
CIVIL & TRANSPORTATION ENGINEERING | ECOLOGY | GIS | LANDSCAPE ARCHITECTURE
PLANNING | SURVEYING | SUBSURFACE UTILITY ENGINEERING
GAINESVILLE • LAKEWOOD RANCH • ORLANDO • ST. PETERSBURG • TAMPA

PROJECT NO. 22000100LC

SHEET INDEX	
SHEET NO.	DESCRIPTION
--	COVER
C1	AERIAL SITE PLAN
C2	GENERAL NOTES
C3-C4	PLAN AND PROFILE
C5	DETAILS

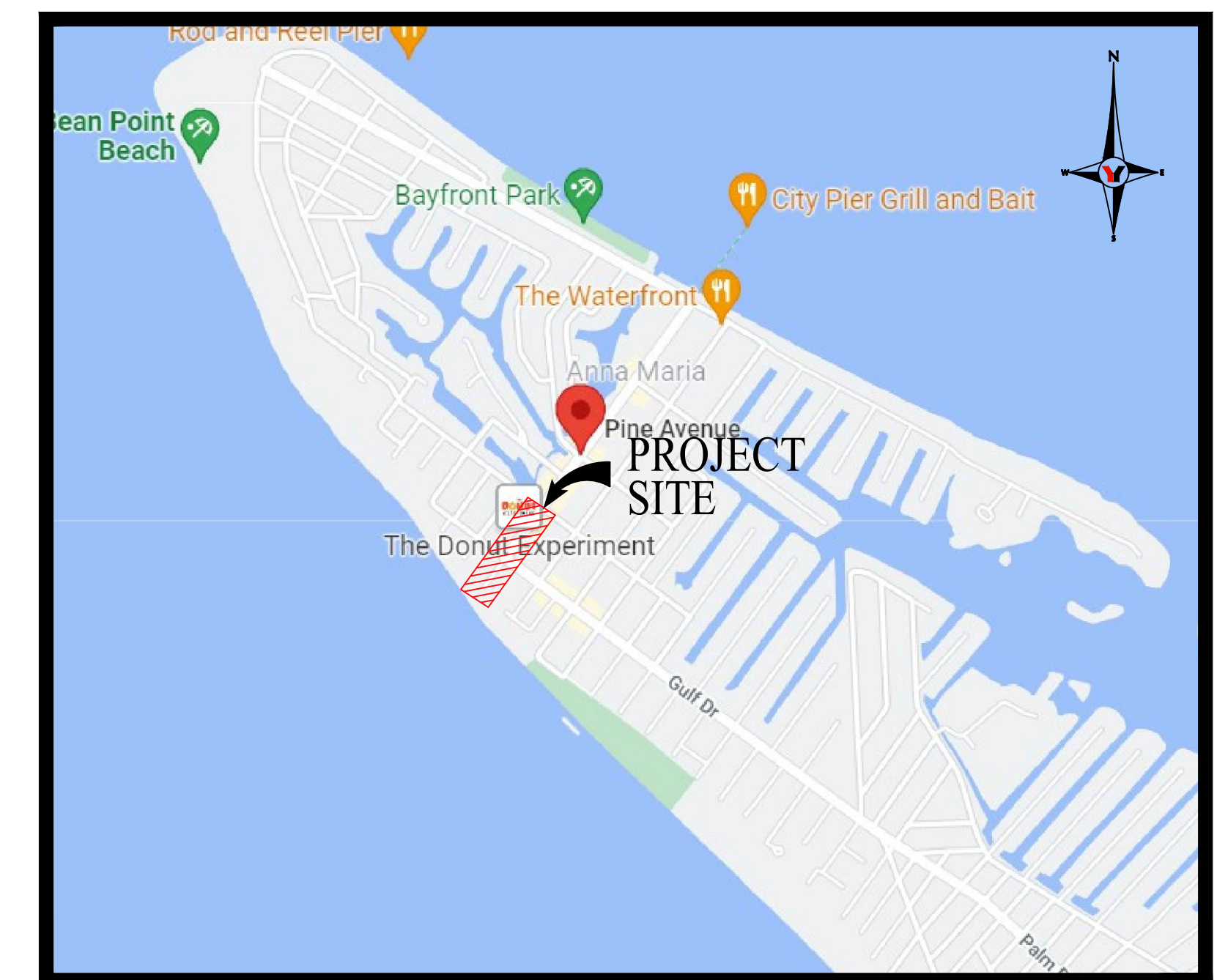

VICINITY MAP

PROJECT CONTACT LIST:

<p>SITE OWNER/DEVELOPER: CITY OF ANNA MARIA 10005 GULF DRIVE ANNA MARIA, FL 34216 PHONE: (941) 708-6130</p> <p>CIVIL ENGINEERING: GEORGE F. YOUNG, INC. 10540 PORTAL CROSSING, SUITE 105 LAKEWOOD RANCH, FLORIDA 34211-4913 PHONE: (941) 747-2981 FAX: (941) 747-7234</p> <p>SURVEYOR: GEORGE F. YOUNG, INC. 299 DR. MARTIN LUTHER KING JR. ST. N. ST. PETERSBURG, FLORIDA 33701 PHONE: (727) 822-4317 FAX: (727) 822-2919</p>	<p>DAN MURPHY, MAYOR EMAIL: AMMAYOR@CITYOFANNAMARIA.COM</p> <p>JUAN CARLOS CINTRON, PE EMAIL: JCINTRON@GEORGEFYOUNG.COM</p> <p>PETER LUTZ, PSM EMAIL: LUTZ@GEORGEFYOUNG.COM</p>
---	---

GOVERNING DESIGN STANDARDS:

FLORIDA DEPARTMENT OF TRANSPORTATION FY 2022-23 STANDARD PLANS FOR ROAD AND BRIDGE CONSTRUCTION AND APPLICABLE INTERIM REVISIONS (IRS).

GOVERNING STANDARD SPECIFICATIONS:

FLORIDA DEPARTMENT OF TRANSPORTATION, JULY 2022 STANDARD SPECIFICATIONS FOR ROAD AND BRIDGE CONSTRUCTION



**Know what's below.
Call before you dig.
callsunshine.com**

THE CONTRACTOR IS RESPONSIBLE FOR VERIFYING THE LOCATION, TYPE, MATERIAL AND DEPTH OF ALL UTILITIES IN THE AREA OF THIS PROJECT (ABOVE AND BELOW GROUND). CONTRACTOR SHALL NOTIFY UTILITY OWNER(S) 48 HOURS PRIOR TO BEGINNING WORK. CONTRACTOR TO NOTIFY ENGINEER OF RECORD OF ANY POTENTIAL UTILITY CONFLICTS PRIOR TO ANY CONSTRUCTION ACTIVITIES.

SURVEYOR NOTE

1. THIS SURVEY IS REFERENCED TO A PROJECTION OF THE STATE PLANE COORDINATE SYSTEM OF FLORIDA (NAD 83/11 WEST ZONE)
2. THE FOLLOWING NGS VERTICAL CONTROL POINTS WERE RECOVERED AND UTILIZED FOR THE ELEVATIONS INDICATED HEREON: "972 6262 A TIDAL" NAVD 1988 ELEVATION 2.08' "R 254 NAVD 1988 ELEVATION 10.13'

I HEREBY CERTIFY THAT TO THE BEST OF MY KNOWLEDGE AND BELIEF THE DESIGN OF THIS PROJECT, AS PREPARED UNDER MY PERSONAL DIRECTION AND CONTROL, COMPLIES WITH ALL APPLICABLE STANDARDS.

THESE PLANS ARE IN COMPLIANCE WITH THE "MANUAL OF UNIFORM MINIMUM STANDARDS FOR DESIGN, CONSTRUCTION AND MAINTENANCE FOR STREETS AND HIGHWAYS" AS ADOPTED BY THE FLORIDA DEPARTMENT OF TRANSPORTATION PURSUANT TO SUBSECTIONS 335.075(1) AND (4), FLORIDA STATUTES AND THE COUNTY LAND DEVELOPMENT REGULATIONS.

THESE PLANS ARE IN COMPLIANCE WITH THE AMERICANS WITH DISABILITIES ACT (A.D.A.) MANUAL, AT CURBS, GUTTERS, SIDEWALKS, INTERSECTIONS, ETC.

THESE PLANS ARE IN COMPLIANCE WITH THE FLORIDA ACCESSIBILITY CODE AT CURBS, GUTTERS, SIDEWALKS, INTERSECTIONS, ETC.

WATER MAINS AND HYDRANTS SHALL BE COMPLETED AND SERVICE PRIOR TO COMMENCING VERTICAL CONSTRUCTION ON ANY BUILDING OR BRINGING COMBUSTIBLE STOCK ON SITE.

PINE AVE. SIDEWALK & CROSSWALK DESIGN
CITY OF ANNA MARIA
PHASE 1A PLANS

PROJECT NO. 22000100LC

FOR AGENCY USE

JUAN CARLOS CINTRON, PE No. 66298
DATE

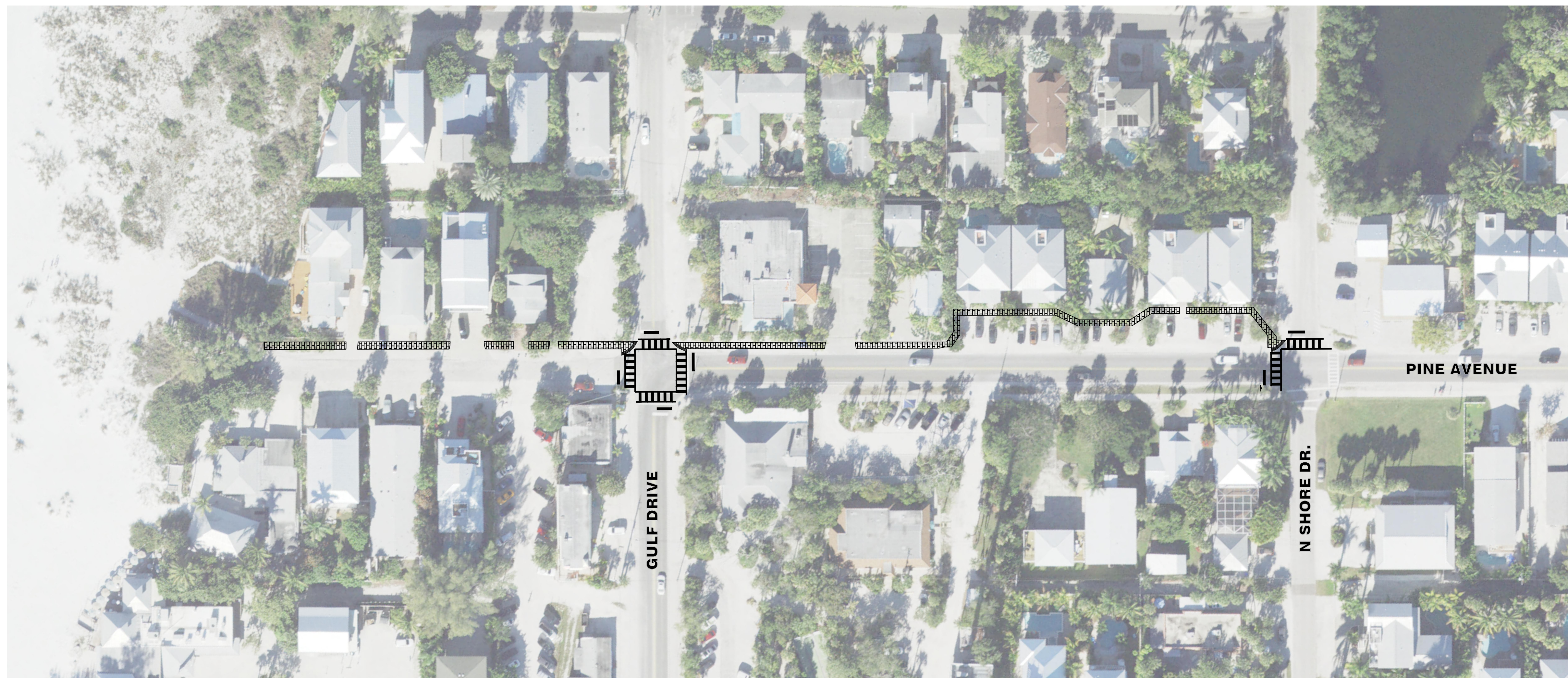
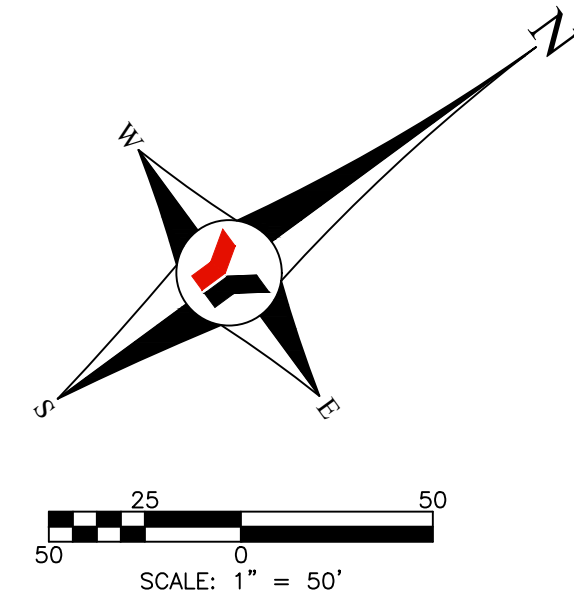

REVISED	NO.	BY	DATE	DESCRIPTION

REVISED	NO.	BY	DATE	DESCRIPTION

DESIGN	INITIALS	DATE
CINTRON	JCC	01/14/22
CHECKED		
QUALITY CHK		
SCALE		

PREPARED FOR:
CITY OF ANNA MARIA
 10005 GULF DRIVE
 ANNA MARIA, FL 34216
 (941) 708-6130



George F. Young, Inc.
 10540 PORTAL CROSSING, SUITE 105 LAKEWOOD RANCH, FLORIDA 34211-4913
 PHONE (941) 747-2981 FAX (941) 747-7234 WWW.GEORGEFYOUNG.COM
 ENGINEERING CERTIFICATE OF AUTHORIZATION NUMBER 21
 CIVIL & TRANSPORTATION ENGINEERING | ECOCLOGY | GIS | LANDSCAPE ARCHITECTURE
 PLANNING | SURVEYING | SUBSURFACE UTILITY ENGINEERING
 GAINESVILLE • LAKEWOOD RANCH • ORLANDO • ST. PETERSBURG • TAMPA

JUAN CARLOS CINTRON, PE No. 66298
 DATE

PINE AVE. SIDEWALK & CROSSWALK DESIGN
AERIAL SITE PLAN
 SECTION 18, TOWNSHIP 34 S., RANGE 16 E.

JOB NO.
22000100LC
 SHEET NO.
C1

FILE: I:\PROJECTS\2022\22000100LC\22000100LC_SitePlan\Phase 1A - Gulf Dr. to North Shore Dr. - Main.dwg, 2/20/2024 4:08 PM
 L0006: Reseachem, ssearch

STATUS NOTES

- THESE DRAWINGS ARE TO BE CONSIDERED PRELIMINARY AND NOT FOR CONSTRUCTION UNTIL ALL PERMIT APPROVALS ARE CONFIRMED RECEIVED BY THE ENGINEER OF RECORD (EOR).
- THESE DRAWINGS MAY CURRENTLY BE UNDER REVIEW BY THE SOUTHWEST FLORIDA WATER MANAGEMENT DISTRICT (SWFWM) AND OTHER REGULATORY AGENCIES. THE FINAL APPROVED PLANS MAY DEVIATE CONSIDERABLY FROM THESE DRAWINGS. THE CONTRACTOR MUST ASSURE CONSTRUCTION IS IN ACCORDANCE WITH THE APPROVED DRAWINGS. PRIOR TO CONSTRUCTION, CONTRACTOR SHALL CONTACT THE EOR TO VERIFY APPROPRIATE PLANS ARE BEING UTILIZED.
- CONSTRUCTION SHOWN ON THESE PLANS IS PERMITTED ONLY FOR THE WORK LOCATED WITHIN PUBLIC RIGHT OF WAY. ALL WORK WITHIN PRIVATE PROPERTY WILL REQUIRE EASEMENTS AND MAY REQUIRE AN ALTERATION TO THE CONSTRUCTION OR MATERIALS SHOWN ON THESE PLANS.

SPECIFICATION AND REGULATION

- ALL SPECIFICATIONS AND DOCUMENTS REFERRED TO IN THESE PLANS SHALL BE OF THE LATEST REVISION, UNLESS OTHERWISE NOTED.
- WHenever a conflict occurs between any specifications, any information shown on the plans and/or any regulatory requirement, the more stringent requirement shall apply.
- THESE DRAWINGS SHALL NOT BE UTILIZED FOR CONSTRUCTION PRIOR TO OBTAINING REQUIRED PERMITS FROM ALL GOVERNMENTAL AGENCIES HAVING JURISDICTION OVER THE WORK. THE CONTRACTOR SHALL OBTAIN ALL PERMITS FROM WORK WITHIN PUBLIC EASEMENTS AND RIGHTS-OF-WAY AND INSURE THAT ALL OTHER REQUIRED PERMITS ARE APPROVED PRIOR TO COMMENCING THE WORK.
- THE CONTRACTOR SHALL BECOME FAMILIAR WITH THE PERMIT AND INSPECTION REQUIREMENTS SPECIFIED BY THE VARIOUS GOVERNMENTAL AGENCIES AND THE EOR'S SPECIFICATIONS. THE CONTRACTOR SHALL REVIEW ALL ACQUIRED PERMITS PRIOR TO CONSTRUCTION, AND SCHEDULE ANY NECESSARY INSPECTIONS ACCORDING TO AGENCY INSTRUCTIONS.
- ALL WORK PERFORMED SHALL COMPLY WITH THE REGULATIONS AND ORDINANCES OF THE VARIOUS GOVERNMENTAL AGENCIES HAVING JURISDICTION OVER THE WORK, INCLUDING STATE AND LOCAL BUILDING CODES.
- ALL RIGHT-OF-WAY INSTALLATIONS WILL BE IN ACCORDANCE WITH PRACTICES REFERENCED IN THE STATE OF FLORIDA UTILITIES ACCOMMODATIONS MANUAL.
- SOME OF THE DETAILS SHOWN INCLUDED IN THIS DRAWING SET ARE PROVIDED BY THE REVIEWING REGULATORY AGENCIES AND ARE REQUIRED BY THOSE AGENCIES TO BE SHOWN ON THE DRAWINGS FOR PERMIT APPROVAL. BY SIGNING AND SEALING THESE DRAWINGS, THE EOR IS NOT ASSUMING RESPONSIBILITY FOR ANY ERRORS OR OMISSIONS ON THESE DETAILS. CONTRACTOR SHALL VERIFY THE DETAILS ARE THE LATEST ISSUED BY THE REGULATORY AGENCY, THE DETAILS COMPLY WITH THE LATEST TECHNICAL MANUAL SPECIFICATIONS, AND THE REGULATORY AGENCY INSPECTOR DOES NOT HAVE ANY ALTERNATE REQUIREMENTS NOT SHOWN ON THE DETAILS.

CONSTRUCTION

- LOCATIONS, ELEVATIONS AND DIMENSIONS OF EXISTING UTILITIES, STRUCTURES, AND OTHER FEATURES ARE SHOWN ACCORDING TO INFORMATION AVAILABLE AT THE TIME OF THE PREPARATION OF THESE PLANS, BUT MAY HAVE BEEN ALTERED WITHOUT THE EOR'S KNOWLEDGE. THE CONTRACTOR SHALL VERIFY THIS INFORMATION AND BE FAMILIAR WITH ALL SITE CONDITIONS (INCLUDING SUB-SURFACE CONDITIONS AND UTILITIES) PRIOR TO COMMENCING THE WORK. DAMAGES TO ANY EXISTING FACILITIES (ABOVE-GROUND AND UNDERGROUND) SHALL BE THE SOLE RESPONSIBILITY OF THE CONTRACTOR, WHETHER OR NOT SHOWN HEREON.
- CONTRACTOR SHALL LOCATE PROPERTY LINES AS REQUIRED TO AVOID ENCRoACHMENT ONTO ADJACENT PROPERTY.
- ANY U.S.C. & G.S. MONUMENTS FOUND WITHIN LIMITS OF CONSTRUCTION ARE TO BE PROTECTED.
- PROPERTY FENCING AND/OR WALLS ON THE PERIMETER OF THE SITE ARE TO BE FIELD VERIFIED WITH ADJACENT PROPERTY OWNERS AS TO WHO OWNS OR MAINTAINS THE FENCEWALL, REGARDLESS OF WHETHER OR NOT SHOWN HEREON TO BE REMOVED OR IF CONSIDERED AN ENCRoACHMENT ON THE WORK TO BE PERFORMED. ANY DAMAGE TO OR REMOVAL OF FENCING/WALLS OWNED OR MAINTAINED BY AN ADJACENT PROPERTY OWNER IS TO BE FULLY REPLACED WITH A SIMILAR FENCEWALL, TO THE SATISFACTION OF THE ADJACENT PROPERTY OWNER, AT THE EXPENSE OF THE CONTRACTOR.
- IT SHALL BE THE RESPONSIBILITY OF THE CONTRACTOR TO ASSURE THE STAKEOUT SURVEYOR HAS THE MOST CURRENT SET OF PLANS, INCLUDING ALL RECENT REVISIONS MADE BY ADDENDUM OR REQUEST FOR INFORMATION (RFI), REGARDLESS IF STAKEOUT IS CONTRACTED THROUGH THE ENGINEER'S SURVEY DEPARTMENT.
- UPON REQUEST, ELECTRONIC DATA (IN AUTOCAD FORMAT), ASSOCIATED WITH THESE SITE PLANS WILL BE PROVIDED FOR CONSTRUCTION LAYOUT PURPOSES. HOWEVER, THE ENGINEER OF RECORD (EOR) WILL IN NO WAY BE RESPONSIBLE FOR ANY ADVERSE RESULTS IF THE ELECTRONIC DATA IS USED BY OTHERS FOR CONSTRUCTION PURPOSES (REGARDLESS OF WHETHER OR NOT THE ELECTRONIC DATA CONTAINS ERRORS) (AS AN OPTION, COORDINATE GEOMETRY INFORMATION ASSOCIATED WITH THESE SITE PLANS WILL BE PROVIDED BY THE EOR, AT THE CONTRACTOR'S EXPENSE.)
- CONTRACTOR SHALL SUBMIT SHOP DRAWINGS ON ALL PRECAST AND MANUFACTURED ITEMS TO THE EOR FOR APPROVAL A MINIMUM OF SEVEN (7) WORKING DAYS IN ADVANCE OF THE CONTRACTOR'S NEED FOR THE SAME. FAILURE TO OBTAIN APPROVAL BEFORE INSTALLATION MAY RESULT IN REMOVAL AND REPLACEMENT AT THE CONTRACTOR'S EXPENSE.
- AT LEAST (3) WORKING DAYS PRIOR TO CONSTRUCTION, THE CONTRACTOR SHALL NOTIFY THE ENGINEER AND APPROPRIATE AGENCIES AND SUPPLY THEM WITH THE CONTRACTOR'S NAME, STARTING DATE, PROJECTED CONSTRUCTION SCHEDULE, ALL REQUIRED SHOP DRAWINGS AND OTHER INFORMATION AS REQUIRED. ANY WORK PERFORMED PRIOR TO NOTIFYING THE ENGINEER OR WITHOUT AN AGENCY INSPECTOR PRESENT MAY BE SUBJECT TO REMOVAL AND REPLACEMENT AT THE CONTRACTOR'S EXPENSE.
- CONTRACTOR SHALL LOCATE ALL EXISTING UTILITIES AND VERIFY ALL FIELD CONDITIONS BEFORE ORDERING ANY MATERIALS AND CASTING ANY STRUCTURES AS SHOWN.
- WORK PERFORMED UNDER THIS CONTRACT SHALL INTERFACE SMOOTHLY WITH OTHER WORK BEING PERFORMED ON SITE BY OTHER CONTRACTORS AND UTILITY COMPANIES. IT WILL BE NECESSARY FOR THE CONTRACTOR TO COORDINATE AND SCHEDULE HIS ACTIVITIES, WHERE NECESSARY, WITH OTHER CONTRACTORS AND UTILITY COMPANIES, INCLUDING BUT NOT LIMITED TO THE ONES SHOWN ON THE COVER SHEET.
- CONTRACTOR SHALL PROVIDE AND MAINTAIN ALL TEMPORARY CONSTRUCTION TRAFFIC RELATED ACCESS POINTS TO THE PROJECT SITE AND/OR SPECIFIC AREAS OF WORK ON THE PROJECT SITE AS NECESSARY.
- CONTRACTOR TO FIELD COORDINATE PHASING OF ALL CONSTRUCTION TO LIMIT INTERRUPTION OF TRAFFIC FLOW AND DAILY OPERATIONS.
- CONTRACTOR IS RESPONSIBLE FOR ESTIMATING AND CALCULATING ALL CUT AND FILL QUANTITIES BASED ON VERIFICATION OF THE TOPOGRAPHY PROVIDED. PRIOR TO BID SUBMISSION THE CONTRACTOR SHALL CONDUCT ANY ADDITIONAL SURVEYS AND SOIL TESTS HE DEEMS NECESSARY TO CALCULATE THE CUT AND FILL QUANTITIES PROPERLY. ADDITIONAL SURVEYS AND TESTS MADE BY THE CONTRACTOR SHALL BE AT NO COST TO THE OWNER.
- ALL CONSTRUCTION DEBRIS AND OTHER WASTE MATERIALS SHALL BE DISPOSED OF OFF-SITE IN ACCORDANCE WITH APPLICABLE REGULATORY AGENCY REQUIREMENTS.
- ANY DAMAGE TO STATE, COUNTY, OR LOCAL ROADS CAUSED BY THE CONTRACTOR'S HAULING OR EXCAVATION EQUIPMENT SHALL BE REPAIRED BY THE CONTRACTOR TO THE SATISFACTION OF THE ENGINEER.
- RESTORE ALL AREAS DISTURBED BY CONSTRUCTION TO CONDITIONS PRIOR TO CONSTRUCTION. SPECIAL CARE SHOULD BE TAKEN TO RESTORE OFF-SITE AREAS DISTURBED BY CONSTRUCTION. THE CONTRACTOR SHALL REPLACE ALL PAVING, STABILIZED EARTH, CURBS, DRIVEWAYS, SIDEWALKS, ETC. WITH MATERIALS OF THE SAME TYPE OR BETTER THAN THAT REMOVED DURING CONSTRUCTION.
- CONTRACTOR SHALL PROVIDE REDEFINED DESIGN PLANS TO DOCUMENT CHANGES IN WORK DURING CONSTRUCTION INCLUDING DIRECTIVES AND ADDENDA NO LATER THAN THIRTY (30) DAYS PRIOR TO THE CERTIFICATE OF OCCUPANCY DATE.
- CONTRACTOR TO OBTAIN APPLICABLE PERMITS PRIOR TO COMMENCEMENT OF CONSTRUCTION.
- THE CONTRACTOR IS RESPONSIBLE FOR COORDINATION AND ISSUANCE OF ALL COMMENCEMENT AND/OR PROGRESS NOTICES TO GOVERNMENTAL AGENCIES DURING THE COURSE OF CONSTRUCTION, AS REQUIRED FOR INSPECTION, TESTING AND TRACKING PER APPLICABLE AGENCY PERMIT CONDITIONS.
- ALL FILL AREAS ARE TO BE CONSTRUCTED IN 12" MAXIMUM LIFTS.

SAFETY

- DURING THE CONSTRUCTION AND MAINTENANCE OF THIS PROJECT, ALL SAFETY REGULATIONS ARE TO BE ENFORCED. THE CONTRACTOR OR HIS REPRESENTATIVE SHALL BE RESPONSIBLE FOR THE CONTROL AND SAFETY OF THE TRAVELING PUBLIC AND THE SAFETY OF HIS PERSONNEL.
- THE CONTRACTOR IS RESPONSIBLE FOR SIGNS AND BARRICADES TO BE ACCORDING TO FDOT MANUAL OF SAFE PRACTICES; REFERENCE FDOT STANDARD PLANS SECTION 102 TO INCLUDE MAINTENANCE OF TRAFFIC AND PEDESTRIAN CONTROL.
- LABOR SAFETY REGULATIONS SHALL CONFORM TO THE PROVISIONS SET FORTH BY OSHA IN THE FEDERAL REGISTER OF THE DEPARTMENT OF TRANSPORTATION.
- CONTRACTOR SHALL PROVIDE AND MAINTAIN HIS OWN SAFETY EQUIPMENT IN ACCORDANCE WITH HIS HEALTH AND SAFETY PROGRAM AND ALL OTHER APPLICABLE LEGAL AND HEALTH AND SAFETY REQUIREMENTS. THE CONTRACTOR IS ALSO RESPONSIBLE FOR PROVIDING HIS EMPLOYEES AND SUBCONTRACTORS WITH ADEQUATE INFORMATION AND TRAINING TO ENSURE THAT ALL EMPLOYEES AND SUBCONTRACTORS AND SUBCONTRACTORS' EMPLOYEES COMPLY WITH ALL APPLICABLE REQUIREMENTS. CONTRACTOR SHALL REMAIN IN COMPLIANCE WITH ALL OCCUPATION SAFETY AND HEALTH REGULATIONS AS WELL AS THE ENVIRONMENTAL PROTECTION LAWS. THE FOLLOWING IS NOT PERCEIVED AS THE ENTIRE SAFETY PROGRAM, BUT JUST BASIC REQUIREMENTS.
- ALL EXCAVATIONS BY THE CONTRACTOR SHALL CONFORM TO THE REQUIREMENTS OF THE DEPARTMENT OF LABOR'S OCCUPATIONAL SAFETY AND HEALTH ADMINISTRATION RULES AND REGULATIONS. PARTICULAR ATTENTION MUST BE PAID TO THE CONSTRUCTION

STANDARDS FOR EXCAVATIONS, 29 CFR PART 1926, SUBPART P.

- THE CONTRACTOR SHALL BE RESPONSIBLE FOR PROTECTING EXCAVATIONS AGAINST COLLAPSE AND WILL PROVIDE BRACING, SHEETING OR SHORING AS NECESSARY. DEWATERING METHODS SHALL BE USED AS REQUIRED TO KEEP TRENCHES DRY WHILE PIPE AND APPURTENANCES ARE BEING PLACED.
- THE MINIMUM STANDARDS AS SET FORTH IN THE CURRENT EDITION OF THE STATE OF FLORIDA, MANUAL ON TRAFFIC CONTROL AND SAFE PRACTICES FOR STREET AND HIGHWAY CONSTRUCTION, MAINTENANCE AND UTILITY OPERATIONS SHALL BE FOLLOWED IN THE DESIGN APPLICATION, INSTALLATION, MAINTENANCE AND REMOVAL OF ALL TRAFFIC CONTROL DEVICES, WARNING DEVICES AND BARRIERS NECESSARY TO PROTECT THE PUBLIC AND WORKMEN FROM HAZARDS WITHIN PROJECT LIMITS.
- ALL TRAFFIC CONTROL MARKINGS AND DEVICES SHALL CONFORM TO THE PROVISIONS SET FORTH IN THE MANUAL ON UNIFORM TRAFFIC CONTROL AND TRAFFIC DESIGN STANDARD INDEX PREPARED BY THE U.S. DEPARTMENT OF TRANSPORTATION FEDERAL HIGHWAY ADMINISTRATION.
- IT SHALL BE THE SOLE RESPONSIBILITY OF THE CONTRACTOR TO COMPLY AND ENFORCE ALL APPLICABLE SAFETY REGULATIONS. THE ABOVE INFORMATION HAS BEEN PROVIDED FOR THE CONTRACTOR'S INFORMATION ONLY AND DOES NOT IMPLY THAT THE OWNER OR ENGINEER WILL INSPECT AND/OR ENFORCE SAFETY REGULATIONS.
- ALL SUBSURFACE CONSTRUCTION SHALL COMPLY WITH THE "TRENCH SAFETY ACT". THE CONTRACTOR SHALL INSURE THAT THE METHOD OF TRENCH PROTECTION AND SHORING IS AS SHOWN AND IS IN ACCORDANCE WITH THE ADMINISTRATION (OSHA) REGULATIONS. IT SHALL BE THE SOLE RESPONSIBILITY OF THE CONTRACTOR TO COMPLY AND ENFORCE ALL APPLICABLE SAFETY REGULATIONS.
- THE CONTRACTOR SHALL EXERCISE EXTREME CAUTION IN THE AREAS OF BURIED UTILITIES AND SHALL PROVIDE AT LEAST 48 HOURS NOTICE TO THE UTILITY COMPANIES PRIOR TO CONSTRUCTION TO OBTAIN FIELD LOCATIONS OF EXISTING UNDERGROUND UTILITIES. CALL SUNSHINE ONE (1-800-432-4770) TO ARRANGE FIELD LOCATIONS.
- ANY SIDEWALK WHICH BECOMES UNDERMINED OR DAMAGED DURING CONSTRUCTION MUST BE REMOVED AND REPLACED. PERMITS WILL BE OBTAINED BY THE CONTRACTOR FOR THE CLOSING OF SIDEWALKS IN THE RIGHT-OF-WAY. SIDEWALKS ARE TO BE RECONSTRUCTED WITHIN THREE (3) DAYS AFTER REMOVAL. WHEN EXISTING SIDEWALK IS REMOVED, IT IS TO BE REMOVED TO THE NEAREST JOINT.
- WHERE ANY VEHICLE, EQUIPMENT, WORKERS OR THEIR ACTIVITIES ENCRoACH ON THE SIDEWALK FOR A PERIOD OF MORE THAN ONE HOUR, CONTRACTOR SHALL PROVIDE PEDESTRIAN CONTROL FOR CLOSURE OF SIDEWALKS PER FDOT STANDARD PLAN 102-660, UNLESS OTHERWISE NOTED.
- CONTRACTOR SHALL SECURE ALL OPENINGS UNDER CONSTRUCTION AT THE END OF EACH WORKING DAY.

EROSION CONTROL

- THE CONTRACTOR IS RESPONSIBLE FOR SITE CONDITIONS FROM THE DATE OF NOTICE TO PROCEED, UNTIL THE PROJECT IS ACCEPTED BY THE OWNER, ENGINEER OF RECORD (EOR) AND THE LOCAL REGULATORY AGENCIES. ACCORDINGLY, THE CONTRACTOR IS SOLELY RESPONSIBLE AND SHALL MANAGE HIS WORK AND TAKE ALL NECESSARY STEPS TO CONTROL FUGITIVE DUST, CONTROL AND PREVENT EROSION, AND TRANSPORT OF SEDIMENT INTO EXISTING WETLANDS, DRAINAGE WAYS, CONSERVATION AREAS, NATURAL AREAS AND OFFSITE AREAS, AS WELL AS NEWLY CONSTRUCTED ROADWAYS, STORMWATER FACILITIES AND MITIGATION AREAS. THIS MAY REQUIRE ADDITIONAL MEASURES FROM THOSE SHOWN ON THE CONSTRUCTION PLANS, SUCH AS WINDROWS, DIVERSION SWALES, SEED & MULCH, STAKED HAY BALES, OR OTHER EROSION CONTROL MEASURES NECESSARY TO REACT TO VARYING SITE CONDITIONS OR UNCLEMOUNTY WEATHER. IF EROSION OCCURS, THE CONTRACTOR SHALL IMMEDIATELY REMEDY THE DAMAGE CAUSED BY SUCH EROSION BY CONTROLLED REMOVAL OF SEDIMENTS, REPLANTING IF NECESSARY AND RE-ESTABLISHMENT OF EROSION PROTECTION DEVICES, AT THE CONTRACTOR'S SOLE EXPENSE.
- EROSION CONTROL AND FUGITIVE PARTICULATE ABATEMENT PLANS ARE THE RESPONSIBILITY OF THE CONTRACTOR.
- THE CONTRACTOR SHALL INSTALL WATER QUALITY AND EROSION CONTROL DEVICES ALONG THE PROJECT PERIMETER, AS DESIGNATED ON THESE PLANS. THE CONTRACTOR SHALL RECEIVE THE ENGINEER'S APPROVAL OF THE INSTALLATION PRIOR TO ANY OTHER SITE CONSTRUCTION.
- DAILY INSPECTION OF THE EROSION CONTROL WILL BE REQUIRED BY THE CONTRACTOR. ANY DISTURBANCE OF THESE DEVICES SHALL BE REPAIRED IMMEDIATELY.
- CONTRACTOR IS TO PROVIDE EROSION CONTROL AND SEDIMENTATION BARRIER (HAY BALES, TURBIDITY BARRIERS OR SILTATION CURTAIN) TO PREVENT SILTATION OF ADJACENT PROPERTY, STREETS, STORM SEWERS AND WATERWAYS. IN ADDITION, CONTRACTOR SHALL PLACE STRAW, MULCH OR OTHER SUITABLE MATERIAL ON GROUND IN AREAS WHERE CONSTRUCTION RELATED TRAFFIC IS TO ENTER AND EXIT SITE. IF, IN THE OPINION OF THE EOR AND/OR LOCAL AUTHORITIES, EXCESSIVE QUANTITIES OF EARTH ARE TRANSPORTED OFF-SITE EITHER BY NATURAL DRAINAGE OR BY VEHICULAR TRAFFIC, THE CONTRACTOR IS TO REMOVE SAID EARTH TO THE SATISFACTION OF THE EOR AND/OR AUTHORITIES.
- IF WIND EROSION BECOMES SIGNIFICANT DURING CONSTRUCTION, THE CONTRACTOR SHALL STABILIZE THE AFFECTED AREA USING SPRINKLING, IRRIGATION OR OTHER ACCEPTABLE METHODS.
- THE CONTRACTOR WILL STABILIZE BY SEED AND MULCH, SOD OR OTHER APPROVED MATERIALS ANY DISTURBED AREAS WITHIN ONE WEEK FOLLOWING CONSTRUCTION OF THE UTILITY SYSTEMS AND PAVEMENT AREAS AND UNTIL THE DISTURBED AREAS ARE COMPLETELY STABILIZED AND/OR VEGETATED. ALL SURFACES DISTURBED FOR 30 OR MORE DAYS SHALL BE VEGETATED WITH A TEMPORARY OR PERMANENT COVER. CONTRACTOR SHALL MAINTAIN SUCH AREAS UNTIL FINAL ACCEPTANCE BY OWNER.
- TO MINIMIZE SOIL EROSION, PROPOSED LAND ALTERATION ACTIVITIES SHALL NOT UNNECESSARILY REMOVE EXISTING VEGETATION AND ALTER EXISTING TOPOGRAPHY. ADEQUATE PROTECTION MEASURES (IE HAY BALES, BARFLES, SODDING AND SANDGAGGING) SHALL BE PROVIDED, AS NECESSARY TO MINIMIZE EROSION AND DOWNSTREAM SEDIMENTATION CAUSED BY SURFACE WATER RUN-OFF ON EXPOSED LAND SURFACES.
- ANY AREAS SUBJECT TO EROSION MUST BE ADEQUATELY STABILIZED WITH VEGETATIVE MATERIAL THAT WILL, IN A REASONABLE TIME FRAME, DETER SOIL DISTURBANCE. SODDING, PLUGGING, SPRIGGING OR SEEDING IS ACCEPTABLE FOR STABILIZATION. HOWEVER, SODDING MAY BE REQUIRED IN AREAS OF EROSION-PRONE SOILS OR WHERE SLOPES ARE GREATER THAN 5:1. VEGETATION OTHER THAN GRASS IS ACCEPTABLE UNLESS OTHERWISE SPECIFIED. SILT FENCES, HAY BALES, AND/OR TURBIDITY BARRIERS SHALL BE INSTALLED AT ALL OFF-SITE DISCHARGE POINTS.
- THE CONTRACTOR MUST SELECT, IMPLEMENT, AND OPERATE ALL EROSION AND SEDIMENT CONTROL MEASURES REQUIRED TO RETAIN SEDIMENT ON-SITE AND TO PREVENT VIOLATIONS OF WATER QUALITY STANDARD AS SPECIFIED IN CHAPTERS 17-301, 17-302, 17-4, F.A.C.
- THE CONTRACTOR IS ENCOURAGED TO USE APPROPRIATE BEST MANAGEMENT PRACTICES FOR EROSION AND SEDIMENT CONTROLS AS DESCRIBED IN THE FLORIDA LAND DEVELOPMENT MANUAL - A GUIDE TO SOUND LAND AND WATER MANAGEMENT (DER, 1988).
- EROSION CONTROL DEVICES AND MEASURES DESCRIBED IN THESE GENERAL NOTES ARE GRAPHICALLY SHOWN ON THE PLANS. REFER TO THE FLORIDA STORMWATER EROSION AND SEDIMENTATION CONTROL INSPECTOR'S MANUAL (LATEST EDITION), THE FLORIDA EROSION AND SEDIMENT CONTROL DESIGNER AND REVIEWER MANUAL (JUNE 2007), THE BEST MANAGEMENT PRACTICES (BMP) PLAN INCLUDED HEREIN, THE CONSTRUCTION SURFACE WATER MANAGEMENT PLAN (CSWMP) INCLUDED HEREIN, AND/OR THE STORMWATER POLLUTION PREVENTION PLAN (SWPPP) FOR ADDITIONAL DETAILS, INSTRUCTIONS AND SCHEDULING AS APPLICABLE.
- THE CONTRACTOR WILL BE REQUIRED TO ADHERE TO THE SPECIFIC EROSION CONTROL MEASURES DESCRIBED ABOVE AND SHOWN ON THE PLANS ALONG WITH A SPECIFIC CONSTRUCTION SCHEDULE FOR IMPLEMENTATION. THE CONTRACTOR WILL ALSO BE REQUIRED TO MODIFY THE PLAN OR MATERIALS TO ADAPT TO SEASONAL VARIATIONS.
- THE CONTRACTOR IS RESPONSIBLE FOR DETERMINING IF ADDITIONAL CONTROLS ARE NEEDED AND DEPLOYMENT SCHEDULES FOR THE IMPLEMENTATION OF ALL EROSION CONTROL DEVICES THROUGHOUT CONSTRUCTION.
- SILTATION ACCUMULATIONS GREATER THAN THE LESSER OF 12 INCHES OR ONE HALF THE DEPTH OF THE SILTATION CONTROL BARRIER SHALL BE IMMEDIATELY REMOVED AND PLACED IN UPLAND AREAS.
- ALL APPLICATIONS FOR ESCP SUBMITTED PURSUANT TO SECTION 519 OF THE MANATEE COUNTY LDC SHALL INCLUDE A PLAN WHICH IDENTIFIES THE FOLLOWING:
 - DETAILS OF CONSTRUCTION SEQUENCING, DEWATERING ACTIVITIES AND SUMP LOCATIONS, STOCKPILE AREAS AND/OR DEPOSITION AREAS FOR EXCAVATED MATERIALS.
 - DESCRIPTION OF LAND CLEARING/DISTURBING ACTIVITIES, EXISTING SITE CONDITIONS AND ADJACENT LAND USES/AREAS THAT MIGHT BE AFFECTED BY LAND CLEARING/DISTURBANCES. LAND CLEARING SHALL BE CONDUCTED WITHIN THE SILT SCREEN AREAS ONLY. NO ACTIVITIES SHALL BE PERMITTED UNLESS ADDITIONAL SILT FENCES ARE INSTALLED TO PROTECT THOSE AREAS.
 - IDENTIFICATION OF STOCKPILE AREAS AND/OR DEPOSITION AREAS FOR EXCAVATED MATERIALS. STOCKPILING OF MATERIALS SHALL BE AT A MINIMUM.
 - DESCRIPTION OF POTENTIAL ON-SITE PROBLEM AREAS SUCH AS STEEP GRADE CHANGES, HIGHLY ERODIBLE SOILS, AREAS ADJACENT TO WETLANDS, SURFACE WATERS, OR UPLAND PRESERVATION AREAS. ALL AREAS AT GRADES OF 4:1 OR STEEPER SHALL BE SODDED AFTER FILL IS PLACED OR ADDITIONAL SILT SCREENS SHALL BE USED TO MINIMIZE EROSION.
 - CONSTRUCTION SCHEDULING, INCLUDING THE EXPECTED STARTING AND STABILIZATION DATES. SEE NOTES ON SHEET C5.
 - IDENTIFICATION OF DISTURBED AREAS WHERE CONSTRUCTION WILL NOT BE ONGOING AND FINAL GRADE WILL NOT BE ACHIEVED WITHIN FOURTEEN (14) DAYS, AND AN INDICATION OF TEMPORARY STABILIZATION MEASURES. IN THE CASE WHERE STABILIZATION IS NEEDED FOR TEMPORARY STOCKPILE OF MATERIALS, THE MATERIALS SHALL BE PLACED IN THE AREA BETWEEN THE PARKING AND STORMWATER FACILITY UTILIZING SILT SCREENS AT THE TOE OF SLOPE.
 - DETAILS OF BEST MANAGEMENT PRACTICES AND FUGITIVE PARTICULATE ABATEMENT METHODS.
 - DETAILS, DRAWINGS AND CROSS-SECTIONS OF EROSION AND SEDIMENT CONTROL DEVICES. IF DIFFERENT FROM THE APPROVED FINAL SITE PLAN/CONSTRUCTION PLANS, AND WHEN THEY WILL BE INSTALLED. EROSION CONTROL DEVICES SHALL BE INSTALLED IN THE FIRST PHASE OF CONSTRUCTION SEE SHEET C5 FOR LOCATIONS AND DETAILS.
 - MAINTENANCE PROGRAM FOR EROSION AND SEDIMENT CONTROL DEVICES INCLUDING INSPECTION FREQUENCY AND MAINTENANCE ACTIVITIES. SEE NOTE 4 ABOVE UNDER EROSION CONTROL.
 - DETAILS OF FUGITIVE PARTICULATE ABATEMENT METHODS. SEE DETAILS ON SHEET C5.
 - CONTRACTOR INFORMATION, INCLUDING A TWENTY-FOUR-HOUR, SEVEN-DAY CONTACT AND PHONE NUMBERS. SEE CONTRACTOR INFORMATION ON PROJECT COVER SHEET.

DEMOLITION

- DEMOLITION WORK SHALL NOT BE LIMITED TO THESE DOCUMENTS. CONTRACTOR TO VERIFY ALL EXISTING CONDITIONS AND EXTENT OF REMOVAL OF ITEMS SHOWN PRIOR TO USING THIS INFORMATION FOR BID PURPOSES.
- ANY STRUCTURE NOT SHOWN TO BE REMOVED IS TO REMAIN UNLESS OTHERWISE INSTRUCTED BY THE OWNER OR ARCHITECT, OR REQUIRED BY FIELD CONDITIONS.
- CONTRACTOR TO COMPLETELY REMOVE EXISTING ITEMS ON SITE INCLUDING BUILDINGS, CURBS, ASPHALT, BASE COURSE, CONCRETE AND EXISTING UTILITIES (AS APPLICABLE) AS SHOWN AND NECESSARY TO ALLOW FOR NEW CONSTRUCTION.
- LOCAL CODES APPLY FOR ANY DEMOLITION SHOWN HEREON.
- CONTRACTOR TO COORDINATE WITH LOCAL UTILITY COMPANIES, FOR ANY UTILITIES SHOWN TO BE REMOVED OR RELOCATED HEREON, EARLY IN CONSTRUCTION PROCESS, AS TO AVOID ANY DELAYS.
- CONTRACTOR TO FIELD COORDINATE PHASING OF ALL DEMOLITION TO LIMIT INTERRUPTION OF TRAFFIC FLOW AND DAILY OPERATIONS.
- CONTACT ENGINEER OF RECORD (EOR) IMMEDIATELY IF ANY UNDERGROUND STRUCTURES, FOUND DURING EXCAVATION, IMPEDE THE COMPLETION OF CONSTRUCTION AS SHOWN.

- SOME ITEMS SHOWN TO BE REMOVED MAY NEED TO BE RELOCATED TO OTHER AREAS ON SITE AT THE REQUEST OF THE OWNER. CONTRACTOR TO FIELD COORDINATE.
- THERE MAY EXIST IRRIGATION LINES IN THE AREA OF WORK THAT NEED TO BE REMOVED AND/OR RELOCATED. THAT ARE NOT SHOWN HEREON. CONTRACTOR TO FIELD VERIFY THE EXTENT OF IRRIGATION WORK TO BE PERFORMED PRIOR TO BID. CONTRACTOR TO COORDINATE RELOCATION WITH OWNER OR LANDSCAPE ARCHITECT PRIOR TO CONSTRUCTION, AS APPLICABLE.
- IN AREAS WHERE ASPHALT IS SHOWN TO BE REMOVED, BASE MAY REMAIN IF AREA IS PROPOSED TO BE COVERED WITH CONCRETE (WALKS, PAVEMENT, ETC.)

EARTHWORKS

- ALL FILL SHALL CONSIST OF SATISFACTORY SOIL MATERIALS, DEFINED AS THOSE COMPLYING WITH ASTM D2487 SOIL CLASSIFICATION GROUPS (GW, GP, GM, SW, SM AND SPI FEW) OF RUBBLE, ORGANICS, CLAY, DEBRIS AND OTHER SIMILAR UNSUITABLE MATERIALS. UNSATISFACTORY SOIL MATERIALS ARE DEFINED AS THOSE COMPLYING WITH ASTM D2487 SOIL CLASSIFICATION GROUPS (G, SC, ML, MH, CL, CH, OL, OH, AND PT). UNLESS OTHERWISE NOTED, ALL FILL SHALL BE COMPACTED TO A MINIMUM OF 95% AASHTO T-160, METHOD D.
- REMAINING EARTHWORK THAT RESULTS FROM CLEARING AND GRUBBING OR SITE EXCAVATION IS TO BE UTILIZED ON-SITE IF REQUIRED. PROVIDED THAT THE MATERIAL IS DEEMED SUITABLE FOR CONSTRUCTION BY THE MATERIALS TESTING COMPANY. EXCESS MATERIAL IS TO BE EITHER STOCKPILED ON THE SITE AS DIRECTED BY THE OWNER OR ENGINEER OF RECORD (EOR), OR REMOVED FROM THE SITE. THE CONTRACTOR IS RESPONSIBLE FOR ACQUIRING ANY PERMITS THAT ARE NECESSARY FOR REMOVING EXCESS EARTHWORK FROM THE SITE.
- ALL DELETERIOUS SUBSURFACE MATERIAL (I.E. MUCK, PEAT, BURIED DEBRIS) IS TO BE EXCAVATED IN ACCORDANCE WITH THESE PLANS OR AS DIRECTED BY THE OWNER, THE EOR, OR MATERIALS TESTING COMPANY. DELETERIOUS MATERIAL IS TO BE STOCKPILED OR REMOVED FROM THE SITE AS DIRECTED BY THE OWNER. EXCAVATED AREAS TO BE BACKFILLED WITH APPROVED MATERIALS AND COMPACTED AS SHOWN ON THESE PLANS. CONTRACTOR IS RESPONSIBLE FOR ACQUIRING ANY PERMITS THAT ARE NECESSARY FOR REMOVING DELETERIOUS MATERIAL FROM THE SITE.
- ALL NECESSARY FILL AND EMBANKMENT THAT IS PLACED DURING CONSTRUCTION SHALL CONSIST OF MATERIAL SPECIFIED BY THE MATERIALS TESTING COMPANY OR THE EOR AND BE PLACED AND COMPACTED ACCORDING TO THESE PLANS.
- THE CONTRACTOR IS RESPONSIBLE FOR COORDINATING APPLICABLE TESTING WITH THE MATERIALS TESTING FIRM. TESTS WILL BE REQUIRED PURSUANT TO THE LOCAL REGULATORY AGENCY OR THE EOR SPECIFICATIONS. UPON COMPLETION OF PROPOSED CONSTRUCTION, THE CONTRACTOR'S MATERIALS TESTING FIRM SHALL PROVIDE A CERTIFICATION SIGNED AND SEALED BY A PROFESSIONAL ENGINEER LICENSED IN THE STATE OF FLORIDA, CERTIFYING THAT THE TESTING PROGRAM HAS BEEN COMPLETED IN ACCORDANCE WITH THE PROJECT PLANS, SPECIFICATIONS, AND LOCAL REGULATORY REQUIREMENTS, AND THAT THE COMPLETED PROJECT COMPLIES WITH THE TESTING CRITERIA CONTAINED THEREIN.
- A QUALIFIED TESTING LABORATORY SHALL PERFORM ALL TESTING NECESSARY TO ASSURE COMPLIANCE OF THE IN PLACE MATERIALS AS REQUIRED BY THESE PLANS AND THE VARIOUS AGENCIES. SHOULD ANY RETESTING BE REQUIRED DUE TO THE FAILURE OF ANY TESTS TO MEET THE REQUIREMENTS, THE CONTRACTOR WILL BEAR ALL COSTS OF SAID RETESTING. THE EOR WILL REVIEW THE TESTING REPORTS FOR COMPLIANCE WITH THE REQUIRED SPECIFICATIONS, BUT MAKES NO CLAIM AS TO THE CONTRACTOR'S PROPER MEANS AND METHODS OF EARTHWORK OPERATIONS THAT TOOK PLACE DURING CONSTRUCTION BY DOING SO.
- COMPACTION FOR PIPE BACKFILL SHALL COMPLY WITH AASHTO T-99 (100%).

UTILITIES

- ALL CONSTRUCTION IS TO BE STAKED IN THE FIELD BY OR UNDER THE SUPERVISION OF A FLORIDA REGISTERED LAND SURVEYOR. RECORD DRAWINGS SHALL BE PROVIDED BY THE SURVEYOR.
- CONTRACTOR IS TO COORDINATE ALL WORK WITH UTILITY COMPANIES IN ORDER TO PREVENT DAMAGE TO UTILITY LINES AND THE MAKING OF ADJUSTMENTS TO SAME, IF REQUIRED. THE CONTRACTOR SHALL PROVIDE AT LEAST 48 HOURS NOTICE TO THE VARIOUS UTILITY OWNERS PRIOR TO CONSTRUCTION.

PAVING & GRADING

- PROPOSED SPOT ELEVATIONS REPRESENT FINISHED SIDEWALK, PAVEMENT, SLAB, STRUCTURE TOP, OR GROUND SURFACE GRADE UNLESS OTHERWISE NOTED ON DRAWINGS.
- CONTRACTOR SHALL TRIM, TACK AND MATCH EXISTING PAVEMENT AT LOCATIONS WHERE NEW PAVEMENT MEETS EXISTING PAVEMENT.
- CURBING WILL BE PLACED IN LOCATIONS SHOWN ON THE PLANS TO THE DIMENSIONS AND SPECIFICATIONS SHOWN ON THE DETAILS PROVIDED. LOCAL REGULATORY REQUIREMENTS, OR PER FDOT DESIGN STANDARDS. CONTRACTOR TO VERIFY LOCATIONS AND DIMENSIONS WITH THE ENGINEER OF RECORD (EOR) PRIOR TO POURING CONCRETE.
- CONTRACTOR TO PROVIDE A 1/2" TO 1" BITUMINOUS EXPANSION JOINT MATERIAL WITH SEALER AT ABUTMENT OF CONCRETE AND OTHER MATERIALS (BUILDINGS, OTHER POURED CONCRETE, ETC.), UNLESS OTHERWISE NOTED ON DRAWINGS.
- ALL PAVEMENT MARKINGS SHALL BE MADE WITH PERMANENT, LEAD FREE MATERIAL. THERMOPLASTIC PER FDOT SPECIFICATIONS AT DRIVEWAY INTERSECTIONS AND IN RIGHTS-OF-WAY. PROVIDE PAVEMENT MARKINGS AS SHOWN PER FDOT INDEX NO. 17346.
- ALL PEDESTRIAN ROUTES, SIDEWALKS AND RAMPS, AS WELL AS ALL HANDICAPPED SIGNS, SYMBOLS, PARKING SPACES, ETC. SHALL BE CONSTRUCTED IN STRICT ACCORDANCE WITH LOCAL, STATE AND FEDERAL ADA REQUIREMENTS WHETHER OR NOT SHOWN HEREON. CONTRACTOR SHALL VERIFY REQUIREMENTS WITH LOCAL INSPECTORS PRIOR TO POURING SIDEWALKS AND RAMPS.

SIDEWALK NOTES

- REFER TO PAVING, GRADING AND DRAINAGE DETAIL SHEETS FOR DETAILS AND SPECIFICATIONS.
- REFER TO PERMEABLE PAVER SIDEWALK DETAIL AND TYPICAL SECTION FOR CONSTRUCTION DETAILS.

SIGNAGE

- PROVIDE TRAFFIC SIGNAGE SHOWN PER THE MANUAL ON UNIFORM TRAFFIC CONTROL DEVICES (MUTCD), LATEST EDITION, UNLESS OTHERWISE SHOWN. INSTALL TRAFFIC SIGNAGE PER FDOT INDEX #17392. SEE ARCHITECTURAL PLANS FOR ADDITIONAL SIGNAGE REQUIREMENTS, AS APPLICABLE.
- INSTALL SIGNAGE SO THAT THE BOTTOM EDGE OF THE BOTTOM SIGN IS AT LEAST 7'-0" ABOVE FINISHED GRADE AT THE SIGN POST, THE ADJACENT EDGE OF PAVEMENT (E.O.P.) OR THE ADJACENT TOP OF CURB, WHICHEVER IS GREATER. SIGNS POSTS TO BE 11' LONG.
- INSTALL SIGNAGE SO THAT THE VERTICAL EDGE OF THE SIGN CLOSEST TO THE ROAD IS AT LEAST 2' HORIZONTALLY FROM THE ADJACENT E.O.P.

HISTORICAL PRESERVATION NOTE

IF DURING CONSTRUCTION ACTIVITIES, ANY EVIDENCE OF HISTORIC RESOURCES, INCLUDING BUT NOT LIMITED TO ABORIGINAL OR HISTORIC POTTERY, PREHISTORIC STONE TOOLS, BONE OR SHELL TOOLS, HISTORIC TRASH PITS, OR HISTORIC POTTERY, FOUNDATION, ARE DISCOVERED, WORK SHALL COME TO AN IMMEDIATE STOP AND THE FLORIDA DEPARTMENT OF HISTORIC RESOURCES (STATE HISTORIC PRESERVATION OFFICER) AND THE LOCAL REGULATORY AGENCY SHALL BE NOTIFIED WITHIN TWO WORKING DAYS OF THE RESOURCES BEING FOUND ON THE SITE.

PROTECTED PLANT/ANIMAL NOTE

IF DURING CONSTRUCTION ACTIVITIES, ANY EVIDENCE OF THE PRESENCE OF STATE AND/OR FEDERALLY PROTECTED PLANT AND/OR ANIMAL SPECIES ARE DISCOVERED, WORK SHALL COME TO AN IMMEDIATE STOP AND THE FLORIDA FISH AND WILDLIFE CONSERVATION COMMISSION (FWC) AND THE LOCAL REGULATORY AGENCY SHALL BE NOTIFIED WITHIN TWO WORKING DAYS OF THE PLANT AND/OR ANIMAL SPECIES BEING FOUND ON THE SITE.

NATIONAL POLLUTANT DISCHARGE ELIMINATION SYSTEM (NPDES)

THE CONTRACTOR ACKNOWLEDGES THE REQUIREMENT OF THE STATE OF FLORIDA DEPARTMENT OF ENVIRONMENTAL PROTECTION (FDEP), WHICH HAS PUBLISHED RULES FOR OBTAINING COVERAGE UNDER THE STATE OF FLORIDA DEPARTMENT OF ENVIRONMENTAL PROTECTION GENERIC PERMIT FOR STORMWATER DISCHARGES FROM LARGE AND SMALL CONSTRUCTION ACTIVITIES.

IN OCTOBER 2000, EPA AUTHORIZED THE FLORIDA DEPARTMENT OF ENVIRONMENTAL PROTECTION (DEP) TO IMPLEMENT THE NPDES STORMWATER PERMITTING PROGRAM IN THE STATE OF FLORIDA (IN ALL AREAS EXCEPT INDIAN COUNTRY LANDS). DEPS AUTHORITY TO ADMINISTER THE NPDES PROGRAM IS SET FORTH IN SECTION 403.0885, FLORIDA STATUTES (F.S.). THE NPDES STORMWATER PROGRAM REGULATES POINT SOURCE DISCHARGES OF STORMWATER INTO SURFACE WATERS OF THE STATE OF FLORIDA FROM CERTAIN MUNICIPAL, INDUSTRIAL AND CONSTRUCTION ACTIVITIES. AS THE NPDES STORMWATER PERMITTING AUTHORITY, DEP IS RESPONSIBLE FOR PROMULGATING RULES AND ISSUING PERMITS, MANAGING AND REVIEWING PERMIT APPLICATIONS, AND PERFORMING COMPLIANCE AND ENFORCEMENT ACTIVITIES.

THE CONTRACTOR AGREES TO ASSIST THE OWNER IN THE PREPARATION, AND IMPLEMENTATION, OF A STORMWATER POLLUTION PREVENTION PLAN (SWPPP). THE EPA HAS PUBLISHED SUMMARY GUIDANCE FOR: "DEVELOPING POLLUTION PREVENTION PLANS AND BEST MANAGEMENT PRACTICES" (EPA 832-R-92-005, SEPTEMBER 1992).

RECORD DRAWING REQUIREMENTS

THE CONTRACTOR SHALL SUBMIT A CERTIFIED SET OF RECORD DRAWINGS TO THE ENGINEER. THE CONTRACTOR SHALL BE RESPONSIBLE FOR RECORDING INFORMATION ON THE APPROVED PLANS CONCURRENTLY WITH CONSTRUCTION PROGRESS. RECORD DRAWINGS SUBMITTED TO THE ENGINEER AS PART OF THE PROJECT ACCEPTANCE SHALL COMPLY WITH THE FOLLOWING REQUIREMENTS:

- IF CONSTRUCTION STAKEOUT IS PROVIDED BY THE OWNER, THE CONTRACTOR SHALL ACCURATELY RECORD THE LOCATION OF ALL WORK THAT MAY SUBSEQUENTLY BECOME CONCEALED OR INACCESSIBLE, AS WELL AS MARK OR EXPOSE UNDERGROUND FACILITIES AS NECESSARY TO FACILITATE THE PREPARATION OF THE RECORD DRAWINGS BY THE OWNER, AND PROVIDE SAID INFORMATION TO THE OWNER.
- DRAWINGS SHALL BE LEGIBLY MARKED TO RECORD ACTUAL CONSTRUCTION.
- DRAWINGS SHALL CLEARLY SHOW ALL FIELD CHANGES OF DIMENSION AND DETAIL INCLUDING CHANGES MADE BY FIELD ORDER OR BY CHANGE ORDER. DRAWINGS SHALL CLEARLY SHOW ALL DETAILS NOT ON THE ORIGINAL CONTRACT DRAWINGS, BUT CONSTRUCTED IN THE FIELD. ALL EQUIPMENT AND PIPING RELOCATION SHALL BE CLEARLY SHOWN.
- EACH SHEET OF THE PLANS SHALL BE SIGNED, SEALED AND DATED BY A REGISTERED SURVEYOR WITH A NOTE READING "THESE AS-BUILTS DRAWINGS ACCURATELY DEPICT THE ACTUAL IMPROVEMENTS AS CONSTRUCTED".

NO.	BY	DATE	DESCRIPTION

NO.	BY	DATE	DESCRIPTION	INITIALS	DATE

PREPARED FOR:
CITY OF ANNA MARIA
1005 GULF DRIVE
ANNA MARIA, FL 34216

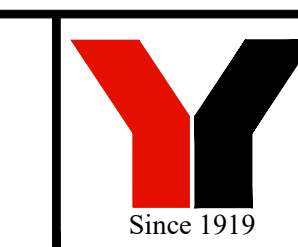

George F. Young, Inc.
1054 PORTAL CROSSING, SUITE 105 LAKEWOOD RANCH, FLORIDA 34211-4913
PHONE (941) 747-2981 FAX (941) 747-7234 WWW.GEORGEF.YOUNG.COM
ENGINEERING CERTIFICATE OF AUTHORIZATION NUMBER 21
CIVIL & TRANSPORTATION ENGINEERING ECOLOGY GIS LANDSCAPE ARCHITECTURE
PLANNING SURVEYING SUBSURFACE UTILITY ENGINEERING
GAINESVILLE LAKEWOOD RANCH ORLANDO ST. PETERSBURG TAMPA

JUAN CARLOS CONTRON, PE No. 66298
DATE

PINE AVE. SIDEWALK & CROSSWALK DESIGN
GENERAL NOTES
SECTION 18, TOWNSHIP 34 S., RANGE 16 E.

JOB NO.
22000100LC
SHEET NO.
C2

NOTES:

1. CONTRACTOR TO EXERCISE CAUTION AND PROTECT EXISTING HARDSCAPE AND LANDSCAPE WHILE REMOVING AND REPLACING THE SIDEWALK AT THE RIGHT OF WAY LINE.
2. THE INTENT OF SIDEWALK PROFILE LINES IS TO PLOT THE EXISTING GROUND PROFILE ALONG THE BACK OF THE PROPOSED SIDEWALK/ROW AND PINE AVE CENTERLINE.
3. CENTERLINE ROADWAY ALIGNMENT BEGINS AT NORTHING: 1161138.3780 EASTING: 417165.5282

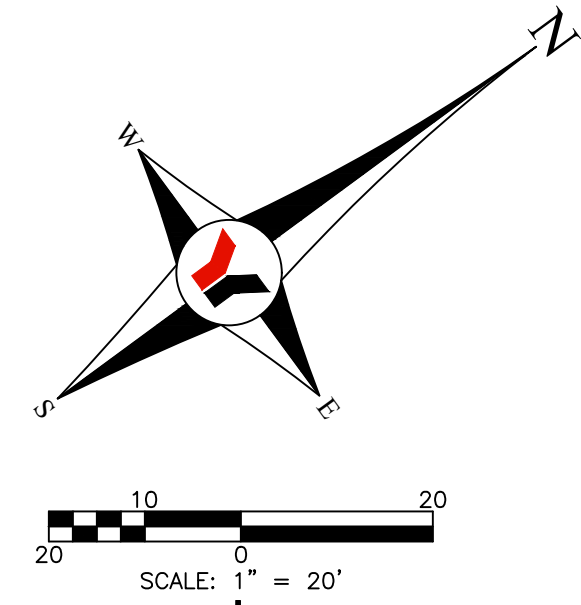

ANNA MARIA
ISLAND BEACH

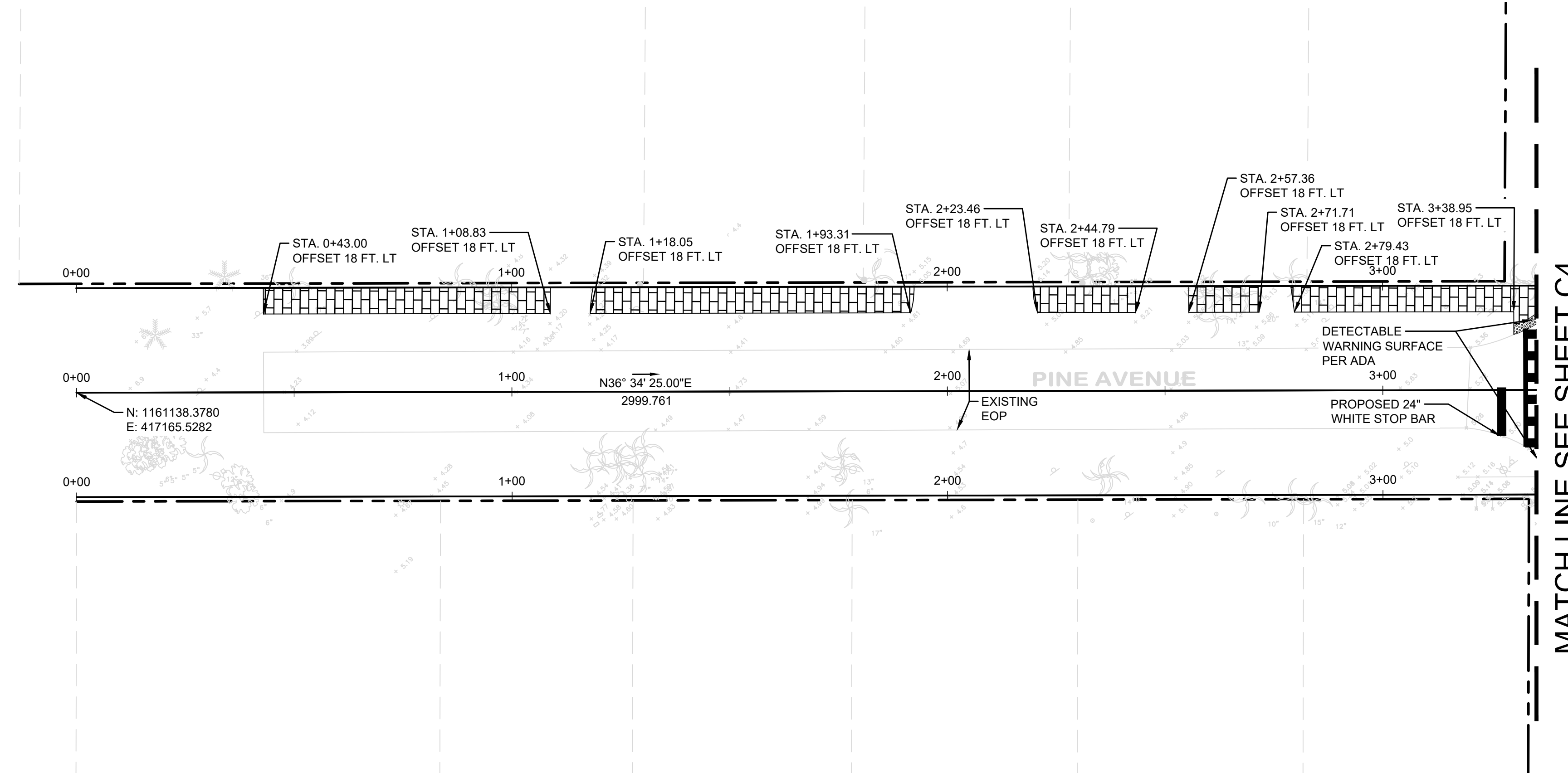

MATCH LINE SEE SHEET C4

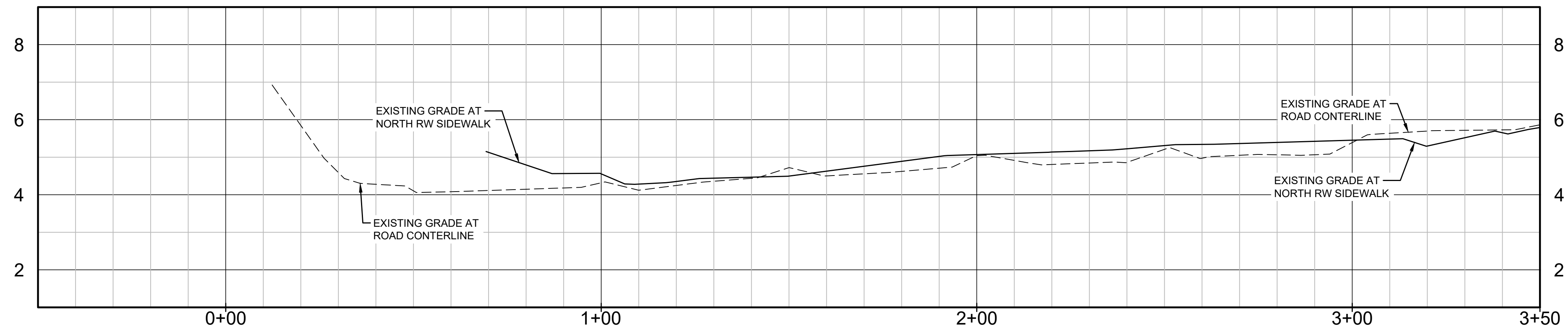

PINE AVE E CL PROFILE
(STA 0+00 - STA 3+50)

SCALE: 1" = 20' HORZ.
1" = 2' VERT.

NO.	BY	DATE	DESCRIPTION

NO.	BY	DATE	DESCRIPTION

DESIGN	INITIALS	DATE
CONTRON	JCC	01/14/22
CHECKED		
QUALITY CHK		
SCALE		

PREPARED FOR:
CITY OF ANNA MARIA
10005 GULF DRIVE
ANNA MARIA, FL 34216
(941) 708-6130



George F. Young, Inc.
10540 PORTAL CROSSING, SUITE 105 LAKEWOOD RANCH, FLORIDA 34211-4913
PHONE (941) 747-2981 FAX (941) 747-7234 WWW.GEORGEYOUNG.COM
ENGINEERING CERTIFICATE OF AUTHORIZATION NUMBER 21
CIVIL & TRANSPORTATION ENGINEERING | ECOCLOGY | GIS | LANDSCAPE ARCHITECTURE
PLANNING | SURVEYING | SUBSURFACE UTILITY ENGINEERING
GAINESVILLE • LAKEWOOD RANCH • ORLANDO • ST. PETERSBURG • TAMPA

JUAN CARLOS CONTRON, PE No. 66298
DATE

PINE AVE. SIDEWALK & CROSSWALK DESIGN
PLAN AND PROFILE
SECTION 18, TOWNSHIP 34 S., RANGE 16 E.

JOB NO.
22000100LC
SHEET NO.
C3

FILE: I:\PROJECTS\1807\2022\22000100LC\Plan\Profile\Phase 1A - Civil - D1 - North Side.dwg - Monday, 1/24/2023 10:02:40 AM

NOTES:

1. CONTRACTOR TO EXERCISE CAUTION AND PROTECT EXISTING HARDSCAPE AND LANDSCAPE WHILE REMOVING AND REPLACING THE SIDEWALK AT THE RIGHT OF WAY LINE.
2. THE INTENT OF SIDEWALK PROFILE LINES IS TO PLOT THE EXISTING GROUND PROFILE ALONG THE BACK OF THE PROPOSED SIDEWALK/ROW AND PINE AVE CENTERLINE.
3. CENTERLINE ROADWAY ALIGNMENT BEGINS AT NORTHING: 1161138.3780 EASTING: 417165.5282

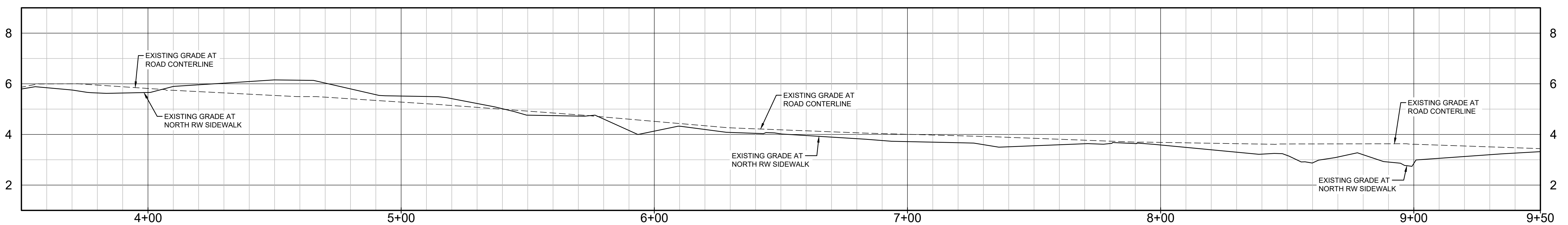
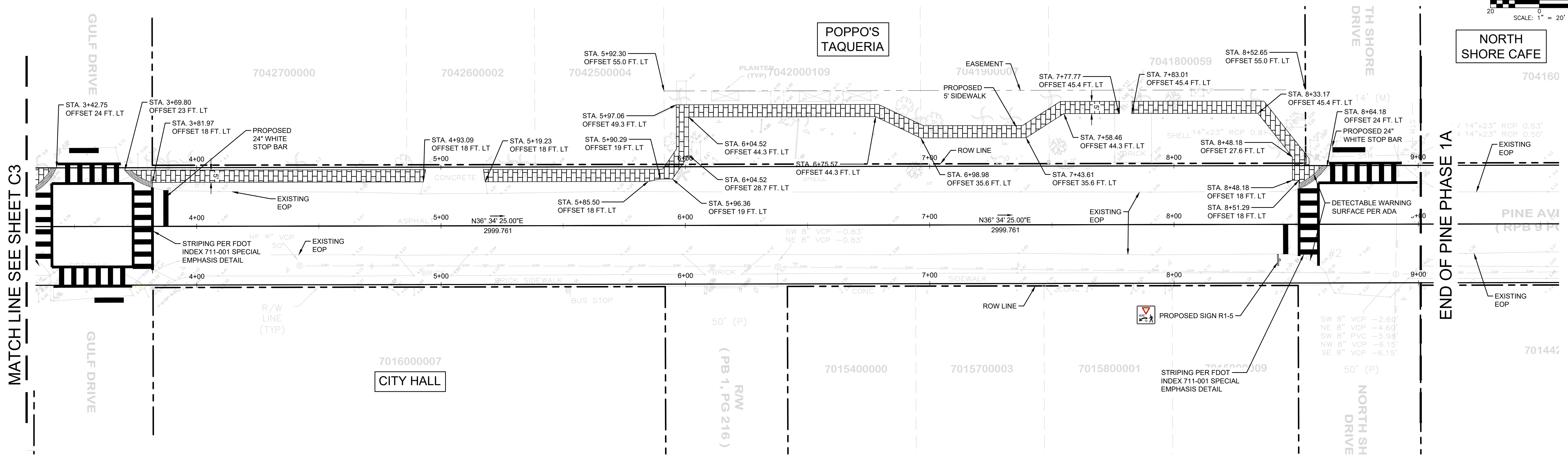
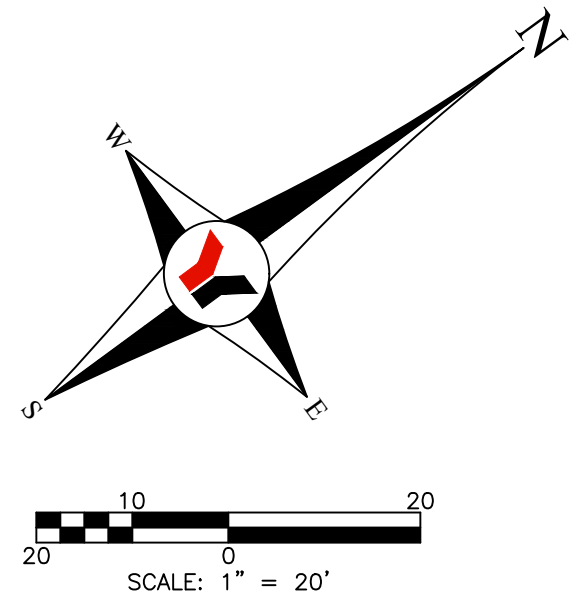

**PINE AVE E CL PROFILE
(STA 3+50 - STA 9+50)**

SCALE: 1" = 20' HORIZ.
1" = 2' VERT.

NO.	BY	DATE	DESCRIPTION

NO.	BY	DATE	DESCRIPTION

INITIALS	DATE
DESIGN	01/14/22
DRAWN	JCC
CHECKED	
QUALITY CHK	
SCALE	

PREPARED FOR:
CITY OF ANNA MARIA
10005 GULF DRIVE
ANNA MARIA, FL 34216
(941) 708-6130



George F. Young, Inc.
10540 PORTAL CROSSING, SUITE 105 LAKEWOOD RANCH, FLORIDA 34211-4913
PHONE (941) 747-2981 FAX (941) 747-7234 WWW.GEORGEYOUNG.COM
ENGINEERING CERTIFICATE OF AUTHORIZATION NUMBER 21
CIVIL & TRANSPORTATION ENGINEERING | ECOSYSTEMS | LANDSCAPE ARCHITECTURE
PLANNING | SURVEYING | SUBSURFACE UTILITY ENGINEERING
GAINESVILLE • LAKEWOOD RANCH • ORLANDO • ST. PETERSBURG • TAMPA

JUAN CARLOS CONTRON, PE No. 66298
DATE

PINE AVE. SIDEWALK & CROSSWALK DESIGN
PLAN AND PROFILE
SECTION 18, TOWNSHIP 34 S., RANGE 16 E.

JOB NO. 22000100LC
SHEET NO. C4

FILE: I:\PROJECTS\2022\22000100LC\Pine\Plan\Phase 1A - Gulf Dr. to North Shore Dr. - Monday, 12/20/22 10:00:00 AM
 L0006 - Resubmittal - 20220808

NOTE:

PGL SHOULD MATCH THE EXISTING GRADE AS MUCH AS POSSIBLE AS LONG AS IT MEETS ADA STANDARDS FOR LONGITUDINAL SLOPE
MINOR GRADING WILL BE REQUIRED AT SOME LOCATIONS TO MEET ADA STANDARDS

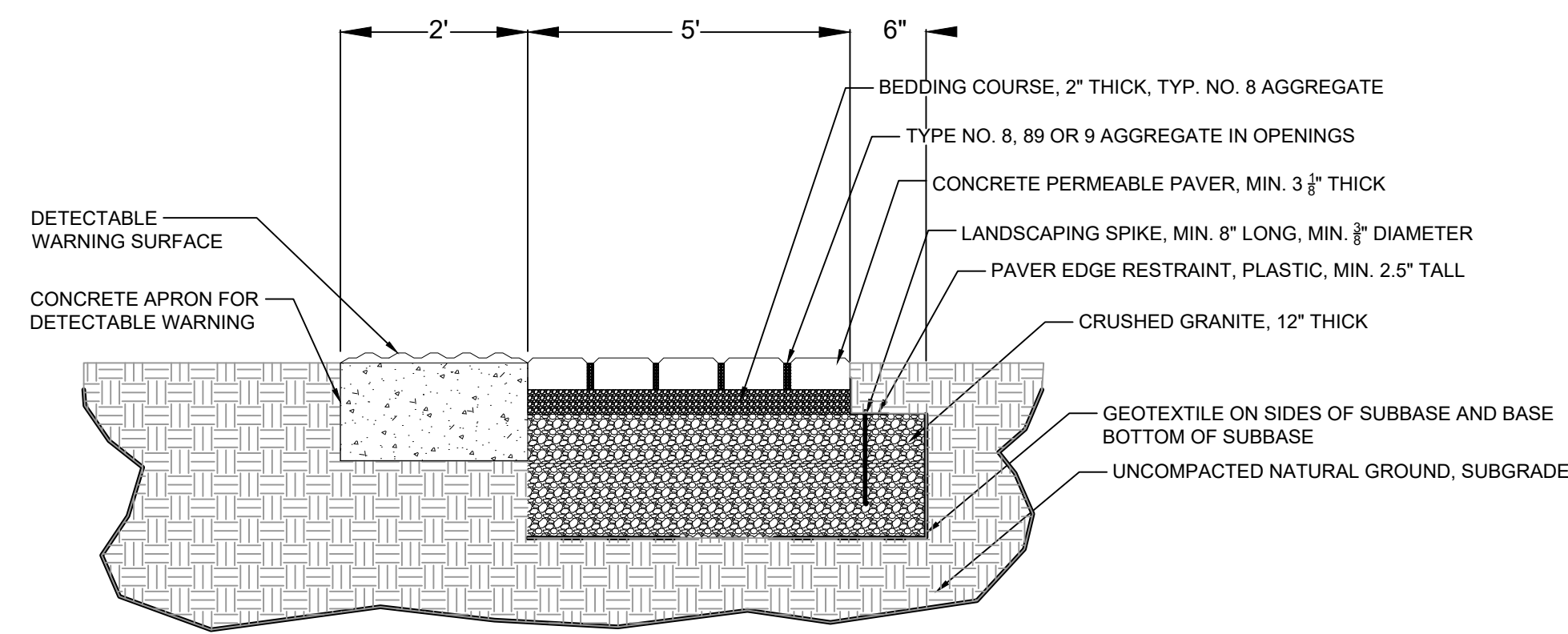

**ADA DETECTABLE SURFACE
CONCRETE APRON (SECTION VIEW)**
N.T.S.

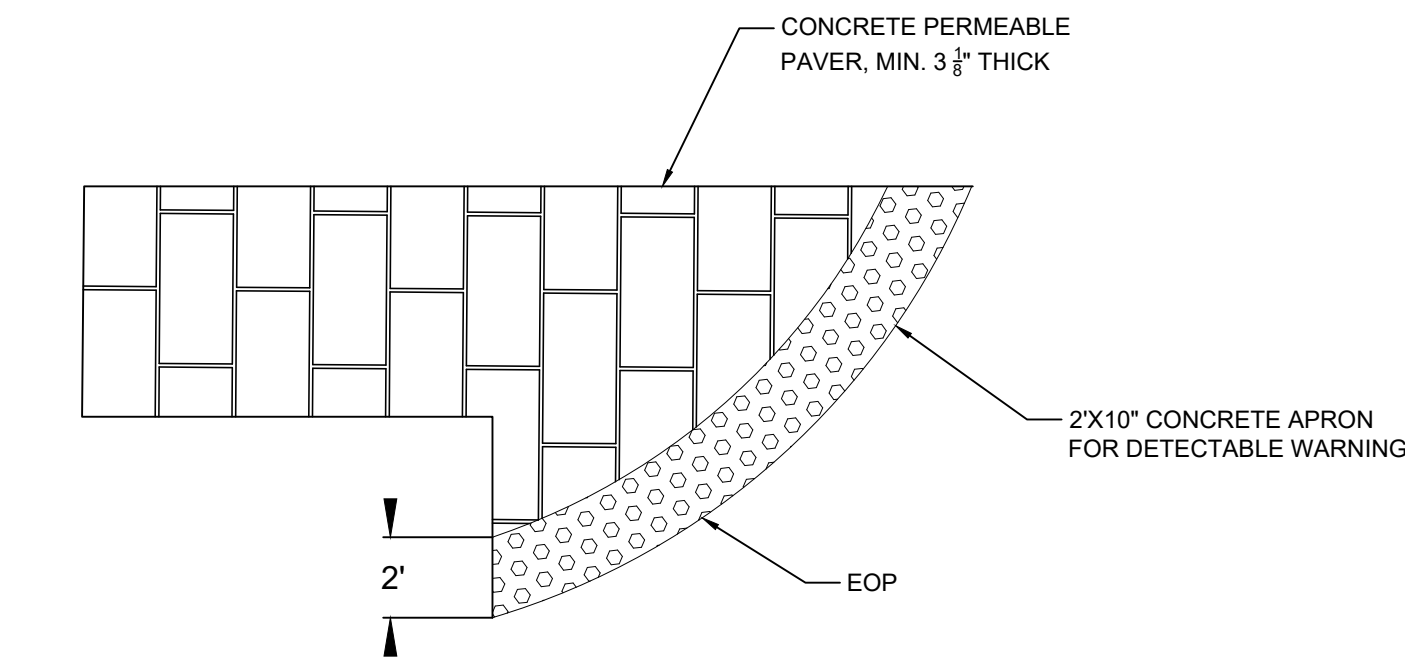

**ADA DETECTABLE SURFACE
CONCRETE APRON (PLAN VIEW)**
N.T.S.

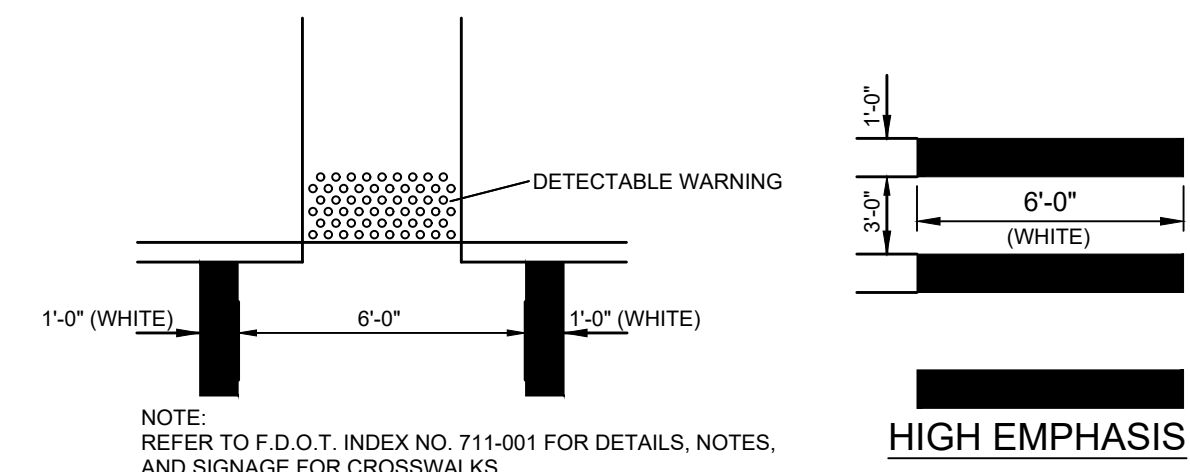

CROSSWALK DETAIL
N.T.S.

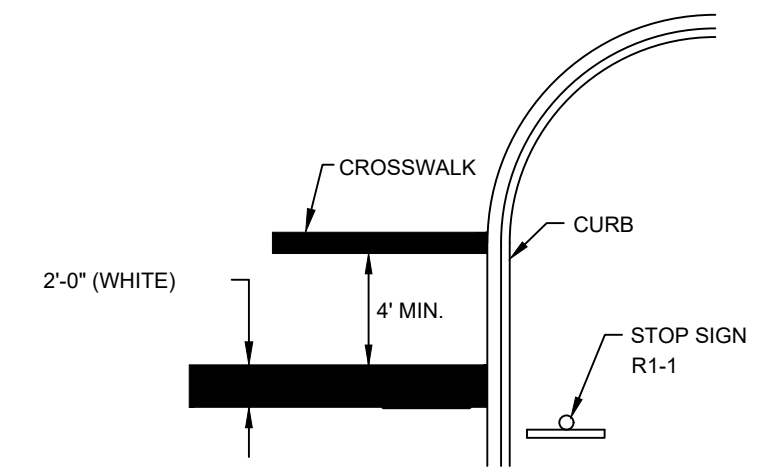

STOP BAR DETAIL
N.T.S.

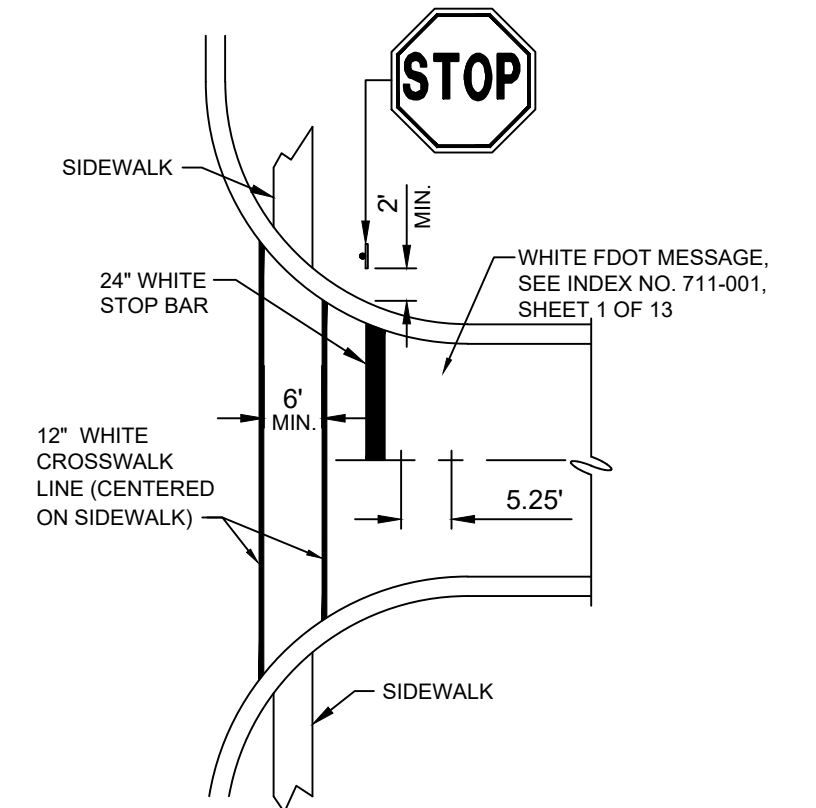

**STOP SIGN AND
CROSSWALK LOCATION DETAIL**
N.T.S.

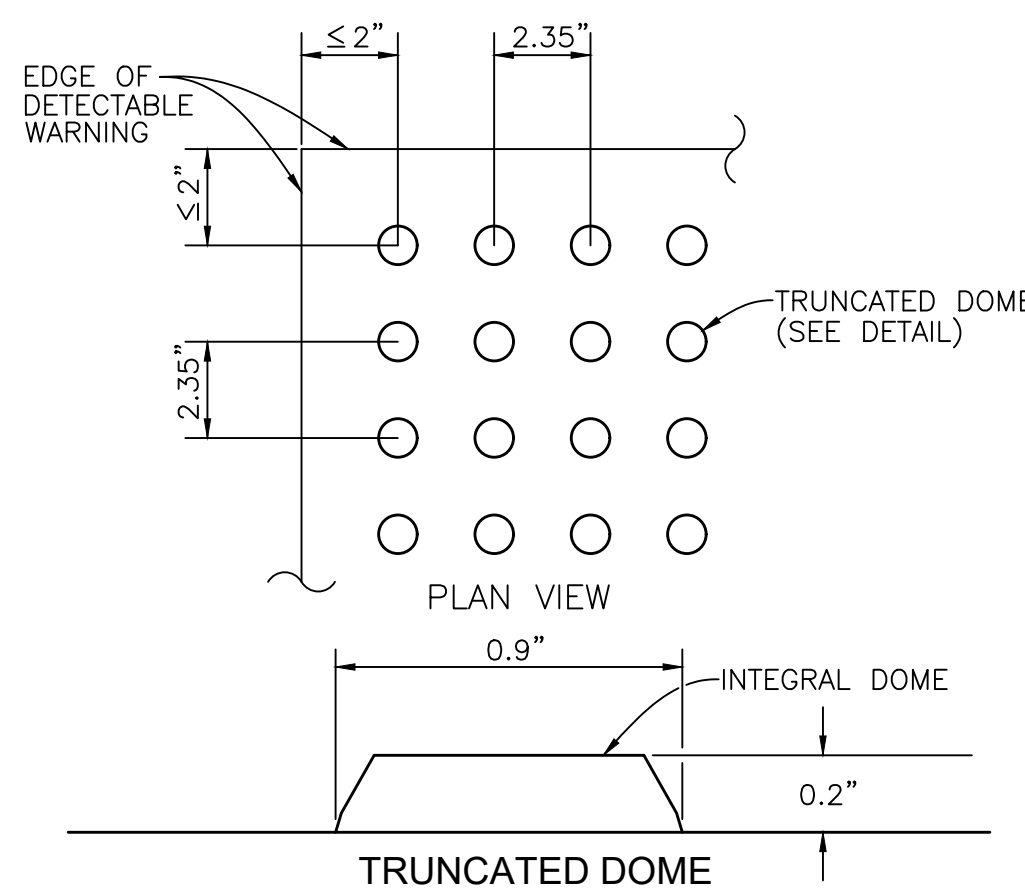

CURB RAMP DETECTABLE WARNING DETAIL

NOTES:

DETECTABLE WARNINGS ON WALKING SURFACES

THE DETECTABLE WARNING SHALL EXTEND THE FULL WIDTH AND DEPTH OF THE CURB RAMP.

DETECTABLE WARNINGS SHALL CONSIST OF RAISED TRUNCATED DOMES WITH A DIAMETER OF NOMINAL 0.9 INCH, A HEIGHT OF NOMINAL 0.2 INCH AND A CENTER-TO-CENTER SPACING OF NOMINAL 2.35 INCH AND SHALL CONTRAST VISUALLY WITH ADJOINING SURFACES, EITHER LIGHT-ON-DARK, OR DARK-ON-LIGHT.

THE MATERIAL USED TO PROVIDE CONTRAST SHALL BE AN INTEGRAL PART OF THE WALKING SURFACE. DETECTABLE WARNINGS USED ON INTERIOR SURFACES SHALL DIFFER FROM ADJOINING WALKING SURFACES IN RESILIENCY OR SOUND-ON-GAME CONTACT.

THE MATERIAL USED TO PROVIDE CONTRAST SHOULD CONTRAST BY AT LEAST 70% CONTRAST IN PERCENT IS DETERMINED BY:

$$\text{CONTRAST} = \frac{[(B1-B2)/B1] \times 100}{1}$$

WHERE B1 = LIGHT REFLECTANCE VALUE (LRV) OF THE LIGHTER AREA AND B2 = LIGHT REFLECTANCE VALUE (LRV) OF THE DARKER AREA.

NOTE THAT IN ANY APPLICATION BOTH WHITE AND BLACK ARE NEVER ABSOLUTE; THUS, B1 NEVER EQUALS 100 AND B2 IS ALWAYS GREATER THAN 0.

DETECTABLE WARNINGS DETAIL
N.T.S.

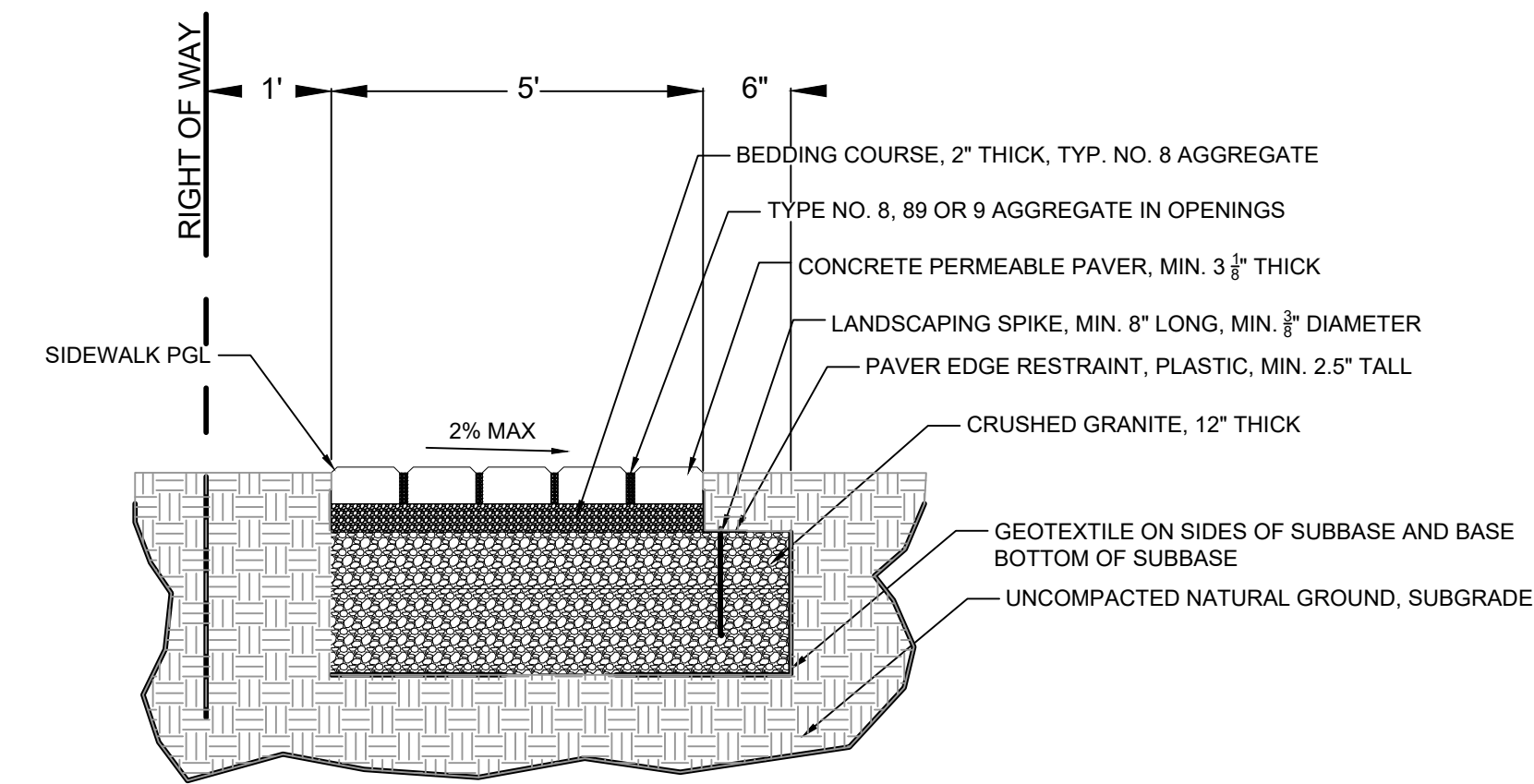

**5 FT PERMEABLE
PAVER SIDEWALK
(BID ALTERNATE #1)**
N.T.S.

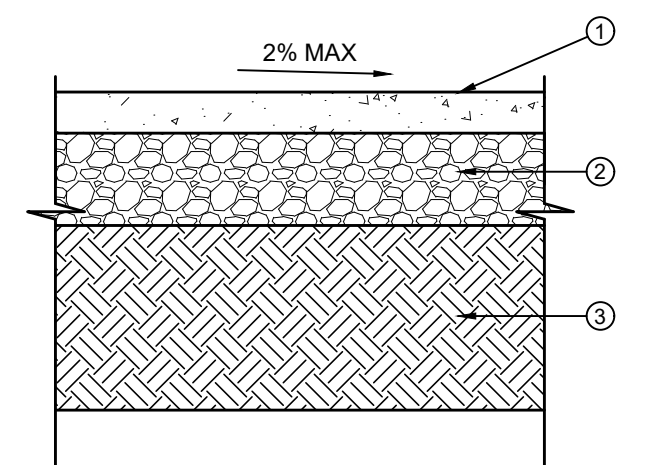

**FLEXIBLE POROUS PAVEMENT
SECTION (BID ALTERNATE #2)**
N.T.S.

- ① 2" FLEXIBLE POROUS PAVEMENT (LIGHT VEHICULAR)
- ② MINIMUM 4" OF CRUSHED GRANITE (FOR POROUS APPLICATIONS)
- ③ SUBGRADE: TYPE "B" STABILIZED SUBGRADE 98% DENSITY MINIMUM LBR 40

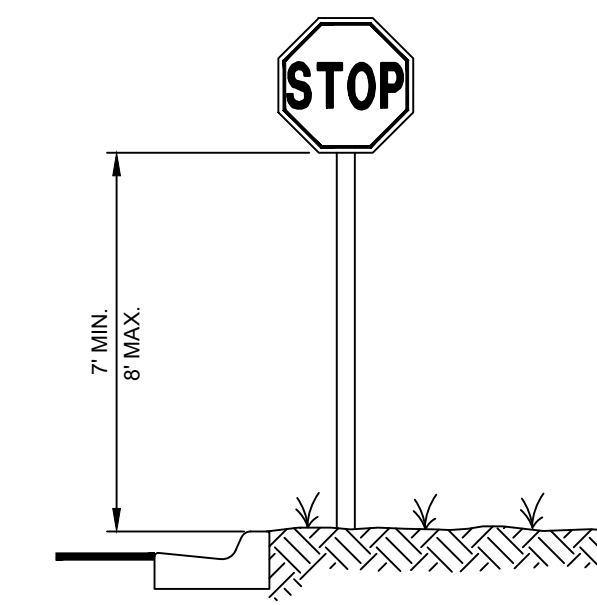

TYPICAL STOP SIGN DETAIL
N.T.S.

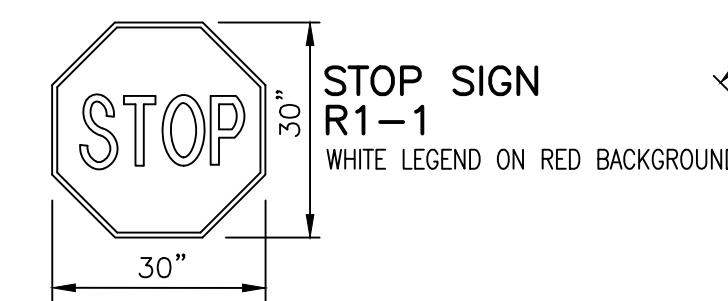

**STOP SIGN
R1-1**
WHITE LEGEND ON RED BACKGROUND

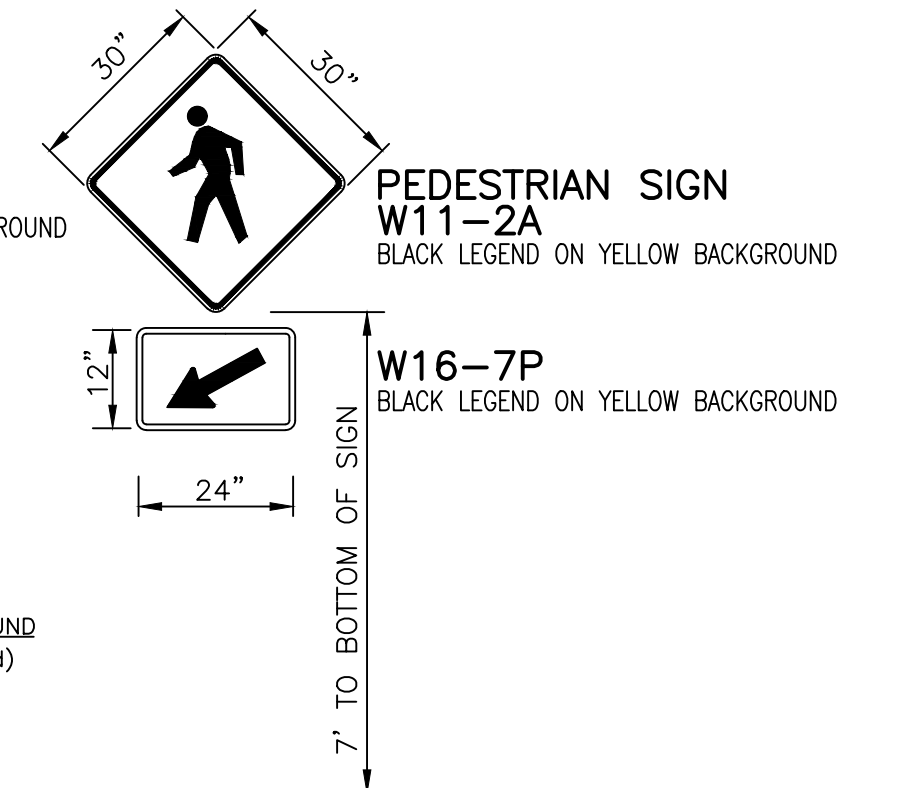

**PEDESTRIAN SIGN
W11-2A**
BLACK LEGEND ON YELLOW BACKGROUND

W16-7P
BLACK LEGEND ON YELLOW BACKGROUND

COLOR CODES
LEGEND (and/or) SYMBOL/BACKGROUND
B.....Black.....(Non-ReflectORIZED)
W.....White.....(ReflectORIZED)
R.....Red.....(ReflectORIZED)

SIGNAGE DETAILS
N.T.S.

NO.	BY	DATE	DESCRIPTION

NO.	BY	DATE	DESCRIPTION

DESIGN	INITIALS	DATE
CONTRON	JCC	01/14/22
DRAWN	JCC	01/14/22
CHECKED		
QUALITY CHK		
SCALE		

PREPARED FOR:
CITY OF ANNA MARIA
10005 GULF DRIVE
ANNA MARIA, FL 34216
(941) 708-6130



George F. Young, Inc.
10540 PORTAL CROSSING, SUITE 105 LAKEWOOD RANCH, FLORIDA 34211-4913
PHONE (941) 747-2981 FAX (941) 747-7234 WWW.GEORGEFYOUNG.COM
ENGINEERING CERTIFICATE OF AUTHORIZATION NUMBER 21
CIVIL & TRANSPORTATION ENGINEERING/ECOLOGICAL/IS/LANDSCAPE ARCHITECTURE
PLANNING/SURVEYING/SUBSURFACE UTILITY ENGINEERING
GAINESVILLE • LAKEWOOD RANCH • ORLANDO • ST. PETERSBURG • TAMPA

JUAN CARLOS CONTRON, PE No. 66298
DATE

PINE AVE. SIDEWALK & CROSSWALK DESIGN
DETAILS
SECTION 18, TOWNSHIP 34 S., RANGE 16 E.

JOB NO.
22000100LC
SHEET NO.
C5