

LEGEND:

- "G" BARRICADE
- "G" SIGN POST
- BARRICADE
- TRAFFIC DETOUR

NOTES:
 1. APPROXIMATE DURATION FOR PHASE 1 IS 4 WEEKS.

TRAFFIC CONTROL PLAN 1

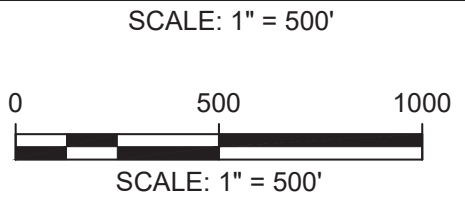

SIGNS FOR TRAFFIC CONTROL PLAN 1 (PAYMENT INCLUDED UNDER ITEM 20B)				
SIGN		NUMBER OF SIGNS REQUIRED	SIZE	SF
"A"	W20-2	3	48" X 48"	48
"B"	W20-3	0	48" X 48"	0
"C"	R11-3	4	60" X 30"	50
"D"	R11-4	3	60" X 30"	37.5
"E"	M4-10R (RIGHT)	1	48" X 18"	6
"F"	M4-10L (LEFT)	1	48" X 18"	6
"G"	M4-9X	4	30" X 24"	20
"H"	M4-9R (RIGHT)	6	30" X 24"	30
"I"	M4-9L (LEFT)	5	30" X 24"	25
"J"	M4-8A	2	30" X 24"	10
"K"	SPECIAL	21	48" X 18"	126
TOTAL SF:				358.5

EASTON TURNPIKE
 "K"
 SPECIAL
 48" X 18"

"A" W20-2 48" x 48"	"B" W20-3 48" x 48"
"C" R11-3 60" x 30"	"D" R11-4 60" x 30"
"E" M4-10R (RIGHT) 48" x 18"	"F" M4-10L (LEFT) 48" x 18"
"G" M4-9S 30" x 24"	"H" M4-9R (RIGHT) 30" x 24"
"I" M4-9L (LEFT) 30" x 24"	"J" M4-8A 30" x 24"

© Mott MacDonald
 This document is issued for the party which commissioned it and for specific purposes connected with the captioned project only. It should not be relied upon by any other party or used for any other purpose. We accept no responsibility for the consequences of this document being relied upon by any other party, or being used for any other purpose, or containing any error or omission which is due to an error or omission in data supplied to us by other parties.

FINAL FOR SEWER DESIGN

M M
MOTT MACDONALD

111 Wood Avenue South
 Iselin NJ 08830-4112
 United States of America
 Certificate No. 24GA28016600

T +1 (800) 832 3272
 F +1 (973) 376 1072
 www.mottmacamericas.com

Client		TOWNSHIP OF BRANCHBURG SOMERSET COUNTY BRANCHBURG, NJ			
4	01/31/2023	ESS	ISSUED FOR CONSTRUCTION	DLK	DLK
3	12/16/2022	ESS	TRAFFIC REVISIONS PER COUNTY COMMENTS	DLK	DLK
2	10/12/2022	ESS	SESC CERTIFICATION SUBMISSION	DLK	DLK
1	09/12/2022	ESS	TWA PERMIT SUBMISSION	DLK	DLK
Rev	Date	Drawn	Description	Ch'k'd	App'd

DAVID L. KLEMM
 NJ PROFESSIONAL ENGINEER LIC. No. 38672

D. Klemm Date **1/31/23**

Project Number	B/O	Total
507103994	13	18

Designed	ESS	Eng check	DLK
Drawn	ESS	Coordination	MJC
Dwg check	DLK	Approved	DLK
Scale at ANSI D	Status	Rev	Security
As Shown	BID	Rev4	STD
Drawing Number	TC-001		

Title
**METER CHAMBER 13B SANITARY
 SEWER COLLECTION SYSTEM
 UPGRADES
 TRAFFIC DETOUR PLAN 1 OF 3**

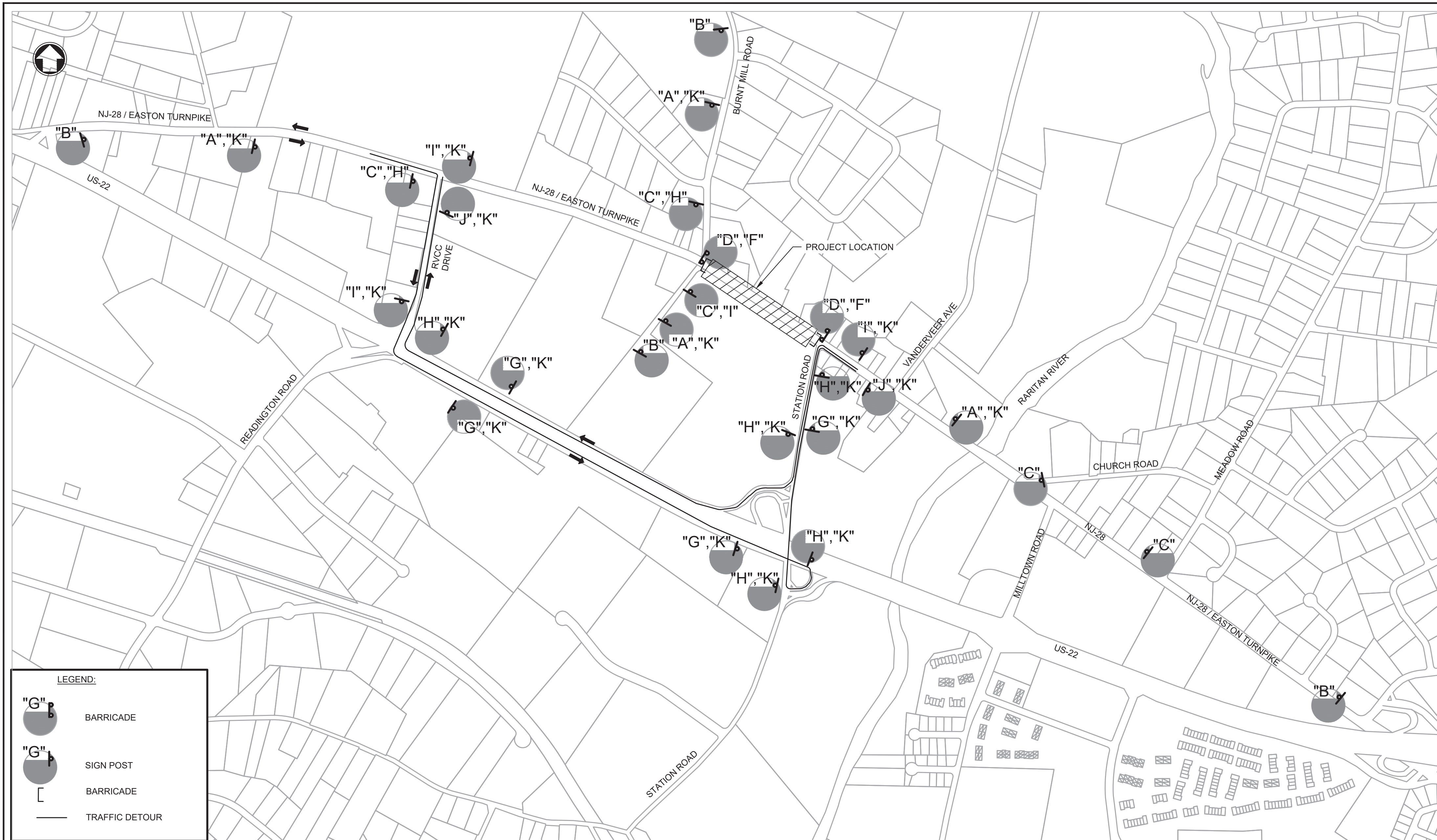

LEGEND:

- "G" BARRICADE
- "G" SIGN POST
- "G" BARRICADE
- TRAFFIC DETOUR

NOTES:
 1. APPROXIMATE DURATION FOR PHASE 2 IS 4 WEEKS.

TRAFFIC CONTROL PLAN 2

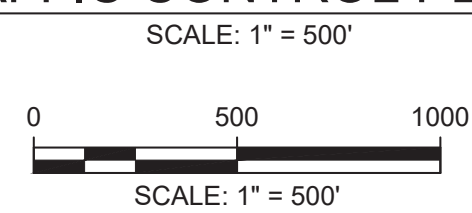

SIGNS FOR TRAFFIC CONTROL PLAN 2 (PAYMENT INCLUDED UNDER ITEM 20B)				
SIGN		NUMBER OF SIGNS REQUIRED	SF	
"A"	W20-2	4	48" X 48"	64
"B"	W20-3	4	48" X 48"	64
"C"	R11-3	5	60" X 30"	62.5
"D"	R11-4	2	60" X 30"	25
"E"	M4-10R (RIGHT)	0	48" X 18"	0
"F"	M4-10R (LEFT)	2	48" X 18"	12
"G"	M4-9X	4	30" X 24"	20
"H"	M4-9R (RIGHT)	7	30" X 24"	35
"I"	M4-9L (LEFT)	4	30" X 24"	20
"J"	M4-8A	2	30" X 24"	10
"K"	SPECIAL	18	48" X 18"	108
			TOTAL SF:	420.5

EASTON TURNPIKE

"K"
SPECIAL
48" X 18"

FINAL FOR SEWER DESIGN

"A"	"B"
W20-2 48" x 48"	W20-3 48" x 48"
"C"	"D"
R11-3 60" x 30"	R11-4 60" x 30"
"E"	"F"
M4-10R (RIGHT) 48" x 18"	M4-10R (LEFT) 48" x 18"
"G"	"H"
M4-9S 30" x 24"	M4-9R (RIGHT) 30" x 24"
"I"	"J"
M4-9L (LEFT) 30" x 24"	M4-8A 30" x 24"

© Mott MacDonald
 This document is issued for the party which commissioned it and for specific purposes connected with the captioned project only. It should not be relied upon by any other party or used for any other purpose. We accept no responsibility for the consequences of this document being relied upon by any other party, or being used for any other purpose, or containing any error or omission which is due to an error or omission in data supplied to us by other parties.

<p>111 Wood Avenue South Iselin NJ 08830-4112 United States of America Certificate No. 24GA28016600</p> <p>T +1 (800) 832 3272 F +1 (973) 376 1072 www.mottmacamericas.com</p>	<p>Client</p> <p>TOWNSHIP OF BRANCHBURG SOMERSET COUNTY BRANCHBURG, NJ</p>	<table border="1"> <tr> <th>Rev</th> <th>Date</th> <th>Drawn</th> <th>Description</th> <th>Ch'k'd</th> <th>App'd</th> </tr> <tr> <td>4</td> <td>01/31/2023</td> <td>ESS</td> <td>ISSUED FOR CONSTRUCTION</td> <td>DLK</td> <td>DLK</td> </tr> <tr> <td>3</td> <td>12/16/2022</td> <td>ESS</td> <td>TRAFFIC REVISIONS PER COUNTY COMMENTS</td> <td>DLK</td> <td>DLK</td> </tr> <tr> <td>2</td> <td>10/12/2022</td> <td>ESS</td> <td>SESC CERTIFICATION SUBMISSION</td> <td>DLK</td> <td>DLK</td> </tr> <tr> <td>1</td> <td>09/12/2022</td> <td>ESS</td> <td>TWA PERMIT SUBMISSION</td> <td>DLK</td> <td>DLK</td> </tr> </table>	Rev	Date	Drawn	Description	Ch'k'd	App'd	4	01/31/2023	ESS	ISSUED FOR CONSTRUCTION	DLK	DLK	3	12/16/2022	ESS	TRAFFIC REVISIONS PER COUNTY COMMENTS	DLK	DLK	2	10/12/2022	ESS	SESC CERTIFICATION SUBMISSION	DLK	DLK	1	09/12/2022	ESS	TWA PERMIT SUBMISSION	DLK	DLK	<p>DAVID L. KLEMM NJ PROFESSIONAL ENGINEER LIC. No. 38672</p> <p><i>D. Klemm</i> Date 1/31/23</p>	<table border="1"> <tr> <td>Designed</td> <td></td> <td>Eng check</td> <td></td> </tr> <tr> <td>Drawn</td> <td></td> <td>Coordination</td> <td></td> </tr> <tr> <td>Dwg check</td> <td></td> <td>Approved</td> <td></td> </tr> </table>	Designed		Eng check		Drawn		Coordination		Dwg check		Approved		<p>Title</p> <p>METER CHAMBER 13B SANITARY SEWER COLLECTION SYSTEM UPGRADES TRAFFIC DETOUR PLAN 2 OF 3</p>
			Rev	Date	Drawn	Description	Ch'k'd	App'd																																							
4	01/31/2023	ESS	ISSUED FOR CONSTRUCTION	DLK	DLK																																										
3	12/16/2022	ESS	TRAFFIC REVISIONS PER COUNTY COMMENTS	DLK	DLK																																										
2	10/12/2022	ESS	SESC CERTIFICATION SUBMISSION	DLK	DLK																																										
1	09/12/2022	ESS	TWA PERMIT SUBMISSION	DLK	DLK																																										
Designed		Eng check																																													
Drawn		Coordination																																													
Dwg check		Approved																																													
		<table border="1"> <tr> <td>Scale at ANSI D</td> <td>Status</td> <td>Rev</td> <td>Security</td> </tr> <tr> <td>As Shown</td> <td>BID</td> <td>Rev4</td> <td>STD</td> </tr> </table>	Scale at ANSI D	Status	Rev	Security	As Shown	BID	Rev4	STD	<table border="1"> <tr> <td>Project Number</td> <td>B/O</td> <td>Total</td> </tr> <tr> <td>507103994</td> <td>14</td> <td>18</td> </tr> </table>	Project Number	B/O	Total	507103994	14	18	<table border="1"> <tr> <td>Drawing Number</td> <td></td> </tr> <tr> <td>TC-002</td> <td></td> </tr> </table>	Drawing Number		TC-002																										
Scale at ANSI D	Status	Rev	Security																																												
As Shown	BID	Rev4	STD																																												
Project Number	B/O	Total																																													
507103994	14	18																																													
Drawing Number																																															
TC-002																																															

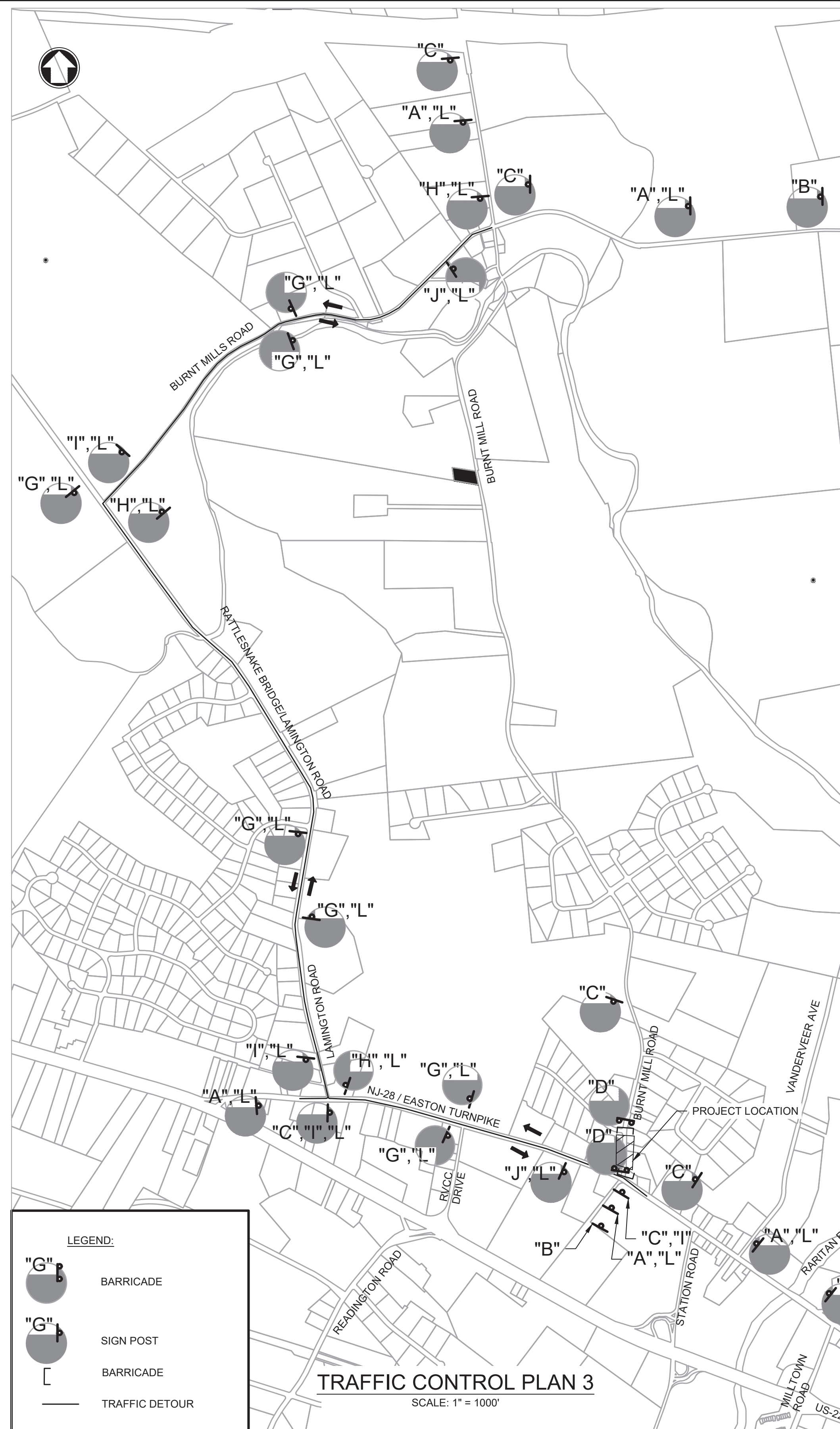

SIGNS FOR TRAFFIC CONTROL PLAN 3 (PAYMENT INCLUDED UNDER ITEM 20B)				
SIGN		NUMBER OF SIGNS REQUIRED	SIZE	SF
"A"	W20-2	5	48" X 48"	80
"B"	W20-3	3	48" X 48"	48
"C"	R11-3	6	60" X 30"	75
"D"	R11-4	2	60" X 30"	25
"E"	R4-10R (RIGHT)	0	48" X 18"	0
"F"	M4-10R (LEFT)	0	48" X 18"	0
"G"	M4-9X	7	30" X 24"	35
"H"	M4-9R (RIGHT)	3	30" X 24"	15
"I"	M4-PL (LEFT)	4	30" X 24"	20
"J"	M4-8A	2	30" X 24"	10
"L"	SPECIAL	20	48" X 18"	120
			TOTAL SF:	428

 "A" W20-2 48" x 48"	 "B" W20-3 48" x 48"
 "C" R11-3 60" x 30"	 "D" R11-4 60" x 30"
 "E" M4-10R (RIGHT) 48" x 18"	 "F" M4-10R (LEFT) 48" x 18"
 "G" M4-9S 30" x 24"	 "H" M4-9R (RIGHT) 30" x 24"
 "I" M4-9L (LEFT) 30" x 24"	 "J" M4-8A 30" x 24"
 "L" SPECIAL 48" X 18"	

NOTES:
1. APPROXIMATE DURATION FOR PHASE 3 IS 1 WEEK.

© Mott MacDonald
This document is issued for the party which commissioned it and for specific purposes connected with the captioned project only. It should not be relied upon by any other party or used for any other purpose. We accept no responsibility for the consequences of this document being relied upon by any other party, or being used for any other purpose, or containing any error or omission which is due to an error or omission in data supplied to us by other parties.

M M
MOTT MACDONALD

111 Wood Avenue South
Iselin NJ 08830-4112
United States of America
Certificate No. 24GA28016600

T +1 (800) 832 3272
F +1 (973) 376 1072
www.mottmacamericas.com

Client
**TOWNSHIP OF BRANCHBURG
SOMERSET COUNTY
BRANCHBURG, NJ**

Rev	Date	Drawn	Description	Ch'k'd	App'd
4	01/31/2023	ESS	ISSUED FOR CONSTRUCTION	DLK	DLK
3	12/16/2022	ESS	TRAFFIC REVISIONS PER COUNTY COMMENTS	DLK	DLK
2	10/12/2022	ESS	SESC CERTIFICATION SUBMISSION	DLK	DLK
1	09/12/2022	ESS	TWA PERMIT SUBMISSION	DLK	DLK

DAVID L. KLEMM
NJ PROFESSIONAL ENGINEER LIC. No. 38672

D. Klemm Date **1/31/23**

Project Number **507103994** B/O **15** Total **18**

Designed	Eng check
Drawn	Coordination
Dwg check	Approved
Scale at ANSI D As Shown	Status BID
Rev Rev4	Security STD
Drawing Number TC-003	

Title
**METER CHAMBER 13B SANITARY
SEWER COLLECTION SYSTEM
UPGRADES
TRAFFIC DETOUR PLAN 3 OF 3**

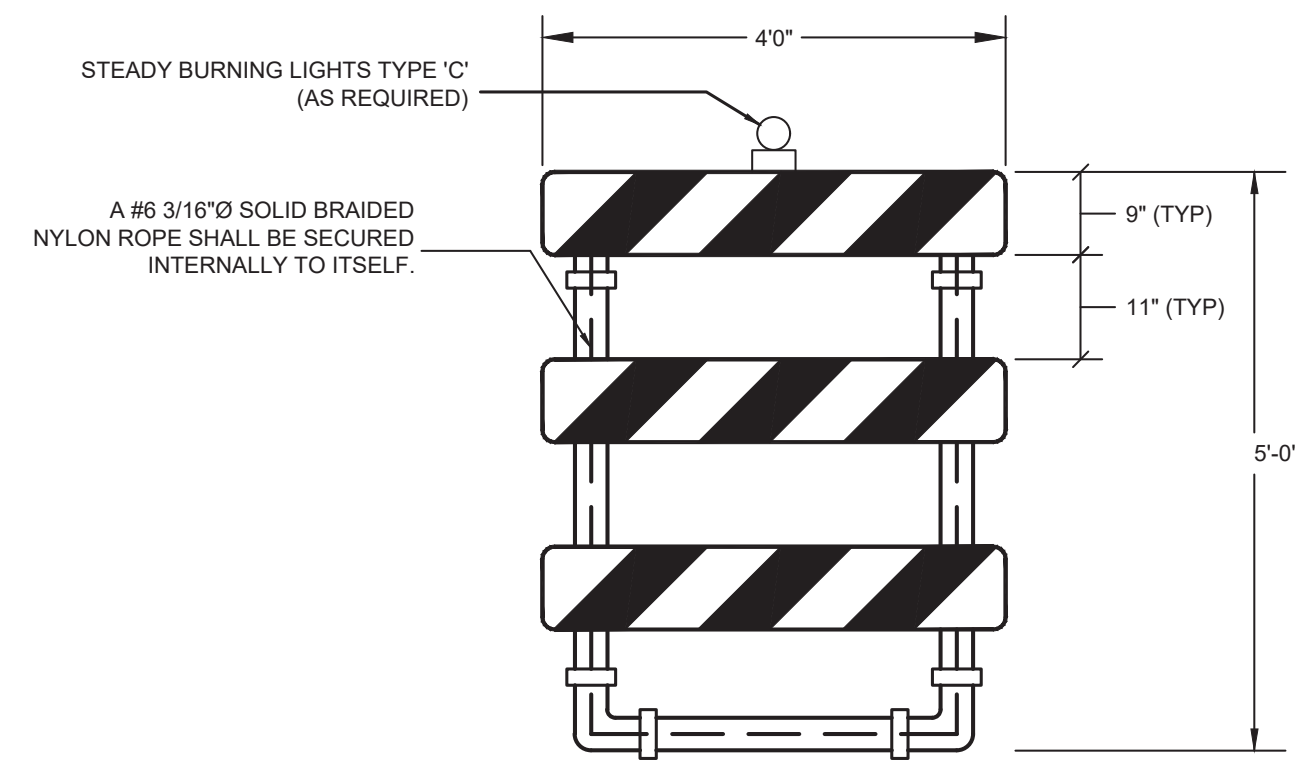

FRONT VIEW

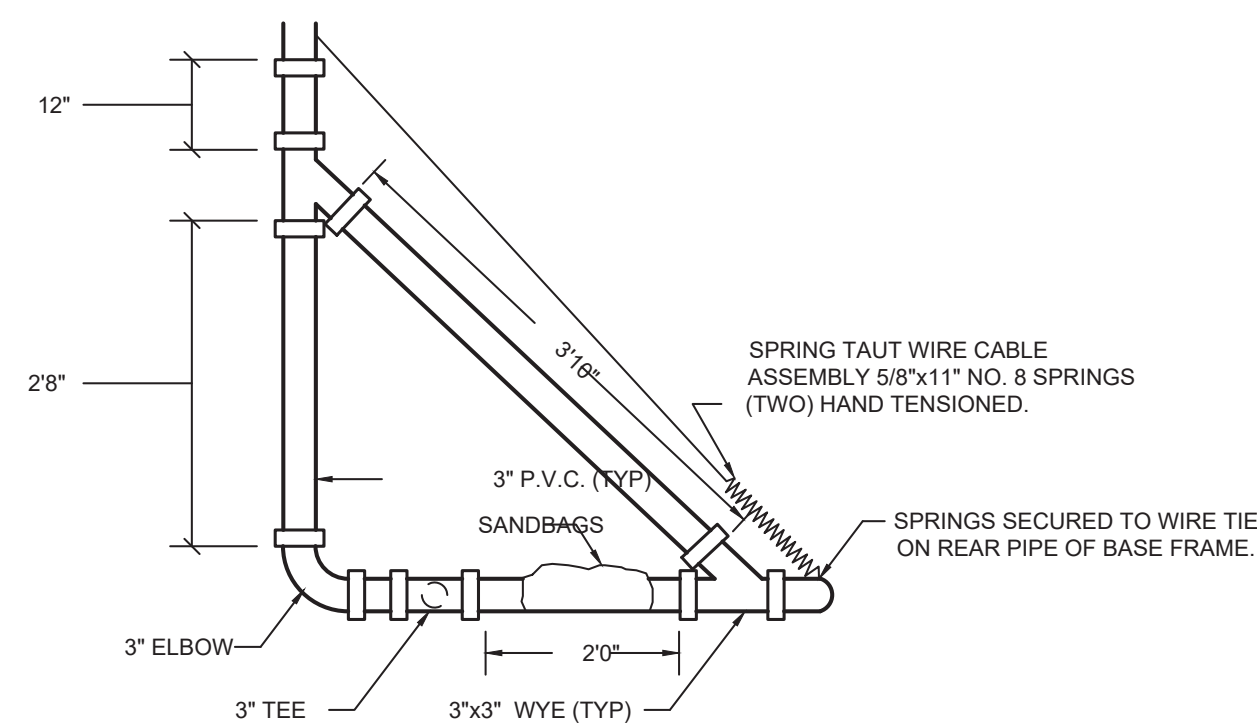

SIDE VIEW

- NOTE:
- ORANGE AND WHITE STRIPES SHALL BE REFLECTIVE SHEETING AS SHOWN FOR CONSTRUCTION SIGNS. ALTERNATE ORANGE AND WHITE STRIPES 6" WIDE SLOPING DOWNWARD AT AN ANGLE OF 45° IN THE DIRECTION TRAFFIC IS TO PASS.
 - THE 9"x48" BARRICADE RAILS SHALL BE FABRICATED FROM 0.024" ANODIZED ALUMINUM OR 0.125" MAX. PLASTIC SHEETING AND SHALL BE ATTACHED, 4 PER RAIL, WITH 1" NO. 14 PAN HEAD METAL SCREWS OR PLASTIC RIVETS. ALL CORNERS SHALL BE ROUNDED.
 - PIPE SHALL BE WHITE PVC SCHEDULE 40 ASTM 1785 OR PVC, SDR-26 ASTM 2241. FITTINGS SHALL BE WHITE PVC OR ABS OF MATCHING WALL THICKNESS AND INSIDE DIAMETER AND MEETING THE MATERIALS REQUIREMENTS AND TESTING SECTIONS OF ASTM D-2466 FOR PVC AND ASTM D-2468 FOR ABS. ALL JOINTS SHALL BE SLIP FIT AND NOT THREADED OR CEMENTED. PVC FITTINGS MEETING ASTM D-2665 WILL ALSO BE ACCEPTABLE.
 - SANDBAG PLACEMENT MAY BE ADJUSTED AT THE DIRECTION OF THE ENGINEER.
 - MINOR MANUFACTURERS VARIATIONS MAY BE ACCEPTABLE UPON APPROVAL OF THE ENGINEER.

TYPE III BREAKAWAY BARRICADES
NOT TO SCALE

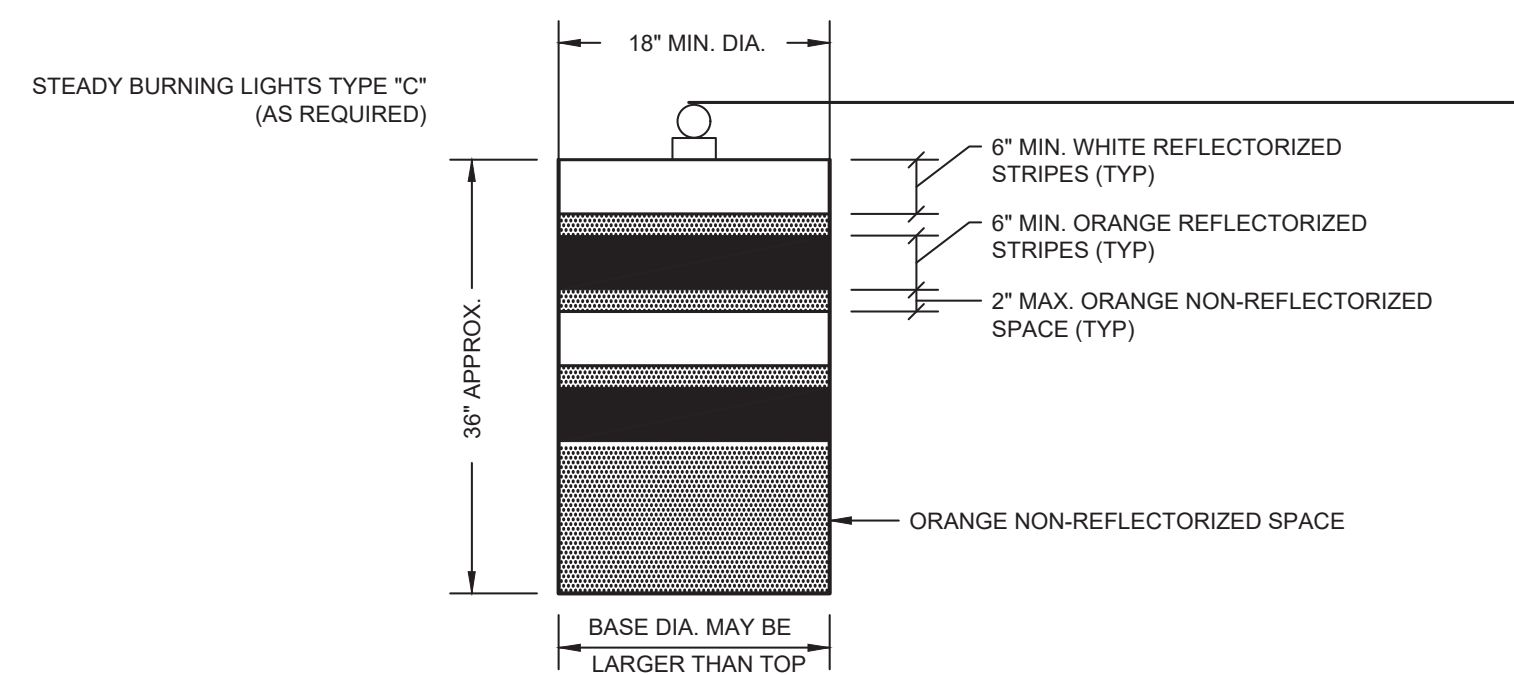

- NOTE:
- DRUMS SHALL BE MADE OF ORANGE PLASTIC WITH A MINIMUM OF FOUR ALTERNATE ORANGE AND WHITE REFLECTORIZED STRIPES. IF THERE ARE NON-REFLECTORIZED

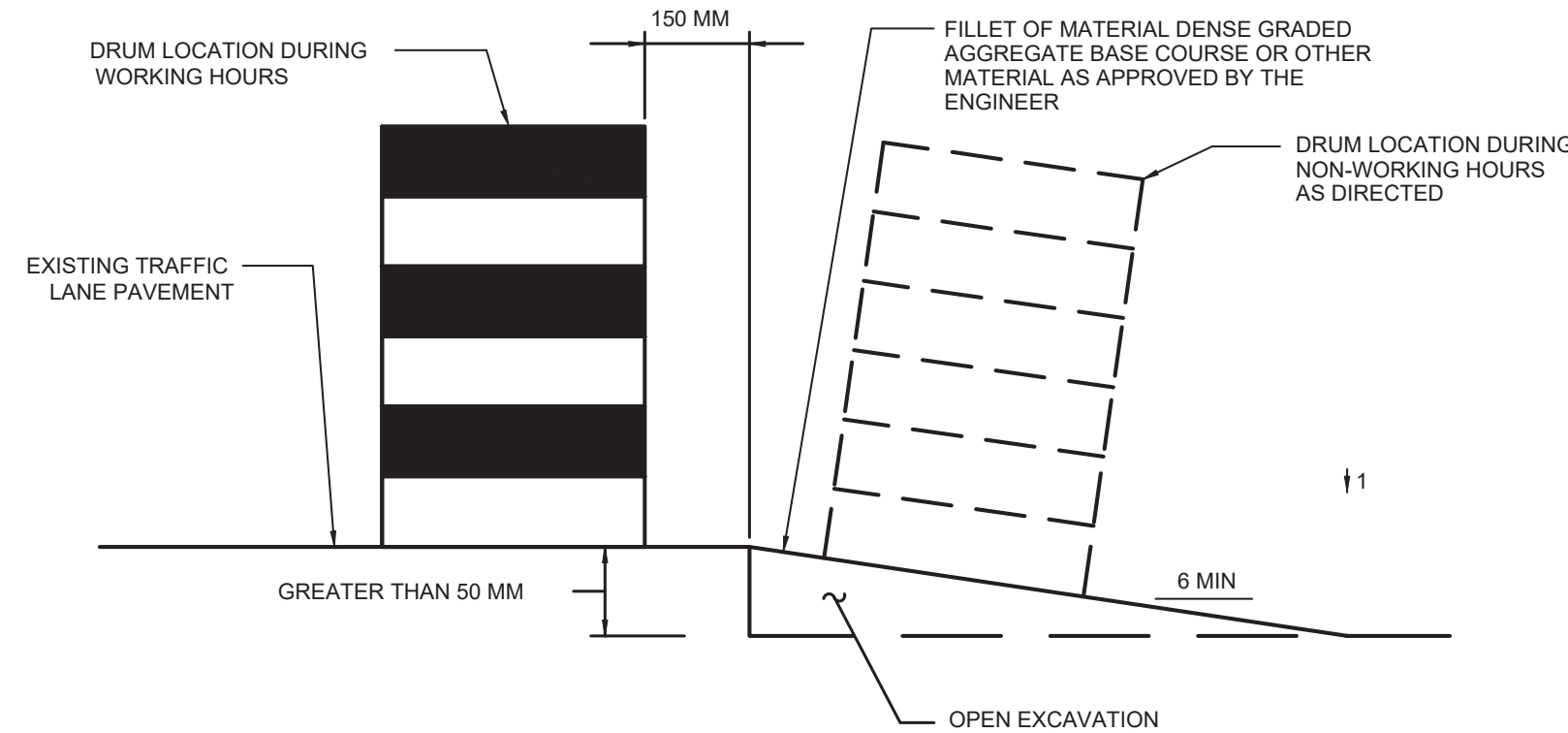

ESCAPE RAMP DETAIL
NOT TO SCALE

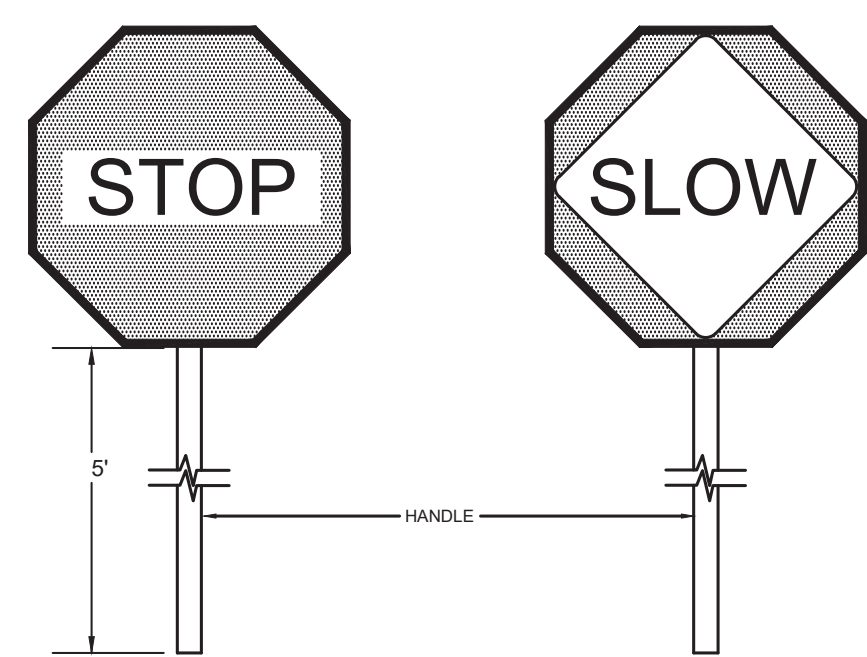

NOTE: SIGN FACES SHALL BE REFLECTIVE SHEETING CONFORMING TO SUBSECTION 916.06 TYPE II SHEETING.

STOP/SLOW PADDLE DETAIL
NOT TO SCALE

REGULATORY APPROACH SPEED OF TRAFFIC MILES/HOUR	MINIMUM TAPER RATIO IN LENGTH PER FOOT OF WIDTH	RECOMMENDED TAPER LENGTH AND SPACING FOR CHANNELIZING TAPERS			MAXIMUM DEVICE (B) SPACING ALONG TAPERS IN FEET	RECOMMENDED SPACING ALONG TANGENTS
		MINIMUM TAPER LENGTH L-FOR LANE WIDTHS	10'	11'		
25	10.5:1	105	115	125	25	50
30	15:1	150	165	180	30	60
35	20.5:1	205	225	245	35	70
40	27:1	270	300	325	40	80
45	45:1	450	495	540	45	90
50	50:1	500	550	600	50	100
55	55:1	550	605	660	55	110
60	60:1	600	660	720	60	120
65	65:1	650	715	780	65	130

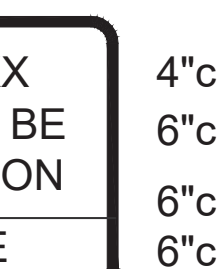
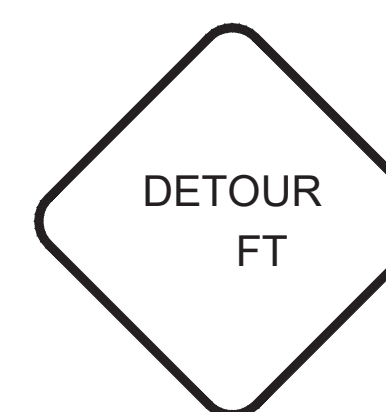
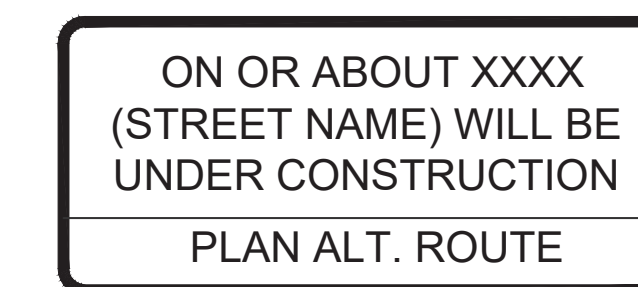
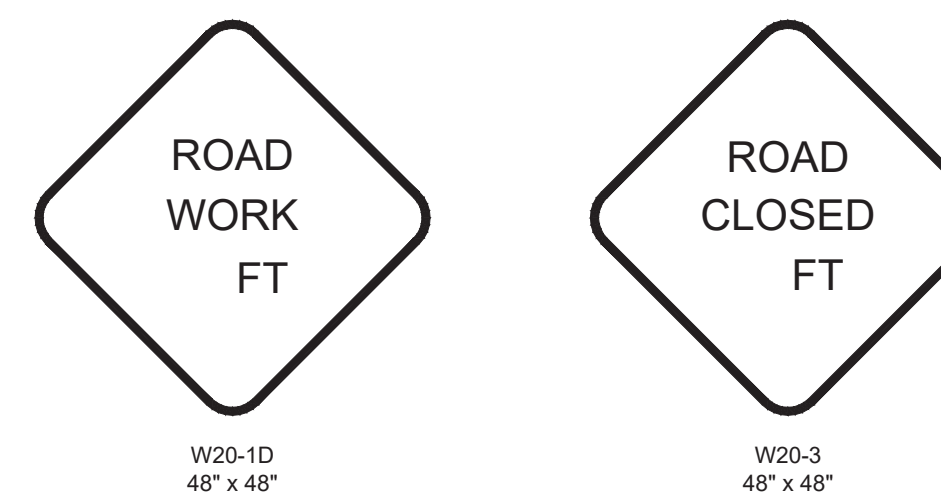

TEMPORARY SIGN DETAILS
NOT TO SCALE

FINAL FOR SEWER DESIGN

M M
MOTT MACDONALD

111 Wood Avenue South
Iselin NJ 08830-4112
United States of America
Certificate No. 24GA28016600

T +1 (800) 832 3272
F +1 (973) 376 1072
www.mottmacamericas.com

Client
TOWNSHIP OF BRANCHBURG
SOMERSET COUNTY
BRANCHBURG, NJ

Rev	Date	Drawn	Description	Ch'k'd	App'd
4	01/31/2023	ESS	ISSUED FOR CONSTRUCTION	DLK	DLK
3	12/16/2022	ESS	TRAFFIC REVISIONS PER COUNTY COMMENTS	DLK	DLK
2	10/12/2022	ESS	SESC CERTIFICATION SUBMISSION	DLK	DLK
1	09/12/2022	ESS	TWA PERMIT SUBMISSION	DLK	DLK

DAVID L. KLEMM
NJ PROFESSIONAL ENGINEER LIC. No. 38672

D.L.K. Date **1/31/23**

Project Number **507103994** B/O **16** Total **18**

Designed	ESS	Eng check	DLK
Drawn	ESS	Coordination	MJC
Dwg check	DLK	Approved	DLK
Scale at ANSI D As Shown	Status BID	Rev Rev4	Security STD
Drawing Number		TC-004	

Title
METER CHAMBER 13B SANITARY
SEWER COLLECTION SYSTEM
UPGRADES
TRAFFIC CONTROL DETAILS -
SHEET 1 OF 3



W13-1
24' x 24'



M4-11
30' x 24'

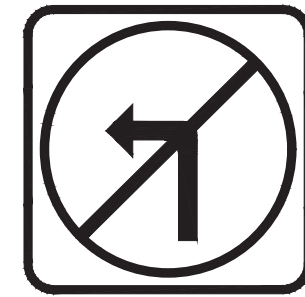

R3-2
24' x 24'

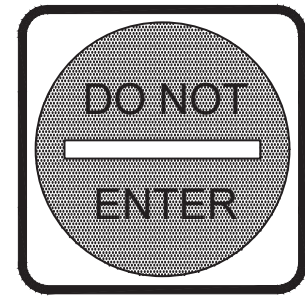

R5-1
30' x 30'



W20-1
48' x 48'



W20-5-R
48' x 48'

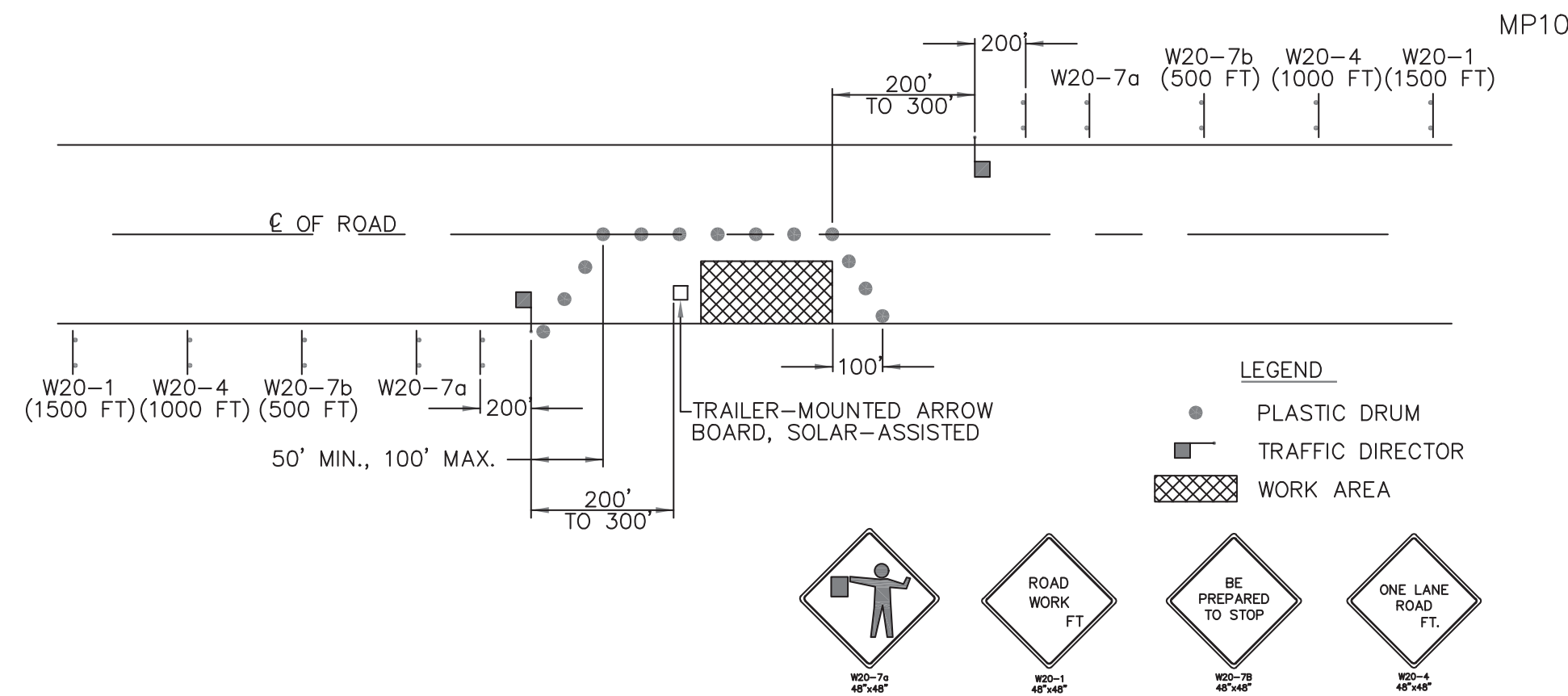

TYPICAL ONE-LANE-CLOSURE OPERATION
NOT TO SCALE

- NOTES
1. ALL SIGNS AND OTHER TRAFFIC CONTROL DEVICES ARE TO CONFORM TO THE MANUAL ON UNIFORM TRAFFIC CONTROL DEVICES FOR STREETS AND HIGHWAYS, WHEREIN THE SIGNS IN THIS FIGURE ARE IDENTIFIED.
 2. FLASHING WARNING LIGHTS ARE NOT TO BE MOUNTED ON ANY SIGNS.
 3. FOR DAYTIME OPERATIONS OF A SHORT DURATION, AND ON ROADS THAT ARE NOT MAJOR ARTERIES, THE W20-1 (AHEAD), W20-7A AND W20-7B SIGNS WILL SUFFICE FOR EACH APPROACH. THE TRAFFIC DIRECTOR AND ALL OTHER DEVICES WILL REMAIN THE SAME.
 4. DRUMS ARE TO BE PLACED AT 30' INTERVALS THROUGHOUT THE WORK ZONE.
 5. TRAFFIC DIRECTORS SHALL USE STOP/SLOW PADDLES (R1-1) AND, WHERE SIGHT IS OBSTRUCTED, WALKIE-TALKIES.



M4-9L (LEFT)
M4-9R (RIGHT)
30' x 24'



M4-9X
30' x 24'



W9-1-R
36' x 36'

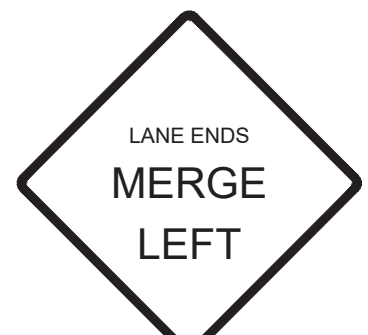

W9-2-L
36' x 36'

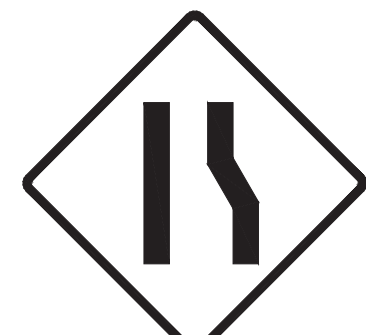

W4-2-R
36' x 36'



W5-1
36' x 36'

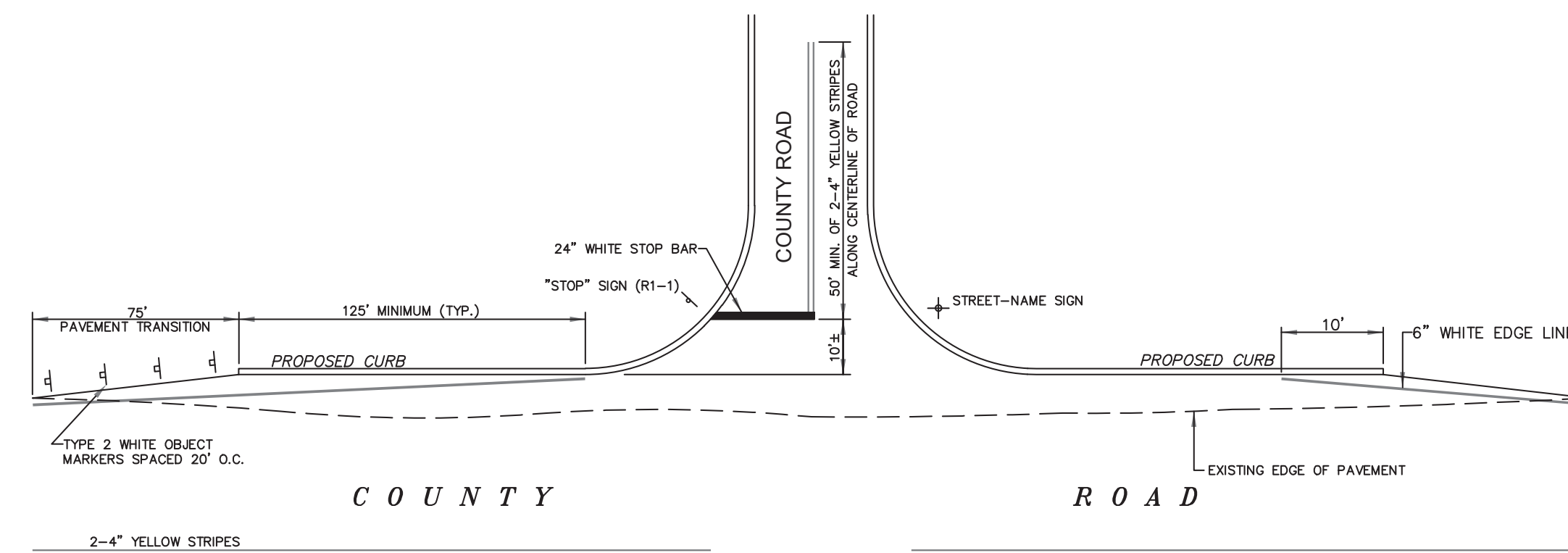

SIGNING AND STRIPING
FOR PROPOSED INTERSECTION
NOT TO SCALE

- SOMERSET COUNTY SIGNAGE & STRIPING NOTES:
1. THE SOMERSET COUNTY TRAFFIC DIVISION IS TO BE NOTIFIED AT (909) 231-7162 A MINIMUM OF 72 HOURS PRIOR TO THE INSTALLATION OF ANY STRIPING WITHIN A COUNTY RIGHT-OF-WAY. THE NOTIFICATION IS TO BE MADE BY THE CONTRACTOR WHO WILL INSTALL THE STRIPING.
 2. PRIOR TO INSTALLING ANY STRIPING IN THE COUNTY RIGHT-OF-WAY THE STRIPING CONTRACTOR MUST RECEIVE APPROVAL FROM THE COUNTY TRAFFIC DIVISION FOR THE "MARK OUT" OF ALL STRIPING.
 3. ALL PAVEMENT MARKINGS SHALL BE ALKYD-TYPE THERMOPLASTIC FOR A THICKNESS OF 90 MILS.
 4. THERE SHALL BE A 6-INCH SPACE BETWEEN ALL DOUBLE YELLOW STRIPES.
 5. ALL EXISTING STRIPING AND PAVEMENT REFLECTORS THAT DO NOT CONFORM TO THE PROPOSED STRIPING PATTERN ARE TO BE REMOVED BY A METHOD THAT DOES NOT DAMAGE THE ROADWAY SURFACE. "BLACK OUT" PAINT WILL NOT BE PERMITTED.
 6. ALL PERMANENT SIGNS SHALL BE A FLAT ALUMINUM SHEET OF 6061-T6 ALLOY WITH A THICKNESS THAT SHALL CONFORM TO SUBSECTION 911.01.02A OF THE NEW JERSEY DEPARTMENT OF TRANSPORTATION STANDARD SPECIFICATIONS OF 2007.
 7. ALL PERMANENT SIGNS ARE TO BE MOUNTED ON GALVANIZED SQUARE TUBE STEEL SUPPORTS OF THE "TELESPAR SYSTEM" BY THE UNISTRUT CORPORATION AND ONLY TYPE III BREAKAWAY UNITS SHALL BE USED OR EQUAL AS APPROVED BY THE COUNTY ENGINEER.
 8. ALL "STOP" SIGNS (R1-1) ARE TO BE A MINIMUM 30-INCH DIAMETER WITH TWO-POST INSTALLATION AND ARE TO HAVE 3M BRAND DIAMOND-GRADE SHEETING.
 9. THE STREET NAME SIGN (IF CALLED FOR ON PLANS) IS TO BE LOCATED ON THE OPPOSITE CORNER FROM THE "STOP" SIGN (R1-1).
 10. SIGN FACINGS SHALL BE "WIDE ANGLE" PRISMATIC RETROREFLECTIVE SHEETING FOR VISUAL IMPACT PERFORMANCE" MANUFACTURED BY 3M BRAND SCOTCHLITE PRISMATIC LENS REFLECTIVE SHEETING (DIAMOND GRADE) OR EQUAL AS APPROVED BY THE COUNTY ENGINEER.
 11. ALL SIGN-SUPPORT POSTS ARE TO BE TELESPAR BRAND SQUARE-TUBE STEEL THAT IS GALVANIZED AND YIELDING TYPE III.
 12. IF A STRIPED CROSSWALK IS TO BE INSTALLED, THE STOPBAR SHALL BE LOCATED 5' FROM THE EDGE OF THE CROSSWALK CLOSEST TO THE STOPBAR.
 13. ALL TRAFFIC CONTROL DEVICES SHALL CONFORM TO THE CURRENT "MANUAL ON UNIFORM TRAFFIC CONTROL DEVICES FOR STREETS AND HIGHWAYS".



W20-1F
48' x 48'

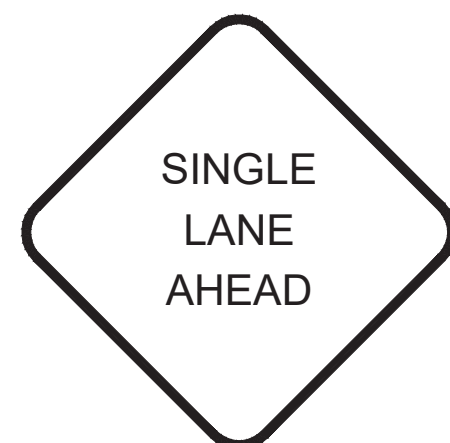

W20-4F
48' x 48'

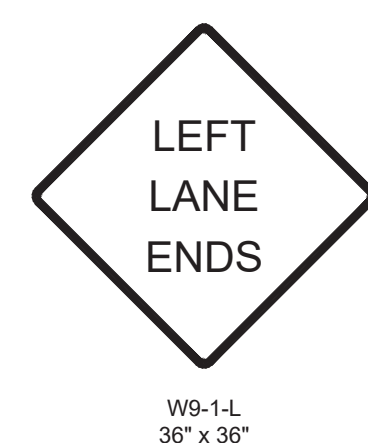

W9-1-L
36' x 36'

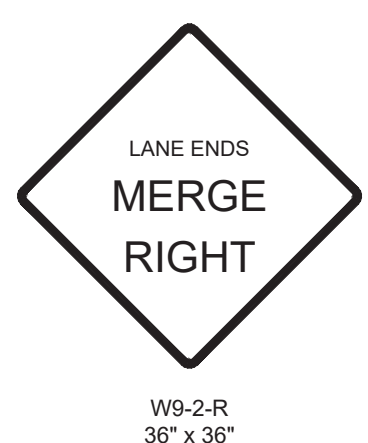

W9-2-R
36' x 36'



W4-2-L
36' x 36'



W20-5-L
48' x 48'



M4-9N



W99-2
48' x 48'



G20-2
60' x 24'

SIGNAGE
NOT TO SCALE

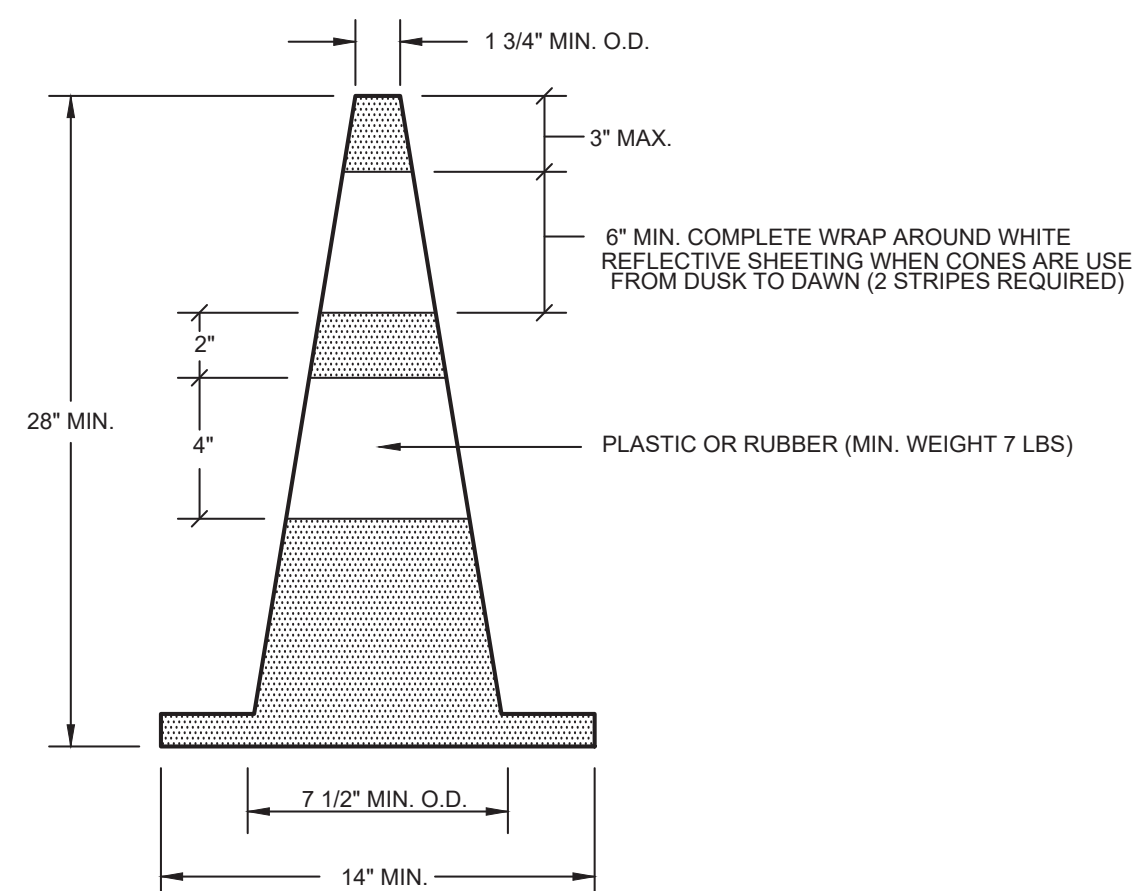

TRAFFIC CONE DETAIL
NOT TO SCALE

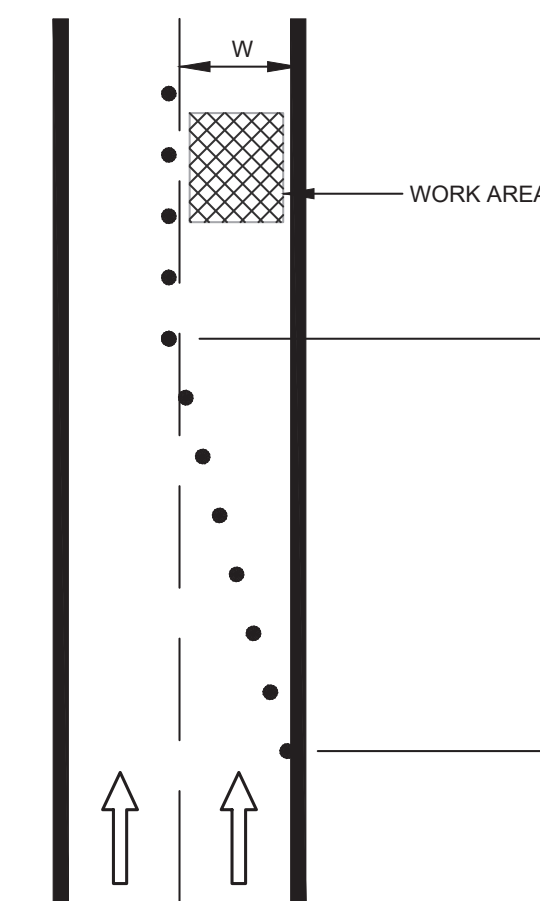

SINGLE LANE CLOSURE AND TAPER CHART
NOT TO SCALE

LEGEND OF TAPER CHART

W	40 MPH		45 MPH		50 MPH		55 MPH	
	L	#	L	#	L	#	L	#
1	30	2	45	3	50	3	55	3
2	55	3	90	4	100	4	110	4
3	80	3	135	5	150	5	165	5
4	110	4	180	6	200	6	220	7
5	135	5	225	7	250	7	275	8
6	160	5	270	8	300	9	330	9
10	270	8	450	13	500	14	550	15
11	295	9	495	14	550	15	605	16
12	320	9	540	15	600	16	660	18

- LEGEND:
- "W" IS THE WIDTH OF LANE CLOSURE IN FEET
 - "L" IS THE LENGTH OF TAPER
 - "#" IS THE NUMBER OF DRUMS IN TAPER AT 40 FOOT SPACING

© Mott MacDonald
This document is issued for the party which commissioned it and for specific purposes connected with the captioned project only. It should not be relied upon by any other party or used for any other purpose. We accept no responsibility for the consequences of this document being relied upon by any other party, or being used for any other purpose, or containing any error or omission which is due to an error or omission in data supplied to us by other parties.

<p>111 Wood Avenue South Iselin NJ 08830-4112 United States of America Certificate No. 24GA28016600</p> <p>T +1 (800) 832 3272 F +1 (973) 376 1072 www.mottmacamericas.com</p>	<p>Client</p> <p>TOWNSHIP OF BRANCHBURG SOMERSET COUNTY BRANCHBURG, NJ</p>	<table border="1"> <tr><td>4</td><td>01/31/2023</td><td>ESS</td><td>ISSUED FOR CONSTRUCTION</td><td>DLK</td><td>DLK</td></tr> <tr><td>3</td><td>12/16/2022</td><td>ESS</td><td>TRAFFIC REVISIONS PER COUNTY COMMENTS</td><td>DLK</td><td>DLK</td></tr> <tr><td>2</td><td>10/12/2022</td><td>ESS</td><td>SESC CERTIFICATION SUBMISSION</td><td>DLK</td><td>DLK</td></tr> <tr><td>1</td><td>09/12/2022</td><td>ESS</td><td>TWA PERMIT SUBMISSION</td><td>DLK</td><td>DLK</td></tr> <tr><td>Rev</td><td>Date</td><td>Drawn</td><td>Description</td><td>Ch'k'd</td><td>App'd</td></tr> </table>	4	01/31/2023	ESS	ISSUED FOR CONSTRUCTION	DLK	DLK	3	12/16/2022	ESS	TRAFFIC REVISIONS PER COUNTY COMMENTS	DLK	DLK	2	10/12/2022	ESS	SESC CERTIFICATION SUBMISSION	DLK	DLK	1	09/12/2022	ESS	TWA PERMIT SUBMISSION	DLK	DLK	Rev	Date	Drawn	Description	Ch'k'd	App'd	<p>DAVID L. KLEMM NJ PROFESSIONAL ENGINEER LIC. No. 38672</p> <p><i>D.L.K.</i> Date 1/31/23</p>	Designed	ESS	Eng check	DLK	<p>Title</p> <p>METER CHAMBER 13B SANITARY SEWER COLLECTION SYSTEM UPGRADES TRAFFIC CONTROL DETAILS - SHEET 2 OF 3</p>
			4	01/31/2023	ESS	ISSUED FOR CONSTRUCTION	DLK	DLK																														
			3	12/16/2022	ESS	TRAFFIC REVISIONS PER COUNTY COMMENTS	DLK	DLK																														
			2	10/12/2022	ESS	SESC CERTIFICATION SUBMISSION	DLK	DLK																														
1	09/12/2022	ESS	TWA PERMIT SUBMISSION	DLK	DLK																																	
Rev	Date	Drawn	Description	Ch'k'd	App'd																																	
Drawn	ESS	Coordination	MJC																																			
Dwg check	DLK	Approved	DLK																																			
Scale at ANSI D	Status	Rev	Security																																			
As Shown	BID	Rev4	STD	Drawing Number	TC-005																																	
Project Number	B/O	Total																																				
507103994	17	18																																				

TRAFFIC CONTROL GENERAL NOTES:

1. ADVANCE WARNING SIGNS, DISTANCES, AND TAPER LENGTHS MAY BE EXTENDED, AT DIRECTION OF THE TOWNSHIP POLICE OR ENGINEER, TO ADJUST FOR REDUCED VISIBILITY DUE TO HORIZONTAL AND VERTICAL CURVATURE OF THE ROADWAY.

2. CONTRACTOR SHALL PROVIDE OFF-DUTY POLICE OFFICER FROM TOWNSHIP OF BRANCHBURG TO PROVIDE TRAFFIC CONTROL AS REQUIRED BY THE TOWNSHIP POLICE. SEE CONTRACT SPECIFICATIONS FOR DETAILS.

3. PRIOR TO ANY ROAD CONSTRUCTION, TRAFFIC CONTROL SIGNS AND DEVICES SHALL BE IN PLACE.

4. RAMPS AND/OR SIDE STREETS ENTERING THE ROADWAY AFTER THE FIRST ADVANCE WARNING SIGN SHALL BE PROVIDED WITH AT LEAST ONE W20-IF SIGN (ROAD WORK AHEAD) AS A MINIMUM.

5. ALL EXISTING ROAD SIGNS, PAVEMENT MARKINGS AND/OR PLOWABLE PAVEMENT REFLECTORS WHICH CONFLICT WITH THE PROPOSED TRAFFIC CONTROL PLAN SHALL BE COVERED, REMOVED OR RELOCATED AS DIRECTED BY THE ENGINEER OR TOWNSHIP POLICE.

6. CONFLICTING OR NON-OPERATING SIGNAL INDICATIONS ON EITHER THE EXISTING, TEMPORARY, OR PROPOSED TRAFFIC SIGNAL SYSTEMS SHALL BE BAGGED OR COVERED.

7. MAINTENANCE AND PROTECTION OF TRAFFIC SHALL BE IN ACCORDANCE WITH THE MANUAL OF UNIFORM TRAFFIC CONTROL DEVICES - PART VI "STANDARDS AND GUIDES FOR TRAFFIC CONTROL FOR STREET AND HIGHWAY CONSTRUCTION, MAINTENANCE, UTILITY, AND INCIDENT MANAGEMENT OPERATIONS", UNLESS OTHERWISE NOTED IN THE PLANS AND SPECIFICATIONS.

8. CONSTRUCTION SIGN W99-2 (GIVE US A BRAKE) SHALL BE LOCATED 200 FEET IN ADVANCE OF PROJECT LIMITS AS DIRECTED BY THE ENGINEER, TOWNSHIP POLICE OR TRAFFIC SIGNAL & SAFETY ENGINEERING REGIONAL TRAFFIC ENGINEER.

9. A W1-6 (ARROW) SIGN MOUNTED ON A BREAKAWAY BARRICADE AND CENTERED ON THE CLOSED WIDTH SHALL BE LOCATED 100 FEET BEYOND EACH INTERSECTION OR MAIN ACCESS POINT WITHIN THE AREA OF A LANE OR SHOULDER CLOSURE AS DIRECTED BY THE ENGINEER, TOWNSHIP POLICE OR TRAFFIC SIGNAL & SAFETY ENGINEERING REGIONAL TRAFFIC ENGINEER.

10. CONSTRUCTION SIGNS R11-4 (ROAD CLOSED TO THRU TRAFFIC) SHALL BE PLACED AT THE INTERSECTING STREETS WHICH ARE CLOSED TO TRAFFIC BECAUSE OF CONSTRUCTION.

11. CONSTRUCTION SIGNS W8-9A (SYMBOL FOR UNEVEN PAVEMENT) AND W8-14A (GROOVED PAVEMENT) SHALL BE USED WHEN SUCH PAVEMENT CONDITIONS EXIST. THE PLACEMENT OF THESE SIGNS SHALL BE AS DIRECTED BY THE ENGINEER, TOWNSHIP POLICE OR TRAFFIC SIGNAL & SAFETY ENGINEERING REGIONAL TRAFFIC ENGINEER.

12. MOVING WORK AREAS IN A LANE CLOSURE REQUIRE A TRAILER MOUNTED ILLUMINATED FLASHING ARROW TO REMAIN AT THE END OF THE TAPER, THE TRAFFIC CONTROL TRUCK WITH MOUNTED CRASH CUSHION THAT SHALL MOVE WITH THE WORK AREAS TO KEEP A 70 FOOT MINIMUM AND 150 FOOT MAX. BUFFER IN ADVANCE OF EACH WORK AREA.

13. THE CONTRACTOR SHALL SUBMIT A PLAN FOR THE SAFE ACCESS OF CONSTRUCTION VEHICLES THROUGHOUT THE WORK SITE WHERE SPACE CONSTRAINTS PREVENT THE USE OF LANE CLOSURES. THE PLAN SHALL BE SUBMITTED TO THE ENGINEER IN ACCORDANCE WITH THE STANDARD SPECIFICATIONS.

14. ALL EXCAVATED AREAS WITHIN OR ADJACENT TO THE ROADWAY SHALL BE BACKFILLED AND PLACED ON A MINIMUM 6H : 1V SLOPE BEFORE THE END OF EACH WORK DAY. OTHER EXCAVATED AREA WITHIN THE CLEAR ZONE SHALL BE BACKFILLED.

15. WHERE REQUIRED, THE CONTRACTOR SHALL MAKE PROVISIONS FOR MAINTAINING PEDESTRIAN CROSSING LOCATIONS AND TYPE AS DIRECTED BY THE ENGINEER.

16. BITUMINOUS CONCRETE PLACED DURING THE VARIOUS CONSTRUCTION STAGES SHALL BE TRANSITIONED ON A MINIMUM 20H : 1V SLOPE TO MEET THE ADJACENT EXISTING GRADE AT THE LONGITUDINAL AND TRANSVERSE LIMITS OF THE STAGE CONSTRUCTION AREAS UNLESS OTHERWISE NOTED ON THE STAGE CONSTRUCTION PLANS.

17. THE PLACEMENT AND OR RELOCATION OF PRECAST CONCRETE CURB, CONSTRUCTION BARRIER SHALL BE DONE DURING APPROVED OFF-PEAK HOURS WHEN TRAFFIC MAY BE REDUCED TO ONE LANE IN EACH DIRECTION.

18. CONSTRUCTION ZONE SPEED LIMIT WILL BE DETERMINED BY THE TOWNSHIP POLICE OR TRAFFIC SIGNAL & SAFETY ENGINEERING, REGIONAL TRAFFIC ENGINEER - WORK ZONE, AT THE TIME OF OR DURING CONSTRUCTION.

19. THE SPEED LIMIT, R2-1 (BLACK ON WHITE) WITH ADDED WORK ZONE PLATE (BLACK ON ORANGE) SIGNS SHALL BE LOCATED THROUGH WORK AREAS AS DIRECTED BY THE ENGINEER, TOWNSHIP POLICE OR TRAFFIC SIGNAL & SAFETY ENGINEERING REGIONAL TRAFFIC ENGINEER.

20. THE REDUCED SPEED AHEAD SIGN, R3-5(S) (BLACK ON ORANGE) SHALL BE LOCATED IN ADVANCE OF SPEED LIMIT R2-1 SIGNS WHICH REDUCE THE NORMAL POSTED SPEED LIMIT THROUGH THE CONSTRUCTION ZONE AS DIRECTED BY THE ENGINEER, TOWNSHIP POLICE OR TRAFFIC SIGNAL & SAFETY ENGINEERING REGIONAL TRAFFIC ENGINEER.

21. TRAFFIC FINES DOUBLED IN WORK AREA R(N)5-17(S), 4 FEET BY 2.5 FEET SIGN SHALL BE LOCATED 500 FEET AFTER THE FIRST ADVANCE WARNING SIGN, (W20 SERIES) AT EACH WORK AREA LOCATED WITHIN URBAN AREAS AS DIRECTED BY THE ENGINEER, TOWNSHIP POLICE OR TRAFFIC SIGNAL & SAFETY ENGINEERING REGIONAL TRAFFIC ENGINEER. THIS SIGN SHALL ALSO BE USED ON PROJECTS REQUIRING MOVING OPERATIONS IN WHICH CASE THE SIGN SHALL BE MOUNTED ON A SLOW MOVING CONSTRUCTION VEHICLE.

22. THE FINAL SURFACE PAVEMENT SHALL NOT BE CONSTRUCTED UNTIL THE FINAL STAGE OF THE PROJECT UNLESS OTHERWISE DIRECTED BY THE ENGINEER OR INDICATED ON THE PLANS. MANHOLES AND INLETS SHALL BE SET TO FINISHED GRADE AND TEMPORARY PAVEMENT RAMPS ARE TO BE CONSTRUCTED AROUND THEM WITH A MINIMUM 20H : 1V SLOPE IN ALL DIRECTIONS USING HOT MIX ASPHALT PAVEMENT. THIS TEMPORARY MATERIAL WILL BE REMOVED IMMEDIATELY PRIOR TO PLACING THE SURFACE COURSE.

23. TRAFFIC CONTROL DEVICES FOR LANE CLOSURES INCLUDING SIGNS, CONES, BARRICADES, ETC. SHALL BE PLACED AS SHOWN ON APPROVED TRAFFIC CONTROL AND DETOUR PLANS. SIGNS SHALL NOT BE PLACED WITHOUT ACTUAL LANE CLOSURES AND SHALL BE IMMEDIATELY REMOVED UPON REMOVAL OF THE CLOSURES.

24. CONES MAY BE SUBSTITUTED FOR DRUMS AND INSTALLED UPON THE APPROVAL OF THE ENGINEER.

25. TRAFFIC IMPACT NOTICES AND CHANGES
A. TERMS:
WHEN THE FOLLOWING TERMS ARE USED, THE INTENT AND MEANING SHALL BE AS FOLLOWS:

i. IMPACTS TO NORMAL TRAFFIC FLOW - WORK THAT REQUIRES A PORTION OF THE PAVED ROADWAY BEING BLOCKED OR CLOSED WITH SAFETY DEVICES OR VEHICLES, INCLUDING, BUT NOT LIMITED TO, FULL OR PARTIAL LANE CLOSURES, FULL OR PARTIAL RAMP CLOSURES, SHOULDER CLOSURES, MOVING OPERATIONS SUCH AS TRAFFIC STRIPING OR SWEEPING, LANE SHIFTS, OR ALTERNATING TRAFFIC. THIS APPLIES EVEN WHEN DETOURS ARE PROVIDED.

ii. TEMPORARY LANE CLOSURES - WORK DESCRIBED UNDER "IMPACTS TO NORMAL TRAFFIC FLOW" WHICH IS ROUTINELY SET UP AND REMOVED ON A DAILY BASIS.

iii. PERMANENT LANE CLOSURES - WORK DESCRIBED UNDER "IMPACTS TO NORMAL TRAFFIC FLOW" WHICH REMAINS IN PLACE CONTINUOUSLY FOR 24 HOURS OR MORE. PERMANENT LANE CLOSURES WILL NOT BE PERMITTED FOR THIS PROJECT.

B. ADVANCE NOTICES
FOR THE INITIAL START OF WORK THAT REQUIRES "IMPACTS TO NORMAL TRAFFIC FLOW", THE CONTRACTOR SHALL NOTIFY THE TOWNSHIP POLICE AND ENGINEER IN WRITING, OF THE PROPOSED DATE. THE NOTICE SHALL BE SUBMITTED AT LEAST TWENTY-EIGHT CALENDAR DAYS, BUT NOT MORE THAN SIXTY CALENDAR DAYS, BEFORE THE PROPOSED DATE START OF WORK THAT IMPACTS NORMAL TRAFFIC FLOW WILL NOT BE PERMITTED PRIOR TO THE DATE STATED IN THE NOTICE. THE CONTRACTOR SHALL CONFIRM, IN WRITING TO THE TOWNSHIP POLICE AND ENGINEER, THE PROPOSED DATE SEVEN (AND/OR FOURTEEN) CALENDAR DAYS BEFORE STARTING THE ESTABLISHMENT OF THE TRAFFIC CONTROL MEASURES FOR THE TRAFFIC IMPACT. THE CONTRACTOR SHALL IMMEDIATELY NOTIFY THE ENGINEER IF THE PROPOSED ESTABLISHMENT CAN NOT BE COMPLETED ON THE PROPOSED DATE.

C. PROGRESS NOTICES
ALL "IMPACTS TO NORMAL TRAFFIC FLOW" SCHEDULED FOR THE SEVEN DAY PERIOD STARTING ON THE FOLLOWING MONDAY SHALL BE SUBMITTED TO THE TOWNSHIP POLICE AND RESIDENT ENGINEER BY 9:00 AM OF EACH FRIDAY.

EACH DAY OF "TEMPORARY LANE CLOSURES" SHALL BE SUBMITTED TO THE TOWNSHIP POLICE AND RESIDENT ENGINEER BY 9:00 AM THE DAY IN ADVANCE OF THE START OF THOSE OPERATIONS.
"TEMPORARY LANE CLOSURES" FOR WEEKENDS SHALL BE SUBMITTED TO THE TOWNSHIP POLICE AND RESIDENT ENGINEER BY 9:00 AM ON THE IMMEDIATELY PRECEDING FRIDAY.

D. CHANGES TO THE SCHEDULED CLOSURES
REQUEST FOR A CHANGE TO THE TRAFFIC CONTROL REQUIREMENTS IN THE CONTRACT DOCUMENTS SHALL BE SUBMITTED IN WRITING TO THE TOWNSHIP POLICE AND RESIDENT ENGINEER AS FOLLOWS:

CHANGES TO THE SCHEDULED HOURS FOR "TEMPORARY LANE CLOSURES" SHALL BE SUBMITTED TO THE TOWNSHIP POLICE AND RESIDENT ENGINEER AT LEAST EIGHT CALENDAR DAYS IN ADVANCE OF WHEN THE CHANGE IS PROPOSED TO START.

OTHER PROPOSED CHANGES TO "TEMPORARY LANE CLOSURES" AND ALL CHANGES TO "PERMANENT LANE CLOSURES" SHALL BE SUBMITTED TO THE TOWNSHIP POLICE AND RESIDENT ENGINEER AS SPECIFIED IN THE SPECIFICATIONS.

NOTES:
1. THE CONTRACTOR SHALL PREPARE AND SUBMIT PROPOSED TRAFFIC CONTROL AND DETOUR PLAN TO THE TOWNSHIP OF BRANCHBURG POLICE DEPARTMENT, TOWNSHIP ENGINEER, TRAFFIC DEPARTMENT, SOMERSET COUNTY, AND NJDOT AS REQUIRED BY THE TOWNSHIP OF BRANCHBURG. SEE CONTRACT SPECIFICATIONS FOR DETAILS.

2. REFER TO SPECIFICATIONS REGARDING TRAFFIC CONTROL AND CONSTRUCTION HOURS. HOURS OF CONSTRUCTION FOR WORK WITHIN A COUNTY ROADWAY SHALL BE 8:30 AM TO 4:30 PM.

3. CONTRACTOR SHALL PREPARE, COORDINATE AND FINALIZE TRAFFIC CONTROL AND DETOUR PLAN IN ACCORDANCE WITH THE REQUIREMENTS OF THE NJDOT, MUNICIPAL POLICE DEPARTMENTS AND THE COUNTY. ALL SIGNS REQUIRED BY THE TOWNSHIP OF BRANCHBURG AS WELL AS ANY ADDITIONAL SIGNS REQUIRED BY LOCAL, COUNTY OR STATE AGENCIES SHALL BE PROVIDED BY THE CONTRACTOR. SEE SPECIFICATIONS FOR DETAILS.

4. CONTRACTOR SHALL BE RESPONSIBLE FOR FURNISHING, INSTALLING AND MAINTAINING ALL DETOUR SIGNAGE AND BARRICADES WHICH MAY BE REQUIRED.

5. SIGN "A" TO BE ERECTED A MINIMUM OF TWO (2) WEEKS PRIOR TO THE START OF CONSTRUCTION.

TEMPORARY SIGN SUPPORT:

1. SIGN SUPPORTS SHALL BE OF WELL SEASONED LUMBER, S4S, FREE OF SPLITS, KNOTS AND WARPS OR, OF STEEL OR ALUMINUM COMPONENTS.

2. WOOD POSTS SHALL HAVE A UNIFORM CROSS SECTION AND SHALL NOT EXCEED THE FOLLOWING DIMENSIONS FOR:
SINGLE POST - 4"x6"
TWO POST - 3"x6" or 4"x5"
THREE POSTS - 3"x5" or 4"x4"

3. NO BRACING IS PERMITTED. VERTICAL CLEARANCE FOR SIGNS MOUNTED ON WOOD SUPPORTS SHALL BE 7'-0" DESIRABLE, 6'-0" MINIMUM. EMBEDMENT DEPTH FOR THE WOOD POST SHALL NOT EXCEED 3'-6".

4. STEEL OR ALUMINUM POSTS SHALL BE IN ACCORDANCE WITH THE STANDARD DETAIL FOR SELECTIVE DIRECTIONAL SIGNS, CONSTRUCTION AND "M", "W" AND "R" BENDWAY SIGN SUPPORTS.

5. TEMPORARY SIGN SUPPORTS NOT MEETING THIS CRITERIA SHALL BE SHIELDED BY A LONGITUDINAL BARRIER OR CRASH CUSHION.
SIGN FACES:
SIGN FACES SHALL BE REFLECTIVE SHEETING DIAMOND GRADE CONFORMING TO NJDOT SUBSECTION 916.06 TYPE II SHEETING.

FASTENING:
ALL SIGNS SHALL BE SECURELY FASTENED TO THEIR SUPPORTS WITH BOLTS, NUTS AND WASHERS OF ALUMINUM (2024-T4 ALLOY) OR HOT-DIP GALVANIZED STEEL (ASTM 153)

BACKING MATERIAL:
ALUMINUM SHALL BE FLAT SHEET OF 6061-T6 ALLOY, .100" GAUGE.
TEMPORARY SIGN NOTES:

1. INSTALLATION, DIMENSIONS, COLORS AND DETAILS OF VARIOUS SIZE SIGNS, AND ACCESSORY PANELS TO FOLLOW STANDARDS IN THE CURRENT "STANDARD HIGHWAY SIGN PUBLICATION" AND THE CURRENT "MANUAL ON UNIFORM TRAFFIC CONTROL DEVICES FOR STREETS AND HIGHWAYS".

2. (S) REPRESENTS A SPECIAL SIZE SIGN.

3. LETTERS AND NUMERALS SHALL CONFORM TO THE CURRENT MANUAL, "STANDARD ALPHABETS FOR HIGHWAY SIGNS" US DEPARTMENT OF TRANSPORTATION, FEDERAL HIGHWAY ADMINISTRATION.

4. THE CONTRACTOR SHALL OBTAIN THE APPROVAL OF THE COUNTY AND THE STATE FOR THE DISTANCE TO BE USED ON THE ADVANCE WARNING SIGNS.

5. SIGNS TO BE INSTALLED TWO WEEKS PRIOR TO COMMENCEMENT.

6. ALL SIGNS ARE SHOWN AS A REFERENCE, CONTRACTOR TO PLACE SIGNS AT CORRECT DISTANCES AS PER NJDOT REQUIREMENTS. LOCATIONS OF SIGNS ARE NOT VERBATIM AND SHALL COMPLY WITH NJDOT STANDARD.

© Mott MacDonald
This document is issued for the party which commissioned it and for specific purposes connected with the captioned project only. It should not be relied upon by any other party or used for any other purpose. We accept no responsibility for the consequences of this document being relied upon by any other party, or being used for any other purpose, or containing any error or omission which is due to an error or omission in data supplied to us by other parties.

M M
MOTT MACDONALD
111 Wood Avenue South
Iselin NJ 08830-4112
United States of America
Certificate No. 24GA28016600
T +1 (800) 832 3272
F +1 (973) 376 1072
www.mottmacamericas.com

Client
**TOWNSHIP OF BRANCHBURG
SOMERSET COUNTY
BRANCHBURG, NJ**

3	01/31/2023	ESS	ISSUED FOR CONSTRUCTION	DLK	DLK		
3	12/16/2022	ESS	TRAFFIC REVISIONS PER COUNTY COMMENTS	DLK	DLK		
2	10/12/2022	ESS	SESC CERTIFICATION SUBMISSION	DLK	DLK		
1	09/12/2022	ESS	TWA PERMIT SUBMISSION	DLK	DLK		
Rev	Date	Drawn	Description	Ch'k'd	App'd		

DAVID L. KLEMM
NJ PROFESSIONAL ENGINEER LIC. No. 38672
D. Klemm Date *1/31/23*

Project Number	B/O	Total
507103994	18	18

Designed	ESS	Eng check	DLK	
Drawn	ESS	Coordination	MJC	
Dwg check	DLK	Approved	DLK	
Scale at ANSI D	Status	Rev	Security	
As Shown	BID	Rev4	STD	
Drawing Number	TC-006			

Title
**METER CHAMBER 13B SANITARY
SEWER COLLECTION SYSTEM
UPGRADES
TRAFFIC CONTROL DETAILS -
SHEET 3 OF 3**