

# Driveway

## SITE PLAN & IMPERVIOUS SURFACE CALCULATION – 3625 PARK AVE

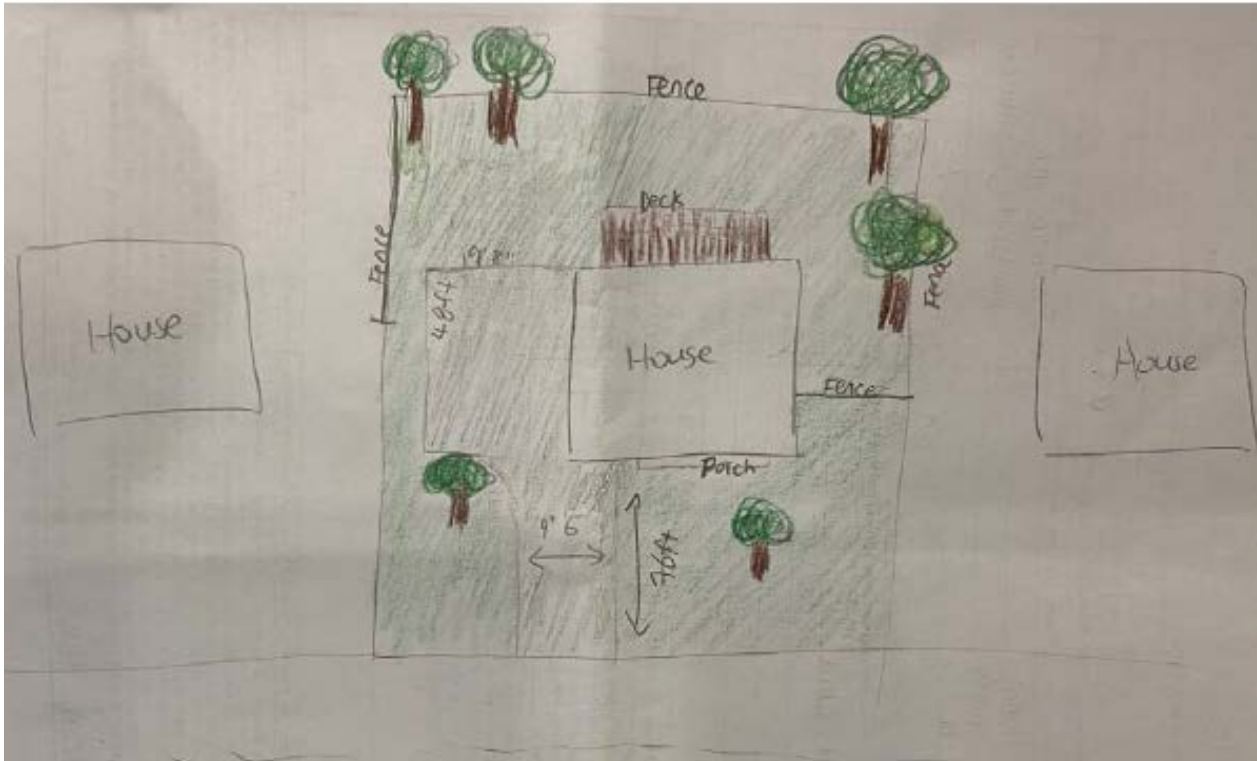

**Net Lot Area = 12,632 sf**

### Impervious Coverage

House/carport Footprint =	2,458 sf
Existing Driveway Footprint =	710 sf
Existing Deck Footprint =	256 sf
<u>NEW Driveway Addition =</u>	<u>1,628 sf</u>

**Total = 5,052 sf**

### Total Impervious Lot Coverage

$(5,052 \text{ sf} / 12,632 \text{ sf}) \times 100 = \mathbf{40\%}$

**MAX PERMITTED -> 40 %**

## Driveway

### **SITE PHOTOS – 3625 PARK AVE**



Front of House and Proposed Driveway Addition

## **MATERIALS**

Concrete (to match existing driveway)



## Driveway

### ADDITIONAL SITE PHOTOS – 3625 PARK AVE



Location to be Paved for Driveway



Location to be Paved for Driveway