

To ensure fair property tax bills for all residents, 20% of the properties in the Borough are being reappraised each year. Some of these properties will be appraised based on an analysis of the real estate market but some will be appraised by inspection. In this first year of a five-year cycle, Blocks 1-20 will be inspected. If your property did not receive an interior inspection during the municipal-wide Revaluation in 2018, and you wish to have the more comprehensive appraisal that can be done with interior inspections, you may ask the inspector to do this now. If you are not comfortable with an interior inspection, you can still verify the information that is on your property record card with the inspector.

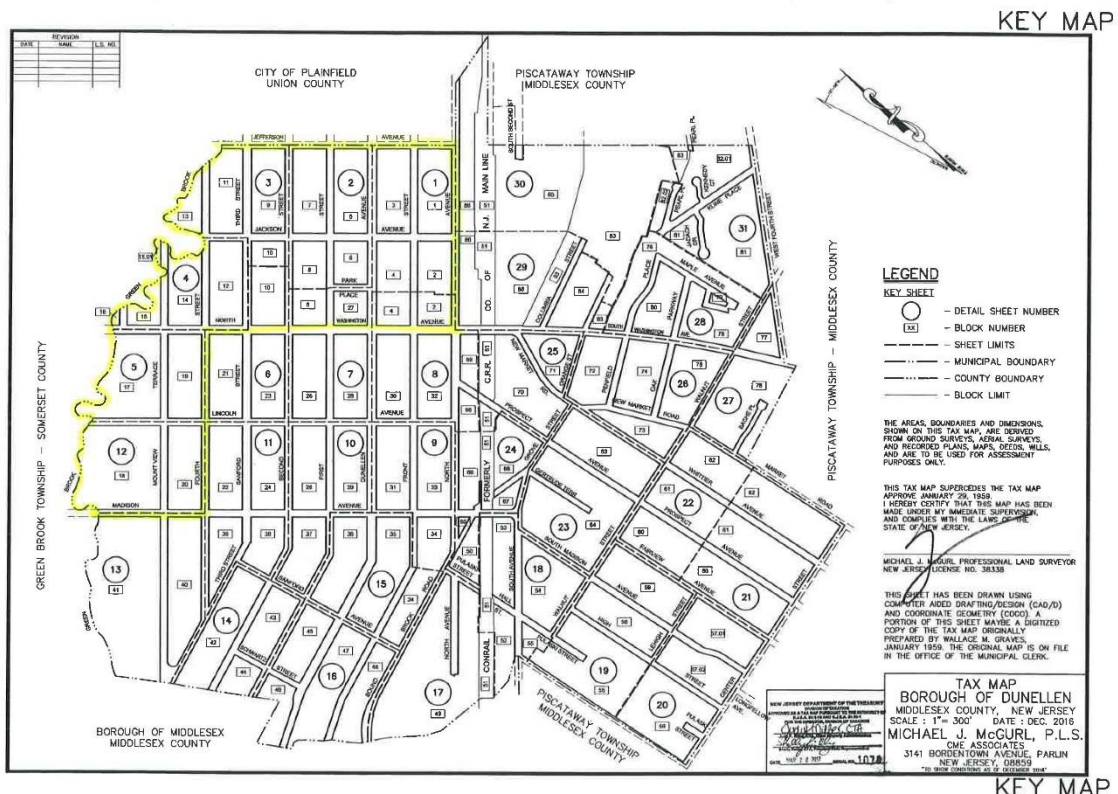

Property owners in these areas are being notified by a mid-August letter from the Dunellen Tax Assessor’s Office about when and how inspections will occur.

For information about the reassessment process, please click here: [Reassessment FAQs](#) or [Understanding Revaluations](#). The information provided are examples only and may not apply directly to Dunellen Borough or your individual property.