

2023-4

AGREEMENT

STATE OF NEBRASKA, DEPARTMENT OF TRANSPORTATION
COUNTY OF KEITH
PROJECT NO. NH-80-3(155), NH-80-6(157), AND NH-80-3(156)
CONTROL NO. 61371A, 61586, AND 61586A
COUNTY ROAD USE DURING CONSTRUCTION

THIS AGREEMENT is between the State of Nebraska, Department of Transportation ("State") and the County of Keith ("County") collectively referred to as the "Parties".

WITNESSETH:

WHEREAS, State intends to improve Interstate I-80 between Ogallala and Roscoe and the Ogallala Westbound Rest Area at the location show on Exhibits "A" and "B", and

WHEREAS, during construction, State's contractor will be using a Keith County road identified as "Roscoe Service Road" for access to and from the construction sites at the location shown on Exhibit "C", and

WHEREAS, State's contractor will maintain the County Road at no cost to County, and

WHEREAS, Keith County Board has authorized the Chairperson to sign this Agreement, as evidenced by the Resolution of the County Board, as shown on Exhibit "D".

NOW THEREFORE, in consideration of these facts and the mutual promises of the Parties hereto, the Parties agree as follows:

SECTION 1. PROJECT IMPROVEMENTS

State intends to improve Interstate I-80 between Ogallala and Roscoe and the Ogallala Westbound Rest Area at the location shown on Exhibits "A" and "B", attached and incorporated herein by this reference. State's improvements associated with this project will require State's contractor to utilize Roscoe Service Road for access to and from the construction sites as shown on Exhibit "C", attached and incorporated herein by this reference.

SECTION 2. COUNTY ROAD MAINTENANCE

State will maintain Roscoe Service Road while contractor is using it for access to the construction site.

SECTION 3. AUTHORITY TO SIGN

The Keith County Board has authorized the Chairperson of the Board to execute this Agreement, as evidenced by the Resolution of the Keith County Board, attached as Exhibit "D", and incorporated herein by this reference.

SECTION 4. ENTIRE AGREEMENT

This Agreement is the complete and exclusive statement of the arrangement between the parties, and supersedes all proposals, oral or written, and all other communications between the parties relating to the subject matter thereof. It may be amended from time to time in writing by the mutual consent of the Parties hereto.

[Remainder of this Page Intentionally Left Blank]

IN WITNESS WHEREOF, the County and the State have caused these presents to be executed by their proper officials thereunto duly authorized as of the dates below indicated.

EXECUTED by the County this 11th day of January, 2023.

WITNESS:

COUNTY OF KEITH

Sandra K. Wilson
County Clerk

Joan Ervin
Chairperson, County Board

EXECUTED by the State this _____ day of _____, 20____.

STATE OF NEBRASKA
DEPARTMENT OF TRANSPORTATION
Mick Syslo, P.E.

Roadway Design Engineer

RECOMMENDED:
Gary Thayer, P.E.

District 6 Engineer Date

OGALLALA - ROSCOE 80-3(156)

C.N. 61586 BOOK X310
KEITH COUNTY

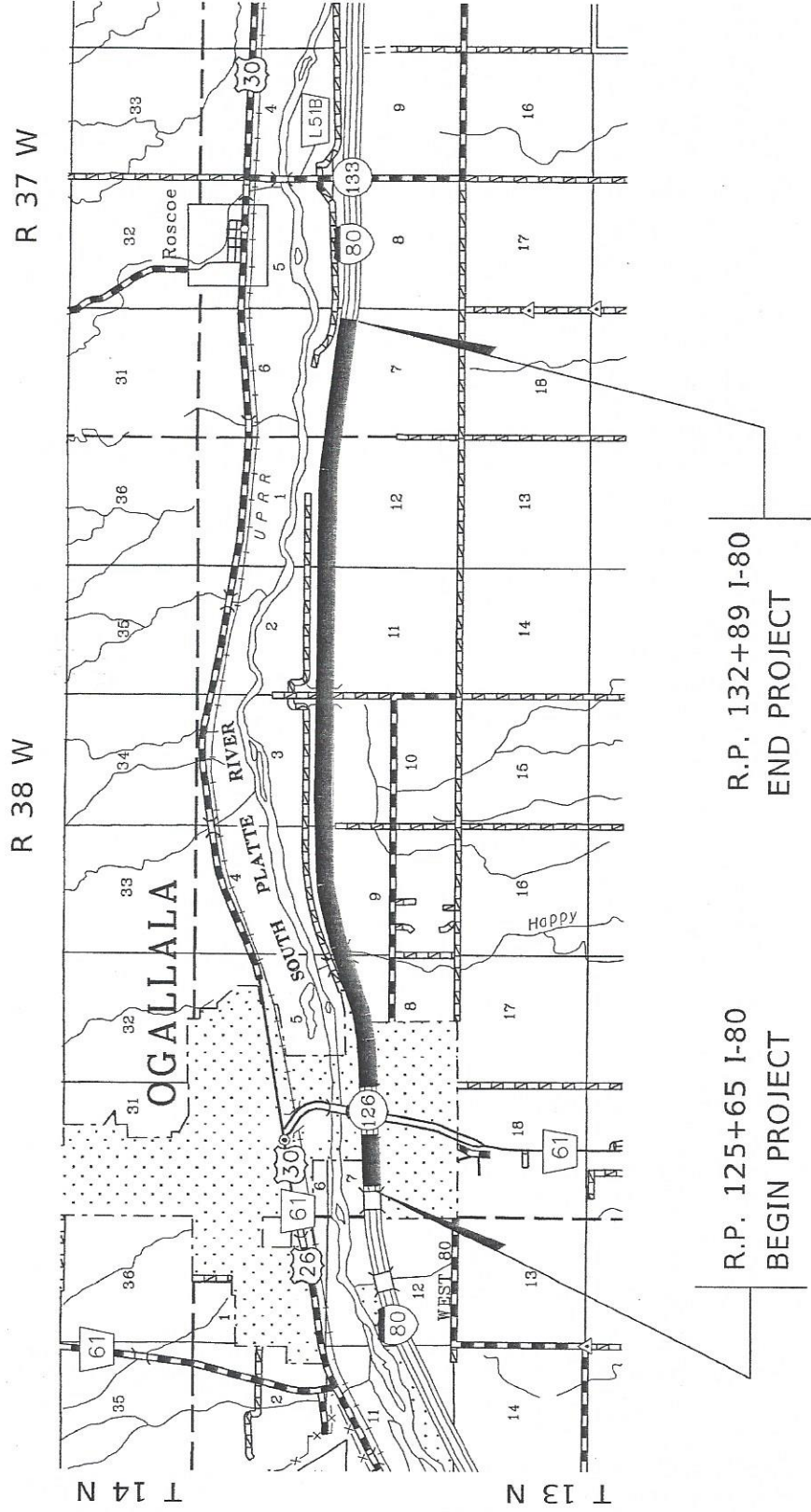

EXHIBIT A

OGALLALA - ROSCOE CROSSEOVERS 80-3(157)

C.N. 61586A BOOK X310
KEITH COUNTY

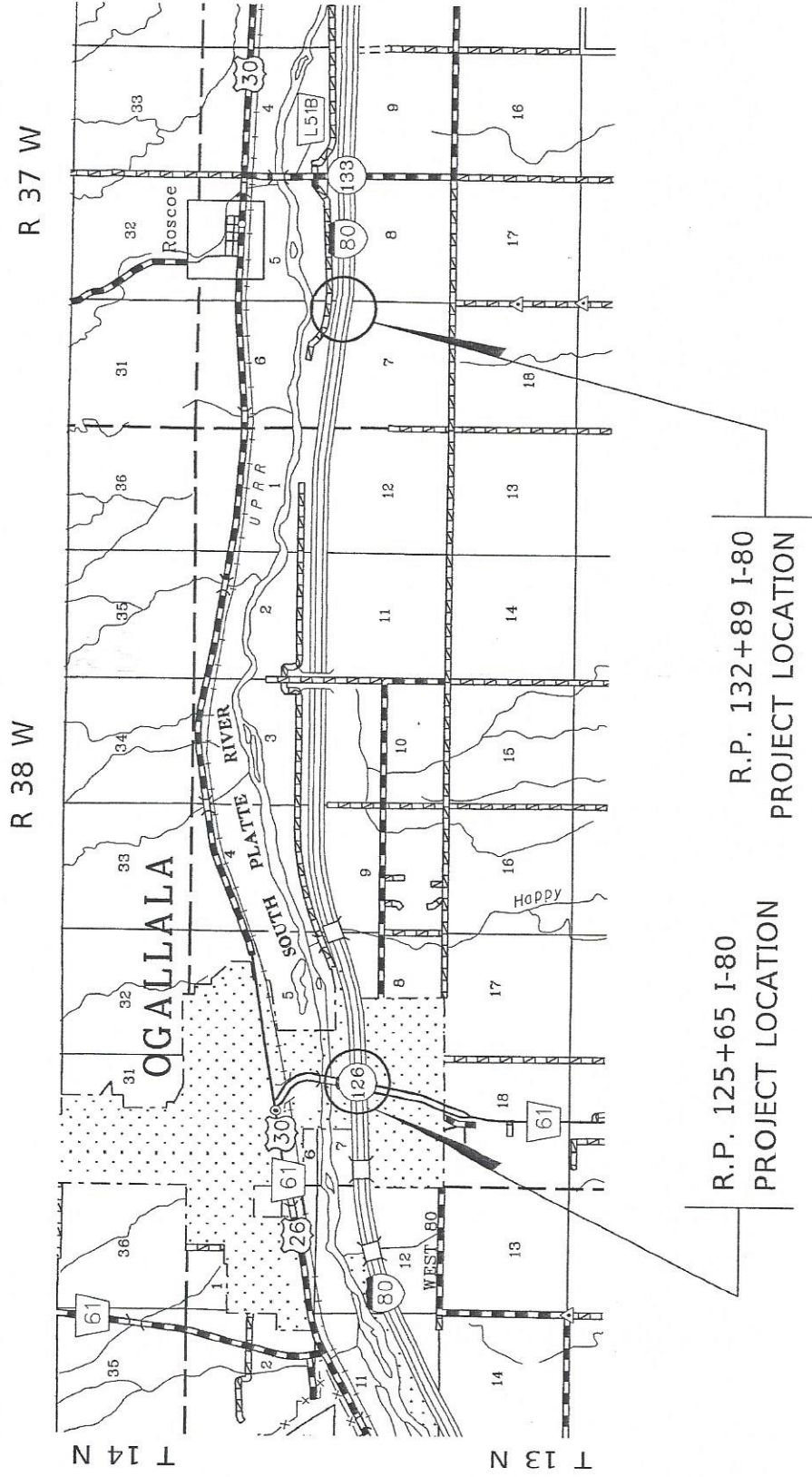
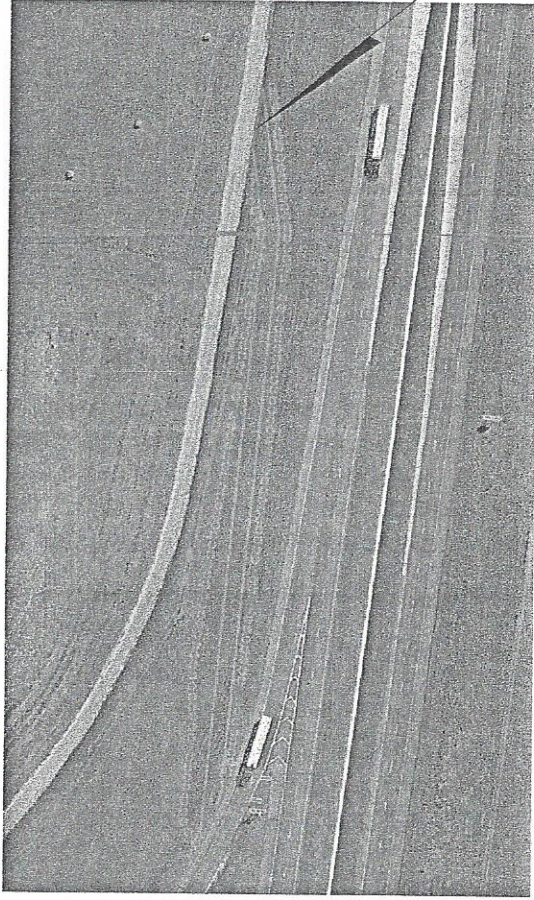
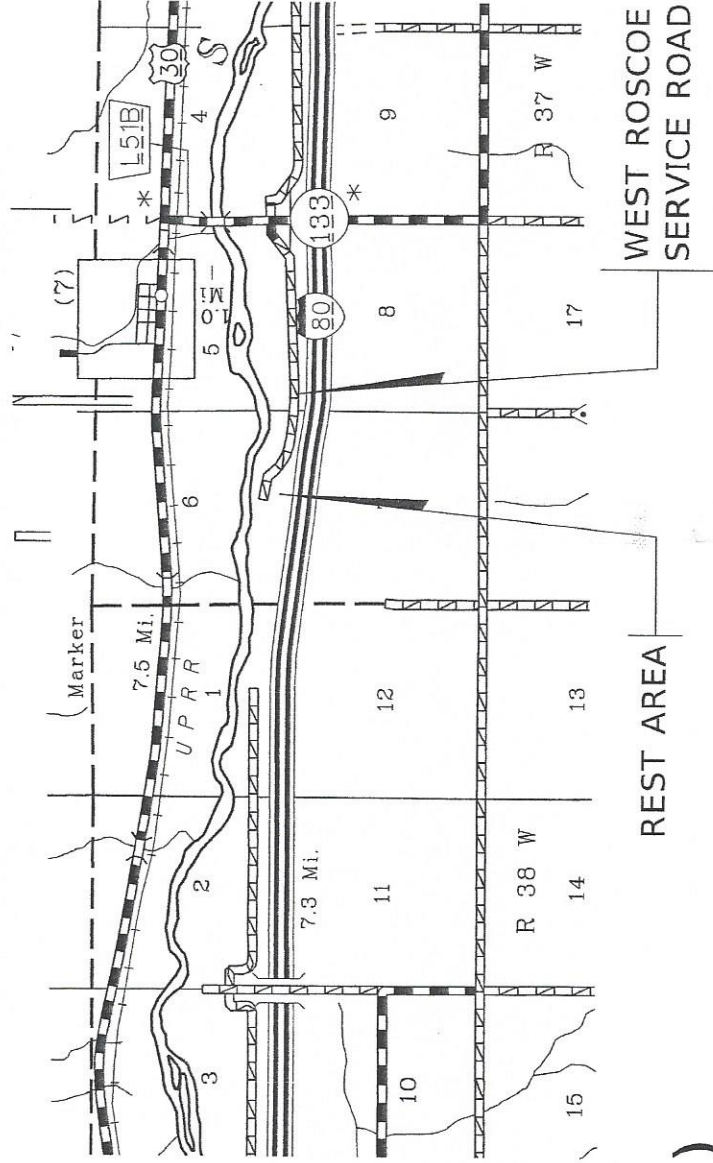

EXHIBIT B

KEITH COUNTY NEBRASKA



TEMPORARY
CONNECTOR
WEST ROSCOE RD.
TO CONSTRUCTION SITE



80-3(156)

C.N. 61586

EXHIBIT C