

2024 ROAD RESTRICTIONS (TONS/AXLE)

- 10 TON ROADS
- 9 TON ROADS
- 7 TON ROADS
- ALL OTHERS 5 TON ROADS

HIGHWAY MAP OF MARSHALL COUNTY

HIGHWAY DEPARTMENT WARREN, MINNESOTA

REVISED 2023

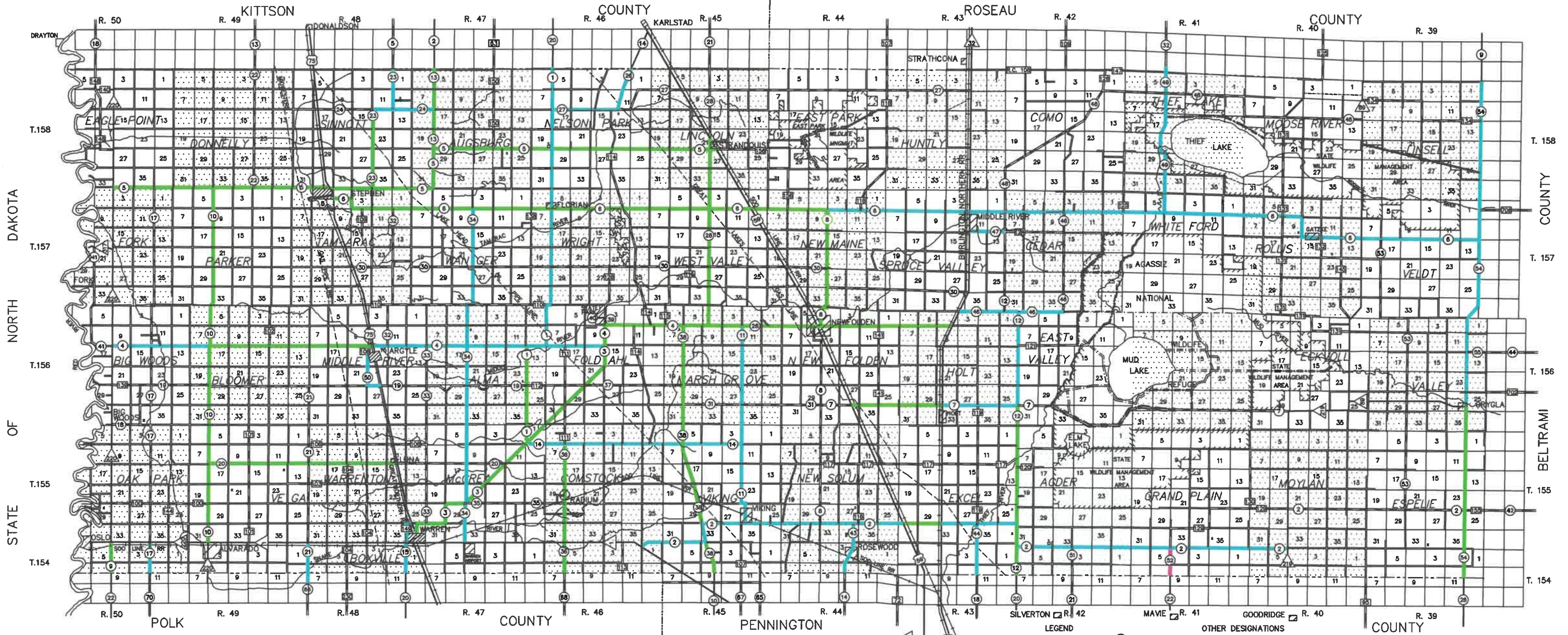

MUNICIPAL COUNTY STATE AID HIGHWAYS
 WARREN - C.S.A.H. NO. 64 GRYDLA - C.S.A.H. NO. 58
 ARGYLE - C.S.A.H. NO. 57 HOLT - C.S.A.H. NO. 59
 ALVARADO - C.S.A.H. NO. 56 STEPHEN - C.S.A.H. NO. 62
 STRANDUST - C.S.A.H. NO. 63 OSLO - C.S.A.H. NO. 61
 MIDDLE RIVER - C.S.A.H. NO. 60



- LEGEND
- COUNTY STATE AID HIGHWAY -
 - COUNTY HIGHWAY -
 - STATE HIGHWAY -
 - U. S. HIGHWAY -
 - LON AUNE, COUNTY ENGINEER
- OTHER DESIGNATIONS
- TOWNSHIP ROADS -
 - HARD SURFACE ROADS -
 - GRAVEL SURFACE ROADS -
 - SCHOOL HOUSES -
 - CHURCHES -
 - WILDLIFE AREA -
 - PUBLIC DITCHES -

