



Prince George Fire and EMS
P. O. Box 68, 6602 COURTS DRIVE
PRINCE GEORGE, VIRGINIA 23875
(804) 722-8614 FAX (804) 733-2769

HOME FIRE SAFETY SURVEY

General

- r **Yes** r **No** Home has smoke alarms on every level.
- r **Yes** r **No** Home has a smoke alarm in every bedroom.
- r **Yes** r **No** Smoke alarms are located outside each separate sleeping area.
- r **Yes** r **No** Smoke alarms are located at least 10 feet from a stationary or fixed cooking appliance.
- r **Yes** r **No** For larger homes (where the interior floor area on a given level is greater than 1,000 square feet), there is an average of at least 1 smoke alarm for every 500 square feet.
[See NFPA 72-2007 11.5.1.3, 29.5.1.3 (2010)]
- r **Yes** r **No** Smoke alarms are interconnected so when one sounds, they all sound. (Best protection)
- r **Yes** r **No** Home has address visible and identifiable from street or road
- r **Yes** r **No** Home has photoelectric smoke alarms.
- r **Yes** r **No** All smoke alarms are working.
- r **Yes** r **No** Family has a home fire escape plan.
- r **Yes** r **No** Family practices the home fire escape plan at least twice a year.
- r **Yes** r **No** The home has occupant(s) that require assistance to escape. Occupants discuss escape planning and occupant requirements in case of a fire or emergency escape.
- r **Yes** r **No** House number is visible from the street.
- r **Yes** r **No** Windows used for escape open easily — not blocked by furniture, security bars or nailed/painted shut.
- r **Yes** r **No** Security bars, if present, have a quick release-device.
- r **Yes** r **No** Home has a home fire sprinkler system. (Best protection)
- r **Yes** r **No** Home has a carbon monoxide alarm outside each separate sleeping area.
- r **Yes** r **No** Home has a carbon monoxide alarm on every level.
- r **Yes** r **No** Carbon monoxide alarms are working.

Throughout the Home

- r **Yes** r **No** Smokers smoke outside the home.
- r **Yes** r **No** Large ashtrays are provided outside for smokers.
- r **Yes** r **No** Matches and lighters are stored in a secure cabinet.
- r **Yes** r **No** Lit candles are not left unattended.
- r **Yes** r **No** Flammable liquids, if stored in the home, are limited in quantity.
- r **Yes** r **No** The home is not cluttered with clothes, magazines, newspapers or other items that can burn

Kitchen

- r **Yes** r **No** Things that can burn are removed from the stovetop.
- r **Yes** r **No** Small appliances are unplugged when not in use.
- r **Yes** r **No** Adult stays in the kitchen when stovetop is in use.

Living/Family Room

- r **Yes** r **No** Fireplace has proper screen and hearth.
- r **Yes** r **No** Things that can burn are at least 3 feet from space heaters and fireplaces.

Bedrooms

r **Yes** r **No** All bedrooms have two ways out — window and a door.

Basement

r **Yes** r **No** Workshop area is clean of things that can burn.

r **Yes** r **No** Hot water heater is set at no higher than 120° Fahrenheit.

r **Yes** r **No** Things that can burn are at least 3 feet from the furnace.

r **Yes** r **No** Furnace is inspected and cleaned annually.

r **Yes** r **No** Chimney is inspected annually and cleaned as needed.

r **Yes** r **No** Clothes dryer lint filter and vent pipe are clean.

Garage

r **Yes** r **No** There is a solid door between garage and residence.

r **Yes** r **No** Gas powered equipment is stored in an outside shed or garage, separate from the home.

r **Yes** r **No** Gasoline is stored in an approved safety container in an outside shed or garage, separate from the home.

Outside the Home

r **Yes** r **No** Outside electrical receptacles are GFCI and they are in good working condition.

r **Yes** r **No** There is no rubbish, trash, brush or tree trimmings accumulation on the property.

r **Yes** r **No** Barbecue grill is only used outdoors.

r **Yes** r **No** Swimming pool or hot tub is enclosed by a four-sided fence and locked gate. Filter, heater or hot tub is properly grounded

Electrical

r **Yes** r **No** AFCIs (arc-fault circuit interrupters) are installed throughout the home and they are working properly (new home construction only).

r **Yes** r **No** Kitchen and bathrooms have GFCI outlets on countertop surfaces within 6 feet of running water outlets and they are working properly.

r **Yes** r **No** All receptacle and switch faceplates are installed and in good condition.

r **Yes** r **No** Receptacles have been tested and are in good working condition — no evidence of arcing or overheating.

r **Yes** r **No** Switches are in good condition — no evidence of arcing or overheating.

r **Yes** r **No** Lighting fixture canopies are fastened in place and fixture is in good condition.

r **Yes** r **No** Bulbs in light fixtures are the correct wattage for the lighting fixture.

r **Yes** r **No** Flexible cords and cables are not used as fixed wiring, run through holes in walls, ceiling or floor, run through doorways or windows or under carpets or attached to building surfaces.

r **Yes** r **No** If there are young children in the home, the home has tamper-resistant outlets.

r **Yes** r **No** Panel board and distribution equipment is accessible for inspection and in good condition — no evidence of overheating, corrosion or other damage.

r **Yes** r **No** Service entrance raceways or cables are fastened in place, grounded, readily accessible and in good condition.

Stair Safety

Trips and falls on stairs are a leading cause of home injuries.

r **Yes** r **No** Stair is provided with a handrail(s).

r **Yes** r **No** Stair can be illuminated for night time use.

r **Yes** r **No** Stair tread depth and riser height are uniform.

r **Yes** r **No** Stair landing nosing projections are consistent with other nosings on the stair flight.

(You can determine this by doing a "crouch and sight" test. Crouch down at the top landing of the stair. All the nosings from the landing to the bottom step should line up.)

With your consent, the Home Fire Safety Survey Team has done a fire survey of your home. The items checked "**No**" may put you and your family at risk. You are urged to correct these at once for your own safety. This survey does not identify future conditions such as failure of components, wiring or human behavior which could result in a fire.

HOME ADDRESS:

WAIVER, RELEASE AND HOLD HARMLESS AGREEMENT

In consideration of the voluntary performance of a home fire safety survey of my home located at _____, I, on behalf of myself, and all members of family, as well as my heirs, executors, administrators or successors, hereby waive any claim or cause of action of any nature that I have, or in the future may have, against any and all individual or organizational participants in the Home Fire Safety Survey Program, including but not limited to Prince George Fire & EMS and the municipality of Prince George and its officers, agents or employees, which claim or cause of action grows out of or results from a fire or other damage, following the said home fire safety survey; and I further hereby agree to release and hold harmless any and all organizational and individual participants including the aforesaid fire department and municipality in the Home Fire Safety Survey Program from and against all damages of any kind, to persons or property, growing out of or resulting from a fire in my referenced home.

I acknowledge having read, understood, and agreed to the above waiver, and release.

Print name

Signature

Date

Witness (print name)

Signature

Date

*This form generally indicates that the occupant or owner of the property agrees to waive his or her rights to sue any individual, any municipality and any other organizations or individuals involved in the fire safety survey of this home, if a fire occurs after the survey. The purpose of the waiver is to protect the individual or any of the organizations involved against liability arising from the home fire survey. This statement is intended for information only, the terms of the waiver themselves shall prevail if there are any questions. You should seek advice if you do not understand this waiver.



How to Make a Home Fire Escape Plan

- Draw a map of your home. Show all doors and windows.
- Visit each room. Find two ways out.
- All windows and doors should open easily. You should be able to use them to get outside.
- Make sure your home has smoke alarms. Push the test button to make sure each alarm is working.
- Pick a meeting place outside. It should be in front of your home. Everyone will meet at the meeting place.
- Make sure your house or building number can be seen from the street.
- Talk about your plan with everyone in your home.
- Learn the emergency phone number for your fire department.
- Practice your home fire escape drill!

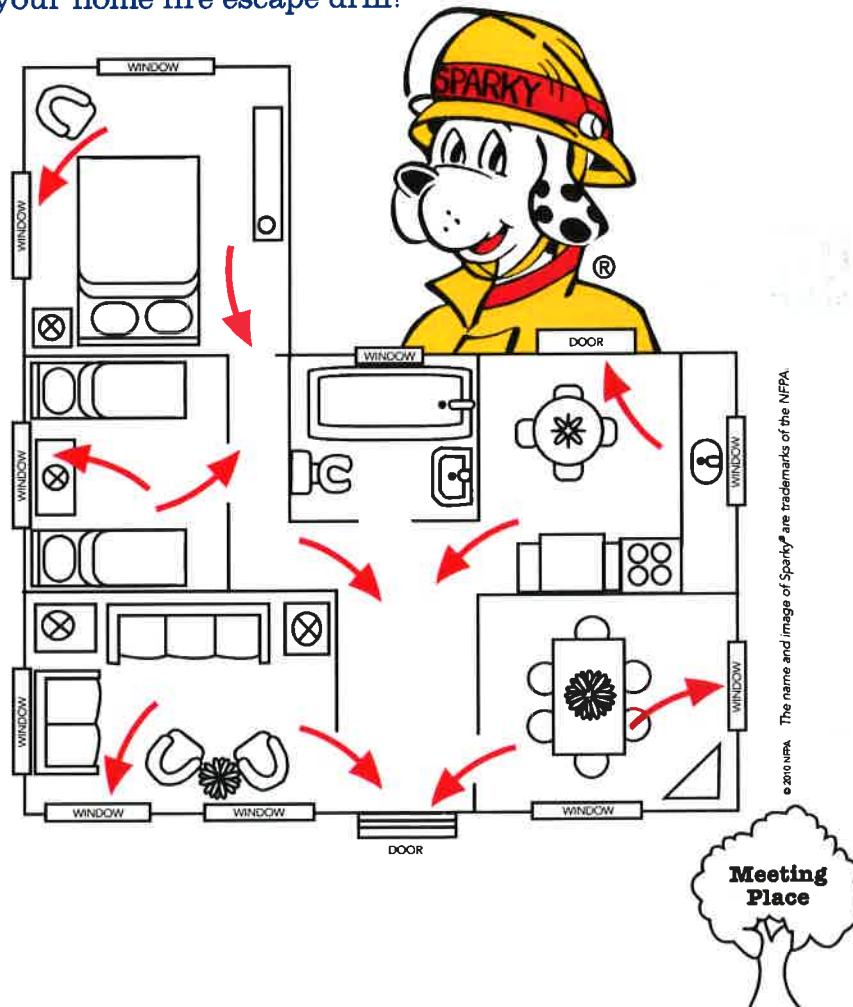

- Make your own home fire escape plan on the back of this paper.

— Keeping Your Community Safe with Home Fire Escape Drills —

