

SECTION 'A'

SECTION 'C'

SECTION 'B'

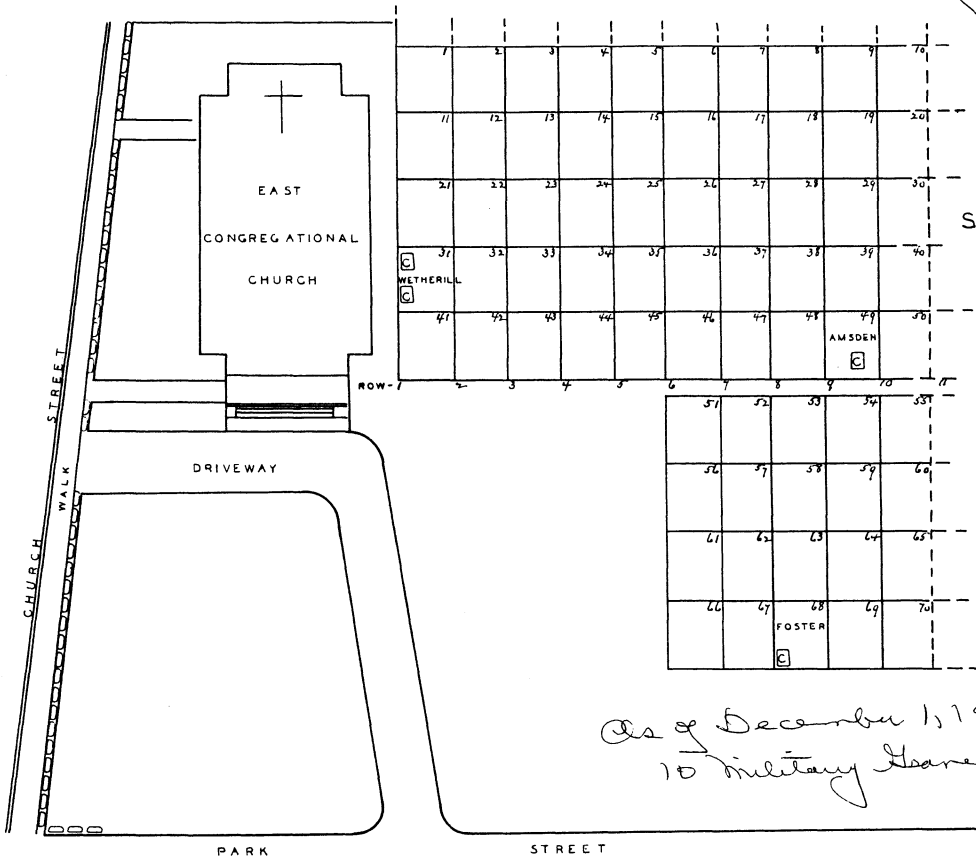

*As of December 1, 1970
10 Military Graves*

EAST CHURCH

CEMETERY

WARE - MASS.

LEGEND

NAME		SEC. GRAVE KEY WAR		
AMSDEN	JULIUS A.	A	40	F-3 CIVIL
FOSTER	EDWARD L.	A	68	E-5 CIVIL
WETHERILL	ELIZABETH	A	31	C-2 CIVIL
WETHERILL	THOMAS CAPT	A	51	C-2 CIVIL

W.P. NO. 22704

O.P. NO. 165-1-14-284

SCALE 1 X 20'
DRAWN BY C.H. LAFRANCE

SHEET
1 OF 4